

D-SUB crimp contact - CUC-DSC-J1BAU-S/DSC22 - 1418790

Please be informed that the data shown in this PDF Document is generated from our Online Catalog. Please find the complete data in the user's documentation. Our General Terms of Use for Downloads are valid (<http://phoenixcontact.com/download>)



D-SUB crimp contact, Connection method: Crimp connection, Connection cross section: AWG 28-22, High Density

Product Description

High-density contact for D-SUB contact inserts

Why buy this product

- ☒ Various connection methods for every application
- ☒ High grade
- ☒ Turned contact

RoHS

Key Commercial Data

| | |
|------------------------|---|
| Packing unit | 1 STK |
| Minimum order quantity | 100 STK |
| GTIN |  4 055626 150772 |
| GTIN | 4055626150772 |
| Custom tariff number | 85366990 |
| Country of origin | Switzerland |

Technical data

Mechanical characteristics

| | |
|------------------------------|-----------------------|
| Insertion/withdrawal cycles | ≥ 200 |
| Connection method | Crimp connection |
| Type of contact | Socket |
| Conductor cross section | 0.08 mm² ... 0.34 mm² |
| Connection cross section AWG | 28 ... 22 |

D-SUB crimp contact - CUC-DSC-J1BAU-S/DSC22 - 1418790

Technical data

Mechanical characteristics

| | |
|---------------|------------------|
| Mounting type | Crimp connection |
| Contact type | turned |

Ambient conditions

| | |
|---------------------------------|-------------------|
| Ambient temperature (operation) | -55 °C ... 115 °C |
|---------------------------------|-------------------|

Material data

| | |
|--------------------------|--------------------------|
| Contact material | Copper alloy |
| Contact surface material | 0.2 µm, gold over nickel |

Electrical characteristics

| | |
|---------------|-----|
| Rated current | 3 A |
|---------------|-----|

Environmental Product Compliance

| | |
|------------|---|
| China RoHS | Environmentally friendly use period: unlimited = EFUP-e |
| | No hazardous substances above threshold values |

Drawings

Dimensional drawing

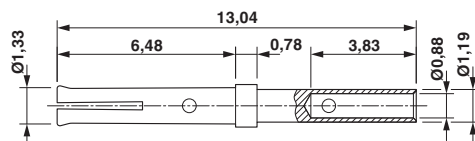

D-SUB crimp contact socket

Classifications

eCl@ss

| | |
|------------|----------|
| eCl@ss 4.0 | 27140816 |
| eCl@ss 4.1 | 27260701 |
| eCl@ss 5.0 | 27260701 |
| eCl@ss 5.1 | 27260701 |
| eCl@ss 6.0 | 27261202 |
| eCl@ss 7.0 | 27440204 |
| eCl@ss 8.0 | 27440204 |
| eCl@ss 9.0 | 27440204 |

D-SUB crimp contact - CUC-DSC-J1BAU-S/DSC22 - 1418790

Classifications

ETIM

| | |
|----------|----------|
| ETIM 2.0 | EC000796 |
| ETIM 3.0 | EC000796 |
| ETIM 4.0 | EC000796 |
| ETIM 5.0 | EC000796 |
| ETIM 6.0 | EC000796 |

UNSPSC

| | |
|---------------|----------|
| UNSPSC 6.01 | 30211923 |
| UNSPSC 7.0901 | 39121522 |
| UNSPSC 11 | 39121522 |
| UNSPSC 12.01 | 39121522 |
| UNSPSC 13.2 | 39121522 |

Accessories

Accessories

Crimping tool

Crimping pliers - CRIMPFOX-TC MP - 1212510



Crimping pliers, for turned contacts, universal cross section setting, up to a maximum of 2.5 mm², digital display with 0.01 mm increments, pressure lock can be unlocked, including positioning tool

Female insert

D-SUB contact support - VS-09-BU-DSUB-HD-CD-B - 1655124



D-SUB contact carrier, shell size 1, for 15 signal contacts, type of contact socket, for crimp contacts, straight, fixing with a 3 mm hole, for panel mounting frame and sleeve housing VS-09-...

D-SUB crimp contact - CUC-DSC-J1BAU-S/DSC22 - 1418790

Accessories

D-SUB contact support - VS-15-BU-DSUB-HD-CD-B - 1655182



D-SUB contact carrier, shell size 2, for 26 signal contacts, type of contact socket, for crimp contacts, straight, fixing with a 3 mm hole, for panel mounting frame and sleeve housing VS-15-...

D-SUB contact support - VS-25-BU-DSUB-HD-CD-B - 1655247



D-SUB contact carrier, shell size 3, for 44 signal contacts, type of contact socket, for crimp contacts, straight, fixing with a 3 mm hole, for panel mounting frame and sleeve housing VS-25-...

Tool - VS-IET-DSUB-SIGNAL-HD - 1658503



Insertion/extraction tool, to insert and extract the D-SUB high density signal contacts