

D-SUB crimp contact - CUC-DSC-C1BAU-S/DSC28 - 1418784

Please be informed that the data shown in this PDF Document is generated from our Online Catalog. Please find the complete data in the user's documentation. Our General Terms of Use for Downloads are valid (<http://phoenixcontact.com/download>)



D-SUB crimp contact, Connection method: Crimp connection, Connection cross section: AWG 28-26

Product Description

Standard contact for D-SUB contact inserts

Why buy this product

- Various connection methods for every application
- High grade
- Turned contact

Key Commercial Data

Packing unit	100 STK
GTIN	 4 055626 150727
GTIN	4055626150727

Technical data

Mechanical characteristics

Standards/specifications	DIN 41652
Insertion/withdrawal cycles	≥ 200
Connection method	Crimp connection
Type of contact	Pin
Conductor cross section	0.08 mm ² ... 0.12 mm ²
Connection cross section AWG	28 ... 26
Insertion force per signal contact	≤ 3.40 N
Mounting type	Crimp connection
Contact type	turned

Ambient conditions

Ambient temperature (operation)	-55 °C ... 130 °C
---------------------------------	-------------------

D-SUB crimp contact - CUC-DSC-C1BAU-S/DSC28 - 1418784

Technical data

Material data

Contact material	Copper alloy
Contact surface material	0.2 µm, gold over nickel

Electrical characteristics

Rated current	5 A (at 20 °C)
---------------	----------------

Standards and Regulations

Standards/regulations	DIN 41652
-----------------------	-----------

Environmental Product Compliance

China RoHS	Environmentally friendly use period: unlimited = EFUP-e
	No hazardous substances above threshold values

Drawings

Dimensional drawing

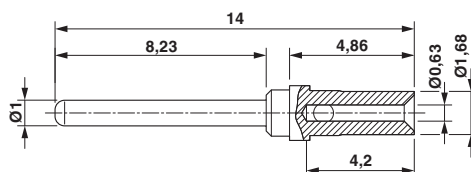

D-SUB crimp contact pin

Phoenix Contact 2017 © - all rights reserved
<http://www.phoenixcontact.com>

PHOENIX CONTACT GmbH & Co. KG
Flachsmarktstr. 8
32825 Blomberg
Germany
Tel. +49 5235 300
Fax +49 5235 3 41200
<http://www.phoenixcontact.com>