

D-SUB crimp contact - CUC-DSC-J1BAU-S/DSC28 - 1418787

Please be informed that the data shown in this PDF Document is generated from our Online Catalog. Please find the complete data in the user's documentation. Our General Terms of Use for Downloads are valid (<http://phoenixcontact.com/download>)



D-SUB crimp contact, Connection method: Crimp connection, Connection cross section: AWG 28-26

Product Description

Standard contact for D-SUB contact inserts

Why buy this product

- Various connection methods for every application
- High grade
- Turned contact

Key Commercial Data

Packing unit	1 STK
Minimum order quantity	100 STK
GTIN	 4 055626 150741
GTIN	4055626150741
Weight per Piece (excluding packing)	0.200 g
Custom tariff number	85366990
Country of origin	Germany

Technical data

Mechanical characteristics

Standards/specifications	DIN 41652
Insertion/withdrawal cycles	≥ 200
Connection method	Crimp connection
Type of contact	Socket

D-SUB crimp contact - CUC-DSC-J1BAU-S/DSC28 - 1418787

Technical data

Mechanical characteristics

Conductor cross section	0.08 mm ² ... 0.12 mm ²
Connection cross section AWG	28 ... 26
Insertion force per signal contact	≤ 3.40 N
Mounting type	Crimp connection
Contact type	turned

Ambient conditions

Ambient temperature (operation)	-55 °C ... 130 °C
---------------------------------	-------------------

Material data

Contact material	Copper alloy
Contact surface material	0.2 µm, gold over nickel

Electrical characteristics

Rated current	5 A (at 20 °C)
---------------	----------------

Standards and Regulations

Standards/regulations	DIN 41652
-----------------------	-----------

Environmental Product Compliance

China RoHS	Environmentally friendly use period: unlimited = EFUP-e
	No hazardous substances above threshold values

Drawings

Dimensional drawing

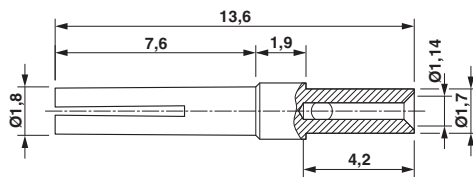

D-SUB crimp contact pin