

Flush-type socket - SACC-DSI-FSY-8CON-M16/0,5 SCO - 1407618

Please be informed that the data shown in this PDF Document is generated from our Online Catalog. Please find the complete data in the user's documentation. Our General Terms of Use for Downloads are valid (<http://phoenixcontact.com/download>)



Flush-type socket, Universal, 8-position, Socket, Link: M12-SPEEDCON, Y - hybrid, Rear mounting, M16 x 1.5, Contacts with connected litz wires, Cable length: 0.5 m

M12 panel feed-through, rear mounting

Why buy this product

- ✓ Pre-assembled with litz wires for immediate use
- ✓ Customer-specific assemblies and litz wire lengths available
- ✓ All standard pin assignments and codings for signal, data, and power transmission with a uniform design-in design
- ✓ For high transmission safety: shield connection to the housing with optional EMC nut



Key Commercial Data

Packing unit	1 STK
Minimum order quantity	50 STK
GTIN	 4 046356 807913
GTIN	4046356807913
Weight per Piece (excluding packing)	40.000 g
Custom tariff number	85444290
Country of origin	Germany

Technical data

Dimensions

Length of cable	0.5 m
-----------------	-------

Ambient conditions

Ambient temperature (operation)	-25 °C ... 85 °C
---------------------------------	------------------

Flush-type socket - SACC-DSI-FSY-8CON-M16/0,5 SCO - 1407618

Technical data

Ambient conditions

	-40 °C ... 85 °C (without mechanical actuation)
Degree of protection	IP67

General

Note	The electrical and mechanical data specified assume that the connector pair is correctly locked and mounted. If the connector is unlocked and if there is a danger of contamination, the connector must be sealed using a protective cap > IP54. Influences arising from litz wires, cables or PCB assembly must also be taken into consideration.
Rated current at 40°C	6 A (Power) 0.5 A (Data)
Rated voltage	30 V (Power and data) 30 V (Power)
Rated surge voltage	0.8 kV
Number of positions	8
Insulation resistance	> 100 MΩ
Coding	Y - hybrid
Standards/regulations	M12 connector
Signal type/category	Universal
Overvoltage category	III
Degree of pollution	3
Connection method	Contacts with connected litz wires
Insertion/withdrawal cycles	> 100
Torque	3 Nm ... 4 Nm (Installation-side)
Mounting type	Rear mounting M16 x 1.5

Material

Flammability rating according to UL 94	V0
Contact material	CuZn
Contact surface material	Ni/Au
Contact carrier material	PPA
Material, knurls	Zinc die-cast, nickel-plated
Sealing material	FKM

Cable

Cable type	TPE litz wire
Conductor cross section	0.14 mm ² 0.5 mm ²
AWG signal line	26
AWG power supply	20

Flush-type socket - SACC-DSI-FSY-8CON-M16/0,5 SCO - 1407618

Technical data

Cable

Conductor structure signal line	1.10 mm
Conductor structure, voltage supply	1.50 mm
Thickness, insulation	0.25 mm
Wire colors	Signal: orange/white, orange, green/white, green Power: blue, white, brown, black
Material conductor insulation	TPE
Conductor material	Tin-plated Cu litz wires
Standards/specifications	M12 connector
Insulation resistance	$\geq 20 \text{ M}\Omega \cdot \text{km}$
Conductor resistance	$\leq 142 \text{ m}\Omega/\text{m}$ $\leq 40.1 \text{ m}\Omega/\text{m}$
Transmission characteristics (category)	CAT5 (IEC 11801:2002)
Nominal voltage, cable	300 V
Test voltage, cable	3000 V AC
Ambient temperature (operation)	-40 °C ... 105 °C (cable, fixed installation) -30 °C ... 90 °C (cable, flexible installation)

Standards and Regulations

Standard designation	M12 connector
Flammability rating according to UL 94	V0

Environmental Product Compliance

China RoHS	Environmentally Friendly Use Period = 50
	For details about hazardous substances go to tab "Downloads", Category "Manufacturer's declaration"

Drawings

Schematic diagram

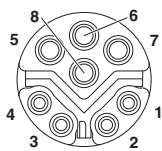

Pin assignment of socket, 8-pos., Y-coded, socket side view

Dimensional drawing

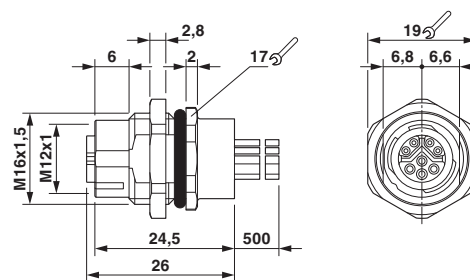

M12 flush-type socket, rear mounting, M16 fastening thread

Flush-type socket - SACC-DSI-FSY-8CON-M16/0,5 SCO - 1407618

Circuit diagram

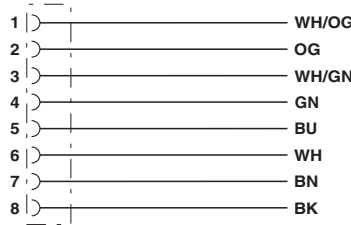

Contact assignment of the M12 connector

Approvals

Approvals

Approvals

UL Recognized / cUL Recognized / EAC / cULus Recognized

Ex Approvals

Approval details

UL Recognized		http://database.ul.com/cgi-bin/XYV/template/LISEXT/1FRAME/index.htm	FILE E 335024
Nominal current I _N		4.5 A	
Nominal voltage U _N		30 V	

cUL Recognized		http://database.ul.com/cgi-bin/XYV/template/LISEXT/1FRAME/index.htm	FILE E 335024
Nominal current I _N		4.5 A	
Nominal voltage U _N		30 V	

EAC		B.00767
-----	--	---------

Flush-type socket - SACC-DSI-FSY-8CON-M16/0,5 SCO - 1407618

Approvals

cULus Recognized



<http://database.ul.com/cgi-bin/XYV/template/LISEXT/1FRAME/index.htm>