

Housing - HC-STA-B10-BWD-ELC-AL - 1411322

Please be informed that the data shown in this PDF Document is generated from our Online Catalog. Please find the complete data in the user's documentation. Our General Terms of Use for Downloads are valid (<http://phoenixcontact.com/download>)



HEAVYCON B10 panel mounting base, with double locking latch, with flat gasket, salt-water-resistant aluminum, conductive profile gasket

Why buy this product

- good shielding in the event of electromagnetic interference



Key Commercial Data

Packing unit	1 STK
GTIN	 4 046356 927239
GTIN	4046356927239
Weight per Piece (excluding packing)	103.200 g
Custom tariff number	85389099
Country of origin	China

Technical data

Dimensions

Height	30.5 mm
Width	53 mm
Length	93.5 mm
Length of the assembly cutout	65 mm
Width of the assembly cutout	35 mm

Ambient conditions

Degree of protection of housing (IP)	IP66 (with HC-EVO... metal sleeve housing)
	IP69K (ISO 20653:2013-02, with HC-EVO... / HC-STA... metal sleeve housing)
	IP67 (with HC-STA... sleeve housing)
Degree of protection of housing (NEMA)	4

Housing - HC-STA-B10-BWD-ELC-AL - 1411322

Technical data

Ambient conditions

	4X
	12
Ambient temperature (operation)	-40 °C ... 125 °C

General

Note	For contact inserts HC-B10, BB18, DD42, M, K8/24
Size	B10
Housing type	Panel mounting base
Locking type	With double locking latch
Torque	1.5 Nm ... 2 Nm (Mounting screw)
Screw connection	none
Housing material	Die-cast aluminum, salt water resistant
Housing surface material	Uncoated
Material lock	Polyamide

Environmental Product Compliance

China RoHS	Environmentally friendly use period: unlimited = EFUP-e
	No hazardous substances above threshold values

Drawings

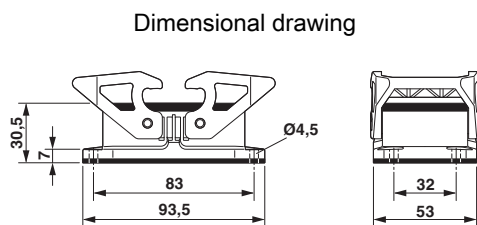

Dimensional drawing

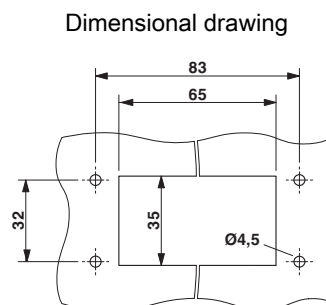

Panel cutout

Classifications

eCl@ss

eCl@ss 5.1	27143424
eCl@ss 6.0	27143424
eCl@ss 8.0	27440202
eCl@ss 9.0	27440202

ETIM

ETIM 4.0	EC000437
ETIM 5.0	EC000437

Housing - HC-STA-B10-BWD-ELC-AL - 1411322

Approvals

Approvals

Approvals

EAC / GL

Ex Approvals

Approval details

EAC 7500651.22.01.00246

GL <http://www.gl-group.com/newbuilding/approvals/index.html> 6196614

Accessories

Accessories

Housing latches

Housing brackets - HC-STA-B10-24-DL-PLBK - 1412886



Double locking latch for B10 / B16 / B24 housing, HC-EVO....AL and HC-STA....AL

Seal

Flat gasket - HC-B10-SG-CBK - 1411484



Replacement flat gasket, for HEAVYCON panel mounting base, HC-STA....AL, type B10, conductive

Profile gasket - HC-B10-SP-CBK - 1411479



Profile gasket for HEAVYCON EVO supporting base element type B10, conductive
