

Cable gland - G-INS-M20-S68N-PNES-GY - 1411125

Please be informed that the data shown in this PDF Document is generated from our Online Catalog. Please find the complete data in the user's documentation. Our General Terms of Use for Downloads are valid (<http://phoenixcontact.com/download>)



Cable gland, Cable gland material: Polyamide 6, External cable diameter 6 mm ... 12 mm, Shielding: No, Connecting thread: M20, Color: silver-gray RAL 7001

Why buy this product



Key Commercial Data

Packing unit	1 STK
Minimum order quantity	5 STK
Weight per Piece (excluding packing)	12.000 g
Custom tariff number	39269097
Country of origin	Turkey

Technical data

Dimensions

Length	42 mm
Wrench size, union nut	24 mm
Wrench size, support	24 mm
Hexagon angular dimension	27.8 mm
Length of the connecting thread	10 mm
Feed-through hole diameter	20.1 mm ... 20.2 mm
External cable diameter	6 mm ... 12 mm
	9 mm ... 12 mm (for UL 514 B)

Ambient conditions

Degree of protection	IP68 (5 bar / 0.5 h)
	IP66

Cable gland - G-INS-M20-S68N-PNES-GY - 1411125

Technical data

Ambient conditions

Ambient temperature (operation)	-20 °C ... 100 °C (static)
---------------------------------	----------------------------

General

No. of conductors	1
Cable gland material	Polyamide 6
Cable seal material	Neoprene
Shielded	No
Thread type on connection side	M20
Torque	3.5 Nm (Union nut)
	3.5 Nm (Support or counter nut)
	6 Nm (for UL514 B: union nut / support)
Flammability rating according to UL 94	V2
	V2 (Housing)
Color	silver-gray RAL 7001
Impact category	2
Execution of the strain relief	A
Assembly instructions	1) Mount screw connection support in the housing using the correct torque 2) Insert cable 3) Tighten union nut using the correct torque

Standards and Regulations

Connection in acc. with standard	CSA
Flammability rating according to UL 94	V2

Environmental Product Compliance

China RoHS	Environmentally friendly use period: unlimited = EFUP-e
	No hazardous substances above threshold values

Drawings

Dimensional drawing

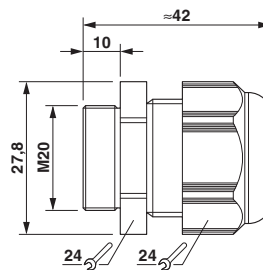

Cable gland - G-INS-M20-S68N-PNES-GY - 1411125

Classifications

eCl@ss

eCl@ss 5.1	27149109
eCl@ss 6.0	27149109
eCl@ss 8.0	27149109
eCl@ss 9.0	27144432

ETIM

ETIM 4.0	EC000441
ETIM 5.0	EC000441

Approvals

Approvals

Approvals

CSA / VDE Zeichengenehmigung / UL Listed / cUL Listed / cULus Listed

Ex Approvals

Approval details

CSA  <http://www.csagroup.org/services/testing-and-certification/certified-product-listing/> 243143

VDE Zeichengenehmigung  <http://www.vde.com/en/Institute/OnlineService/VDE-approved-products/Pages/Online-Search.aspx> 40024418

UL Listed  <http://database.ul.com/cgi-bin/XYV/template/LISEXT/1FRAME/index.htm> E199260

cUL Listed  <http://database.ul.com/cgi-bin/XYV/template/LISEXT/1FRAME/index.htm> E199260

Cable gland - G-INS-M20-S68N-PNES-GY - 1411125

Approvals



Accessories

Accessories

Flat nut

Nut - A-INL-M20-P-GY - 1411207



Nut, Cable gland material: Polyamide, PA 6 GF 30, for threads M20, Color: silver grey

Sealing plugs

Closing cap - SEALING PLUG 9X16 RD - 1400259



Closing cap, for closing unused bore holes in multiple seals and cable glands, diameter 9 mm