

# Printed-circuit board connector - DMC 1,5/ 6-G1F-3,5-LR P26THR - 1711100

Please be informed that the data shown in this PDF Document is generated from our Online Catalog. Please find the complete data in the user's documentation. Our General Terms of Use for Downloads are valid (<http://phoenixcontact.com/download>)

Header, Nominal current: 8 A, Rated voltage (III/2): 160 V, Number of positions: 6, Pitch: 3.5 mm, Color: black, Contact surface: Tin, Mounting: THR soldering



The figure shows a 10-pos. version with 20 contacts

## Why buy this product

- Designed for integration into the SMT soldering process
- Screwable flange for superior mechanical stability
- Automatic locking and intuitive release through Lock and Release operating lever in contrasting color
- Conductor connection on several levels enables higher contact density
- Small component size for applications where space is at a premium

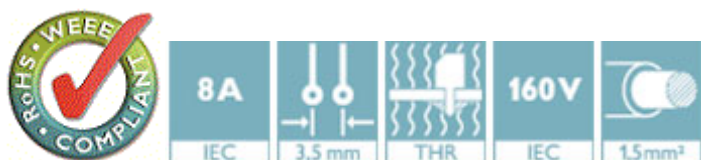

## Key Commercial Data

Packing unit	50 STK
GTIN	
Weight per Piece (excluding packing)	4.18 g
Custom tariff number	85366990
Country of origin	Germany
Note	Made to Order (non-returnable)

## Technical data

Product type	PCB headers
Approval	cULus Recognized
Rated voltage (IEC)	160
Rated current (IEC)	8
Mounting type	THR soldering

# Printed-circuit board connector - DMC 1,5/ 6-G1F-3,5-LR P26THR - 1711100

## Technical data

Number of positions	6
Pitch	3.5 mm
Levels	double-level
Type of locking	Lock & release threaded flange
Plug-in system	MINI COMBICON - DFMC 1,5
Contact type	Male connector

## Drawings

Dimensional drawing

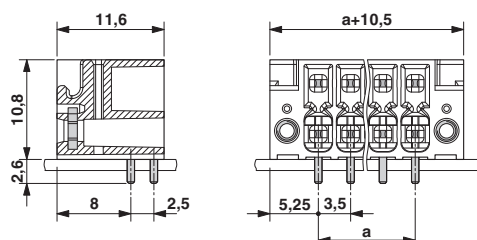

Schematic diagram

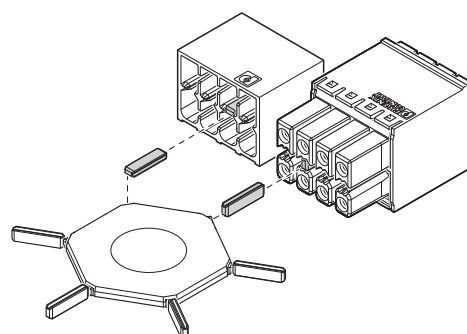

Drilling diagram

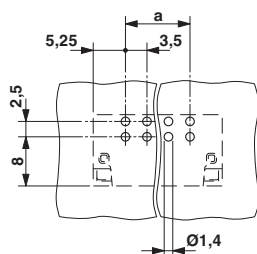

Diagram

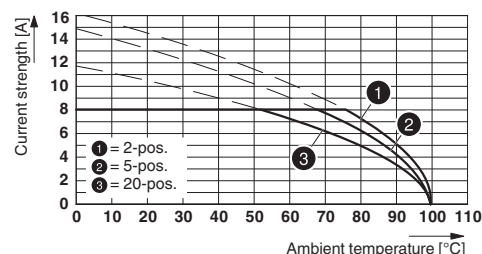

Type: DFMC 1,5/...-ST-3,5-LR with DMC 1,5/...-G1F-3,5-LR P20 THR

## Classifications

eCl@ss

eCl@ss 4.0	272607xx
eCl@ss 4.1	27260701
eCl@ss 5.0	27260701
eCl@ss 5.1	27260701
eCl@ss 6.0	27260704
eCl@ss 7.0	27440402
eCl@ss 8.0	27440402

## Printed-circuit board connector - DMC 1,5/ 6-G1F-3,5-LR P26THR - 1711100

### Classifications

#### eCl@ss

eCl@ss 9.0	27440402
------------	----------

#### ETIM

ETIM 4.0	EC002637
ETIM 5.0	EC002637

#### UNSPSC

UNSPSC 6.01	30211810
UNSPSC 7.0901	39121409
UNSPSC 11	39121409
UNSPSC 12.01	39121409
UNSPSC 13.2	39121409

### Approvals

#### Approvals

##### Approvals

cULus Recognized

Ex Approvals

Approvals submitted

#### Approval details

cULus Recognized		
	B	C
Nominal current I <sub>N</sub>	8 A	8 A
Nominal voltage U <sub>N</sub>	150 V	50 V