

Surge protection device - CN-UB-70DC-6-BB - 2803166

Please be informed that the data shown in this PDF Document is generated from our Online Catalog. Please find the complete data in the user's documentation. Our General Terms of Use for Downloads are valid (<http://phoenixcontact.com/download>)



Attachment plug with surge protection for coaxial signal interfaces. Connection: N connector, female/female

Product Features

- Mounting plate enables mounting, e.g., in a control cabinet
- Gas-filled surge arrester can be replaced in case of malfunction



Key commercial data

Packing unit	1 pc
Weight per Piece (excluding packing)	50.0 GRM
Custom tariff number	85363010
Country of origin	United States

Technical data

Dimensions

Height	24 mm
Width	24 mm
Depth	47 mm

Ambient conditions

Ambient temperature (operation)	-40 °C ... 90 °C
Degree of protection	IP68

General

Housing material	Brass (CuZn)
Color	nickel
Standards for air and creepage distances	DIN VDE 0110-1
	IEC 60664-1
Mounting type	Connection-specific intermediate plugging

Surge protection device - CN-UB-70DC-6-BB - 2803166

Technical data

General

Type	Attachment plug
Direction of action	Line-Shield/Earth Ground

Protective circuit

IEC test classification	C2
	C3
	D1
VDE requirement class	C2
	C3
	D1
Maximum continuous operating voltage U_C	70 V DC
	50 V AC
Maximum continuous voltage U_C (wire-ground)	70 V DC
	50 V AC
Nominal current I_N	10 A
Operating effective current I_C at U_C	$\leq 1 \mu A$
Nominal discharge current I_n (8/20) μs	5 kA
Nominal discharge current I_n (8/20) μs (Core-Earth)	5 kA
Nominal discharge current I_n (8/20) μs (Core-Shield)	5 kA
Total surge current (8/20) μs	5 kA
Max. discharge current I_{max} (8/20) μs maximum (Core-Earth)	10 kA
Max. discharge current I_{max} (8/20) μs maximum (Core-Shield)	10 kA
Nominal pulse current I_{an} (10/1000) μs (Core-Shield)	100 A
Impulse discharge current (10/350) μs , peak value I_{imp}	1 kA
Output voltage limitation at 1 kV/ μs (Core-Earth) spike	$\leq 650 V$
Output voltage limitation at 1 kV/ μs (Core-Shield) spike	$\leq 650 V$
Output voltage limitation at 1 kV/ μs (Core-Earth) static	$\leq 650 V$
Output voltage limitation at 1 kV/ μs (Core-Shield) static	$\leq 650 V$
Voltage protection level U_p (Core-Earth)	$\leq 800 V$ (C2 (4 kV/2 kA))
	$\leq 1 kV$ (C2 (10 kV/5 kA))
Voltage protection level U_p (Core-Shield)	$\leq 800 V$ (C2 (4 kV/2 kA))
	$\leq 1 kV$ (C2 (10 kV/5 kA))
Response time t_A (Core-Earth)	$\leq 100 ns$
Response time t_A (Core-GND)	$\leq 100 ns$
Input attenuation a_E , asym.	0.1 dB (6 GHz)
Cut-off frequency f_g (3 dB), asym. (shield) in 50 Ohm system	$> 6 GHz$
Frequency range	0 Hz ... 6 GHz

Surge protection device - CN-UB-70DC-6-BB - 2803166

Technical data

Protective circuit

Standing wave ratio SWR in a 50 Ω system	typ. 1.15 (6 GHz)
Permissible HF power P_{max} at VSWR = xx (50 ohm system)	30 W (VSWR = 1.15)
Capacity (Core-Earth)	typ. 1.5 pF
Capacity asymmetrical (shield)	typ. 1.5 pF
Surge current resistance (conductor-ground)	C2 - 10 kV/5 kA
	C3 - 100 A
	D1 - 1 kA
Surge current resistance (conductor-shield)	C2 (10 kV/5 kA)
	C3 (100 A)
	D1 (1 kA)
Alternating current carrying capacity (conductor-shield)	5 A - 1 s

Connection data

Connection method	N connector 50 Ω
Connection type IN	N connector, female
Connection type OUT	N connector, female

Standards and Regulations

Standards/regulations	IEC 61643-21
-----------------------	--------------

Classifications

eCl@ss

eCl@ss 4.0	27140201
eCl@ss 4.1	27130801
eCl@ss 5.0	27130801
eCl@ss 5.1	27130801
eCl@ss 6.0	27130807
eCl@ss 7.0	27130807
eCl@ss 8.0	27130807

ETIM

ETIM 2.0	EC000943
ETIM 3.0	EC000943
ETIM 4.0	EC000943
ETIM 5.0	EC000943

UNSPSC

UNSPSC 6.01	30212010
-------------	----------

Surge protection device - CN-UB-70DC-6-BB - 2803166

Classifications

UNSPSC

UNSPSC 7.0901	39121610
UNSPSC 11	39121610
UNSPSC 12.01	39121610
UNSPSC 13.2	39121620

Approvals

Approvals

Approvals

GOST

Ex Approvals

Approvals submitted

Approval details



Accessories

Accessories

Assembly adapter

Mounting plate - CN-UB/MP - 2818135



Tongue for attaching the CN-UB..., to housing panels, for example.

Surge protection device - CN-UB-70DC-6-BB - 2803166

Accessories

Mounting plate - CN-UB/MP-90DEG-50 - 2803137



Angled bracket for individually fixing CN-UB... to housing panels, for example.

Drawings

Dimensioned drawing

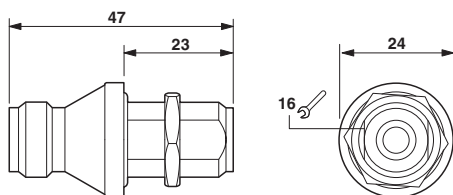

Circuit diagram

