

January 31, 2022

Engineering Change Notification

This notice is to inform you of a change to the following LCD products:

NHD-0216K1Z-FS(RGB)-FBW_rev1
NHD-0216K1Z-NS(RGB)-FBW_rev1

The backlight has been redesigned to improve the connection method for anode and cathode. Old backlight design used thru-hole LEDs with leads that wrapped around the PCB. New backlight design uses surface-mount LEDs, which are connected to the PCB using thru-hole leads.

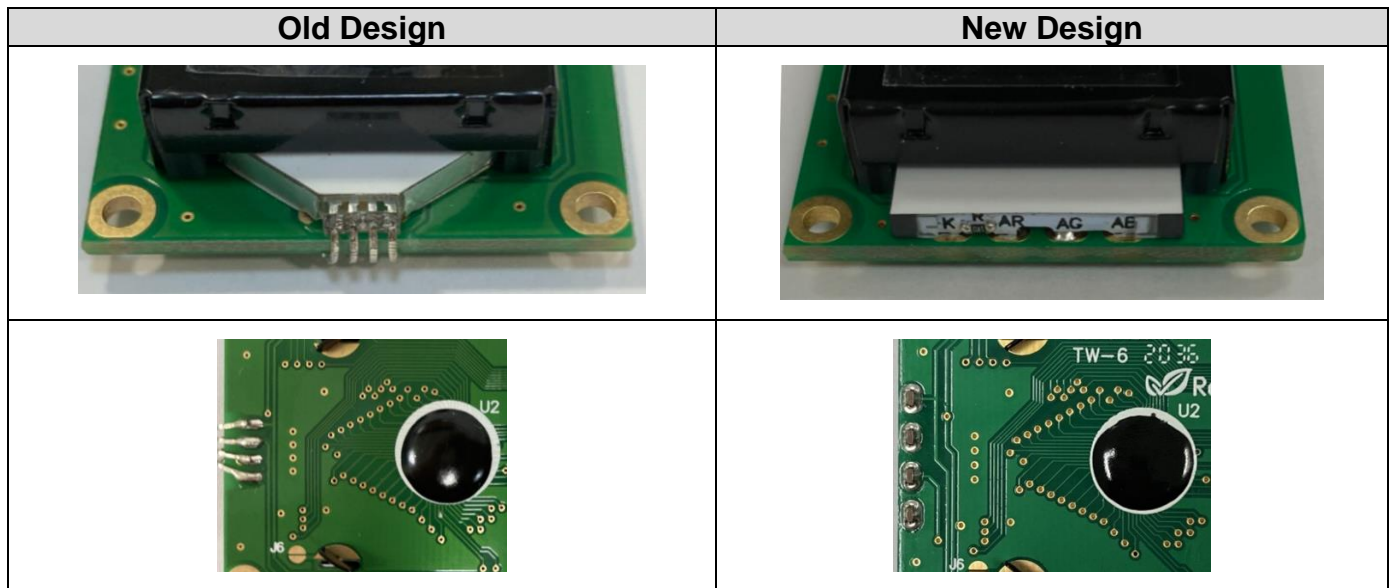

We understand that every customer's application is unique, and therefore recommend you test and validate samples of the updated design.

Samples may be requested by contacting us at nhsales@newhavendisplay.com.
 When requesting samples, please specify that your inquiry pertains to the new version.

Please visit www.newhavendisplay.com or email nhtech@newhavendisplay.com for further information or assistance with this change.