

PLEASE CHECK WWW.MOLEX.COM FOR LATEST PART INFORMATION

Part Number: [62201-8790](#)
Status: **Active**
Description: Backplane Press-In Tool

Documents:
[RoHS Certificate of Compliance \(PDF\)](#)

General

Product Family	Application Tooling
Series	T3002
Comments	See Tooling Specification (PDF) Above
Function	Insertion
Geographic Area	Global
Level of Automation	Manual
More Detailed Tech Information	applicationtooling@molex.com
Product Name	Impact™
Survey	www.molex.com//review/apptool_survey.html
Tool Type	Handtool

Material Info

Reference - Drawing Numbers

Application Tooling Documents ATS-622018790, TM-622018799

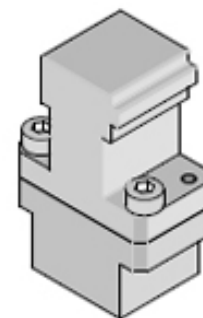

image - Reference only

Series

EU RoHS **China RoHS**

Compliance Status

Not Reviewed

REACH SVHC

Not Reviewed

Low-Halogen Status

Not Reviewed

Need more information on product environmental compliance?

Email productcompliance@molex.com
 For a multiple part number RoHS Certificate of Compliance, [click here](#)

Please visit the [Contact Us](#) section for any non-product compliance questions.

Search Parts in this Series
[T3002Series](#)

Use With
[170335](#) Impact™ Backplane Signal Module Assembly, 4-Pair by 10 Column 85 Ohm Assemblies

Application Tooling Description	FAQ Product #
Impact™ 4 Pair 85-Ohms Vertical Header Module, 1.90mm by 1.35mm Pitch, Right Guided, Left End Wall, 10 Columns, 120 Circuits, Micro Compliant Pin Length 4.90mm, Plated Through HoleDimension 0.39mm	1703359107

This document was generated on 04/05/2012

PLEASE CHECK WWW.MOLEX.COM FOR LATEST PART INFORMATION