

32 WAY CONNECTOR ASSEMBLY  
KEY 1 & KEY 5

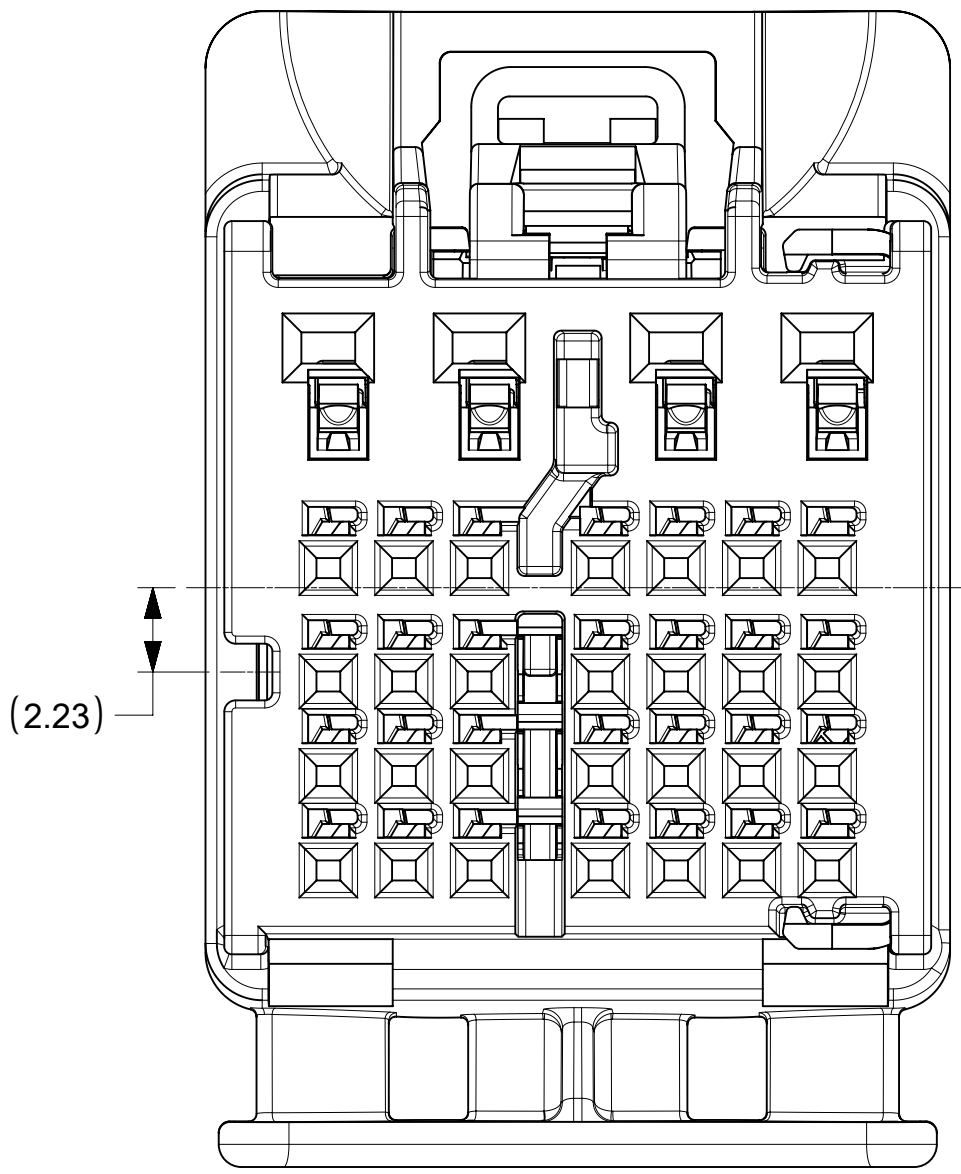

32 WAY CONNECTOR ASSEMBLY  
KEY 2 & KEY 6

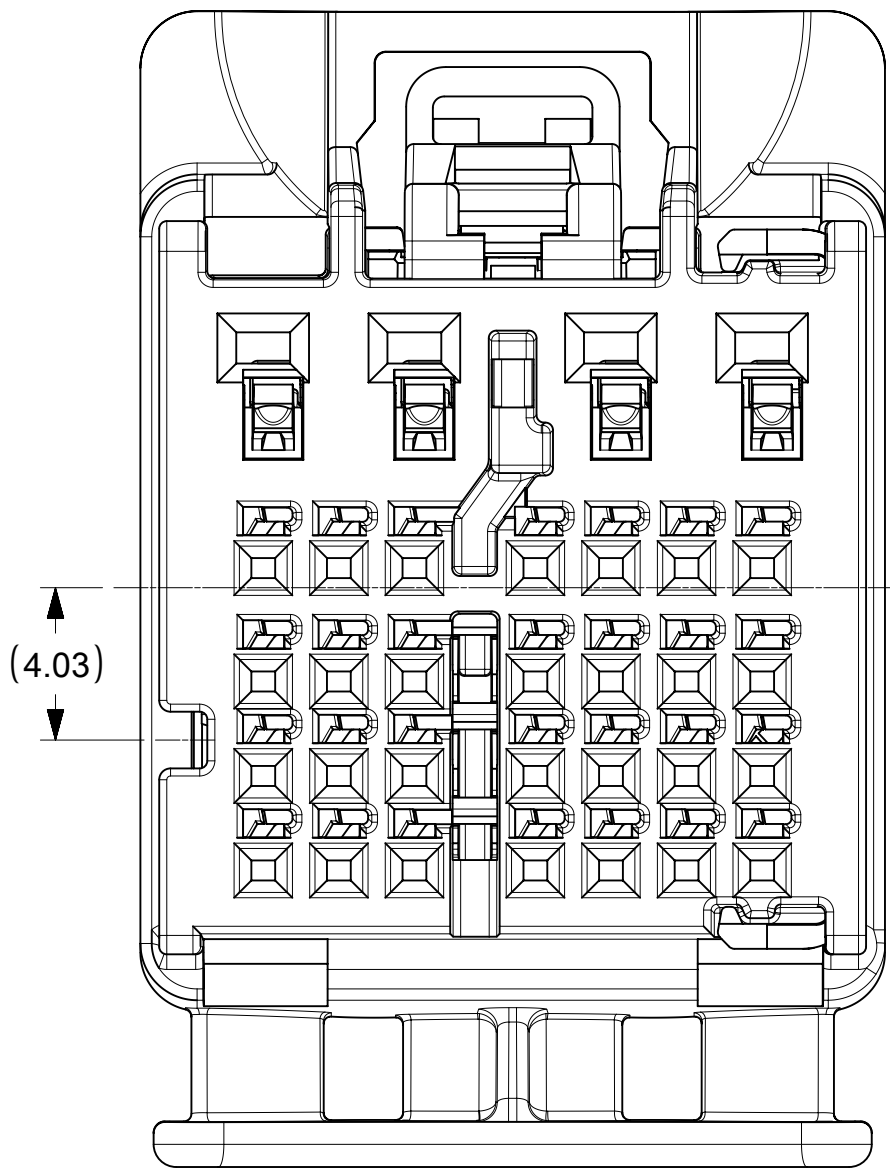

32 WAY CONNECTOR ASSEMBLY  
KEY 3 & KEY 7

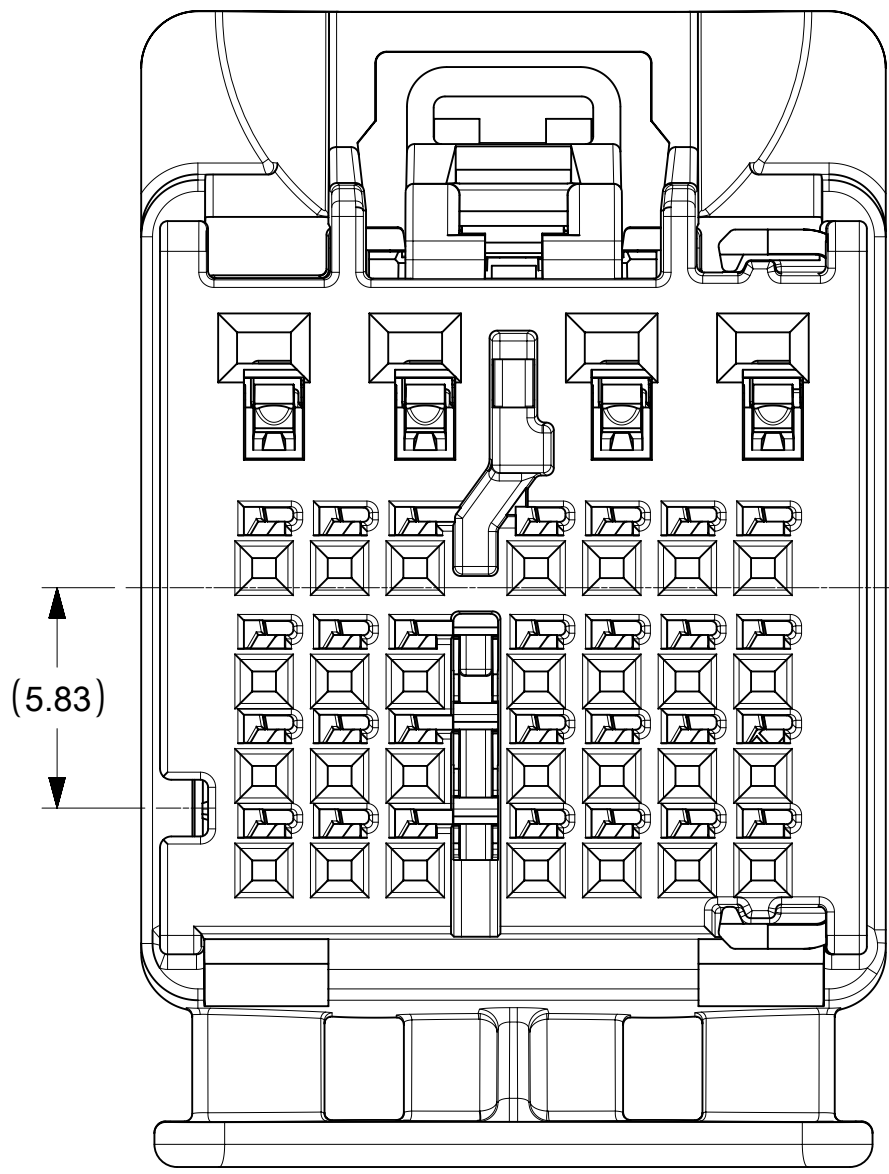

32 WAY CONNECTOR ASSEMBLY  
KEY 4 & KEY 8

- NOTES: VALID UNLESS OTHERWISE SPECIFIED
1. GENERAL:
- a. APPLICATION SPECIFICATION SEE: AS-160014-001
  - b. PRODUCT SPECIFICATION SEE: PS-160014-001
  - c. PACKAGING SPECIFICATION PER MOLEX DRAWING: PK-31302-266
  - d. PARTS MUST BE IN COMPLIANCE TO MOLEX CHEMICAL SUBSTANCES FOR PRODUCTS AND PACKAGING SPECIFICATION: ES-40000-5016
  - e. DATA MUST BE SUBMITTED UNDER THE MOLEX PART NUMBER TO IMDS (COMPANY ID#13255)
2. DESIGN - MATERIALS:
- a. SEE BOM TABLE
3. DESIGN - GEOMETRY:
- a. ALL GRAPHIC DATA IS BASIC (NO TOLERANCE) AND MUST BE TAKEN FROM THE DATA FILE AT ITS LATEST REVISION.
  - b. PRODUCT DESIGN MODEL NUMBER(S): SEE BOM TABLE
  - c. GEOMETRIC DIMENSIONS AND TOLERANCES PER ASME Y14.5-2009
  - d. EDGES AND UNDIMENSIONED DETAILS PER ISO13715
  - e. CORNERS SHOWN AS SHARP TO BE R 0.2 MAX.
  - f. MARKED TEXT TO INCLUDE RECYCLING CODE, CAVITY ID, VENDOR IDENTIFICATION AND CUSTOMER MATERIAL NUMBER.
1. LASER ETCHED DATE CODE
- 1ST THROUGH 2ND DIGIT = CALENDAR YEAR
  - 3RD THROUGH 5TH DIGIT = "DAY #" OF YEAR
  - 6TH THROUGH 7TH DIGIT = HOUR OF DAY
  - 8TH THROUGH 9TH DIGIT = MINUTE OF HOUR
  - 10TH THROUGH 11TH DIGIT = SECOND OF MINUTE
4. DESIGN - MANUFACTURING:
- a. VISUAL DEFECTS SHALL MEET COSMETIC STANDARD PS-45499-002 (Class B)

| PART NUMBER     | PLATING     | SUPPLIER | WIRE GAGE (mm2) | TERMINAL FAMILY                     | WIRE SPECIFICATION   |
|-----------------|-------------|----------|-----------------|-------------------------------------|--|
| 200096-0101     | TIN PLATING | MOLEX    | 0.35            | TAK FAMILY (0.5 mm)                 | VW 60306 OR GMW 15626 (SEE APPLICATION SPECIFICATION FOR MORE DETAILS) |
| 200096-0201     | TIN PLATING | MOLEX    | 0.13            | TAK FAMILY (0.5 mm)                 |  |
| 2272196-2       | TIN PLATING | TE       | 0.35            | Generation 50 Locking Lance (0.5mm) | SAE/ J1128<br>THIN WALL INSULATION                                     |
| 2272196-1       | TIN PLATING | TE       | 0.13            | Generation 50 Locking Lance (0.5mm) |  |
| 13881789        | TIN PLATING | DELPHI   | 0.35 - 0.5      | TAXI TERM OCS 1.2                   |  |
| 13881788        | TIN PLATING | DELPHI   | 0.75 - 0.8      |                                     |  |
| 15542382        | TIN PLATING | DELPHI   | 0.8 - 1.0       |                                     |  |
| 15542380        | TIN PLATING | DELPHI   | 1.25 - 1.5      |                                     |  |
| SMSA-A031T-M1.2 | TIN PLATING | JST      | 0.5 - 0.75      | MSA 1.2mm TERMINAL                  | GMW 15626<br>INSULATION TYPE<br>FLR<br>(REGULAR THIN WALL)             |
| SMSA-A041T-M1.2 | TIN PLATING | JST      | 1.0 - 1.5       | MSA 1.2mm TERMINAL                  |  |

| ITEM | DESCRIPTION          | COLOR       | RECYCLING CODE | WEIGHT (GRAMS) | RIB OPTION | NO OF ITEMS REQUIRED |   |   |   |   |   |   |   |   |   |
|------|----------------------|-------------|----------------|----------------|------------|----------------------|---|---|---|---|---|---|---|---|---|
| 1    | OUTER SHROUD - KEY 1 | BLACK       | SPS/PA66-GF20  | 3.2            | A          | 1                    |   |   |   |   |   |   |   |   |   |
| 2    | OUTER SHROUD - KEY 2 | BLUE        | SPS/PA66-GF20  | 3.2            | A          |                      | 1 |   |   |   |   |   |   |   |   |
| 3    | OUTER SHROUD - KEY 3 | DARK GRAY   | SPS/PA66-GF20  | 3.2            | A          |                      |   | 1 |   |   |   |   |   |   |   |
| 4    | OUTER SHROUD - KEY 4 | PURPLE C    | SPS/PA66-GF20  | 3.2            | A          |                      |   |   | 1 |   |   |   |   |   |   |
| 5    | OUTER SHROUD - KEY 5 | PINK B      | SPS/PA66-GF20  | 3.2            | B          |                      |   |   |   | 1 |   |   |   |   |   |
| 6    | OUTER SHROUD - KEY 6 | TBD         | SPS/PA66-GF20  | 3.2            | B          |                      |   |   |   |   | 1 |   |   |   |   |
| 7    | OUTER SHROUD - KEY 7 | LIGHT BROWN | SPS/PA66-GF20  | 3.2            | B          |                      |   |   |   |   |   | 1 |   |   |   |
| 8    | OUTER SHROUD - KEY 8 | TBD         | SPS/PA66-GF20  | 3.2            | B          |                      |   |   |   |   |   |   | 1 |   |   |
| 9    | ISL                  | NATURAL     | SPS-GF30       | 0.37           | N/A        | 1                    | 1 | 1 | 1 | 1 | 1 | 1 | 1 | 1 | 1 |
| 10   | CPA                  | NATURAL     | PA66-GF50      | 0.08           | N/A        | 1                    | 1 | 1 | 1 | 1 | 1 | 1 | 1 | 1 | 1 |
| 11   | INNER HOUSING        | STONE GRAY  | SPS/PA66-GF20  | 1.75           | N/A        | 1                    | 1 | 1 | 1 |   |   |   |   |   |   |
| 12   | INNER HOUSING        | STONE GRAY  | SPS/PA66-GF20  | 1.75           | N/A        |                      |   |   |   |   | 1 | 1 | 1 | 1 |   |

| MOLEX ASSEMBLY PART NO.'S |       |
|---------------------------|-------|
| 1600280011                | KEY 1 |
| 1600280012                | KEY 2 |
| 1600280013                | KEY 3 |
| 1600280014                | KEY 4 |
| 1600280015                | KEY 5 |
| 1600280016                | KEY 6 |
| 1600280017                | KEY 7 |
| 1600280018                | KEY 8 |

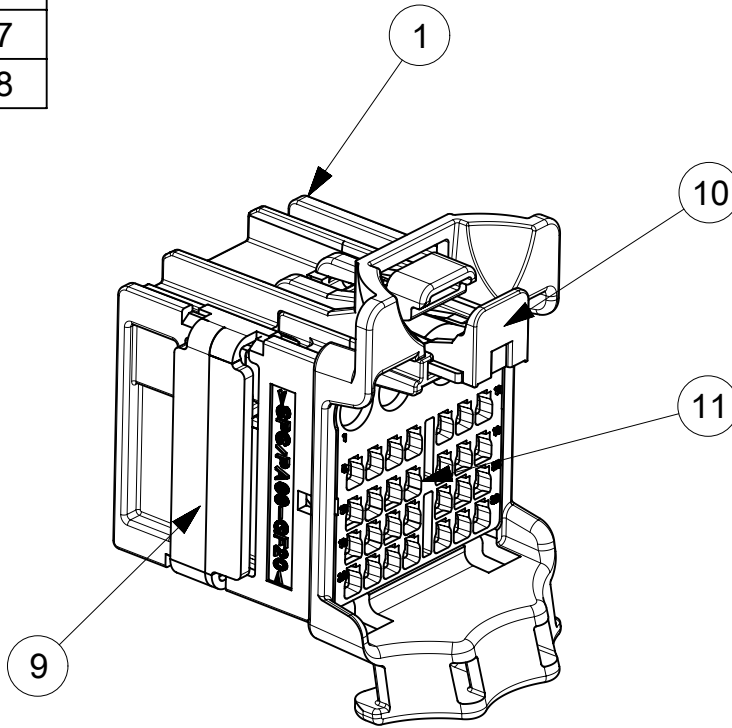

SCALE 2:1

RIB OPTION A

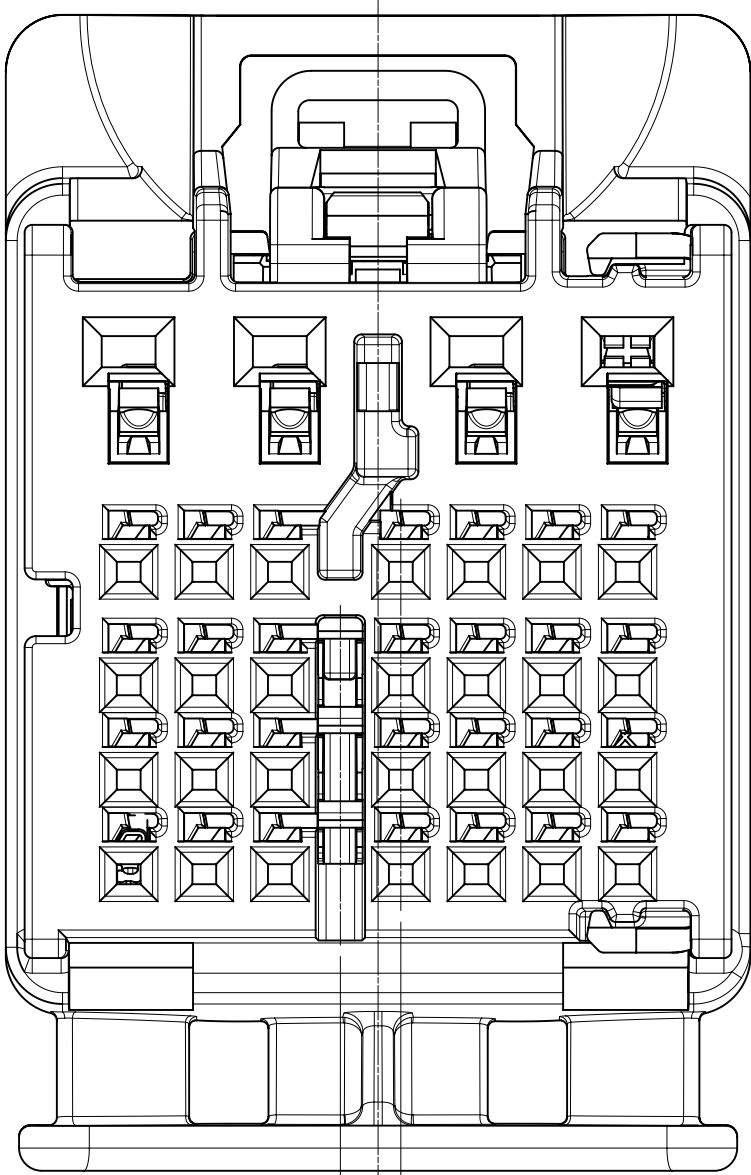

(1.00) (0.60)

RIB OPTION B

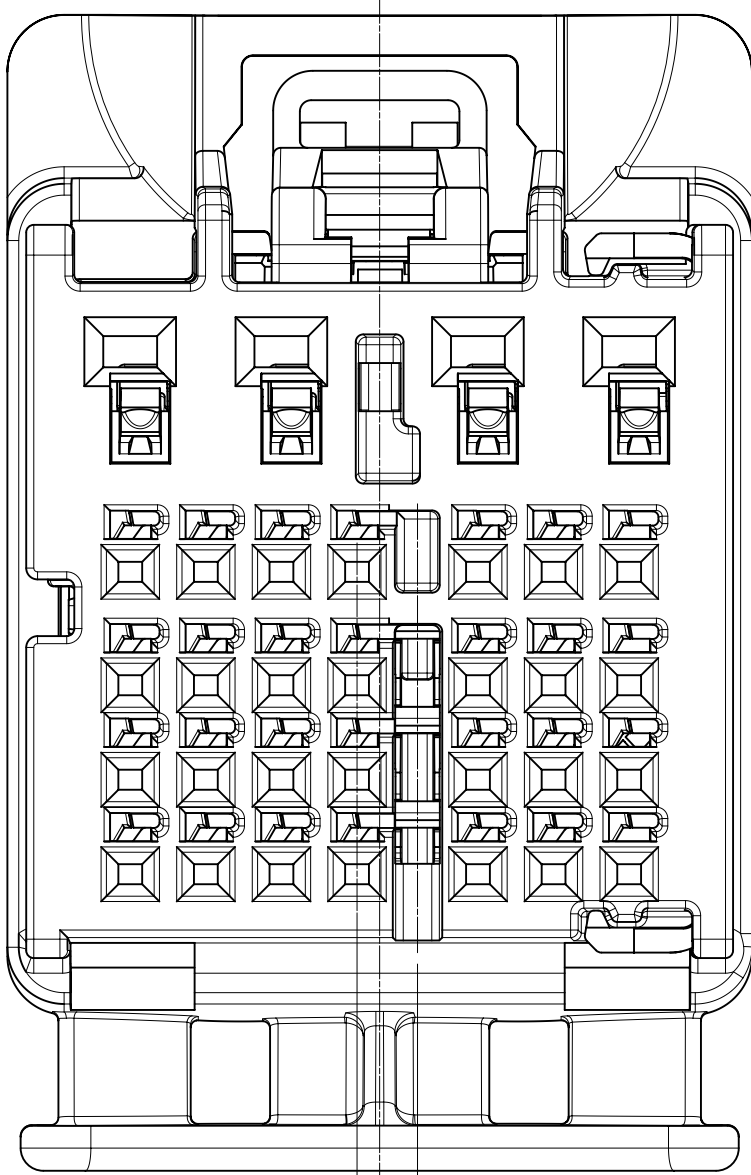

(0.60) (1.00)

| SYMBOLS |     | THIS DRAWING CONTAINS INFORMATION THAT IS PROPRIETARY TO MOLEX ELECTRONIC TECHNOLOGIES, LLC AND SHOULD NOT BE USED WITHOUT WRITTEN PERMISSION |  |       |  |  |  |         |  |        |  |                 |  |                |  |          |  |              |  |
|---------|-----|---|--|-------|--|--|--|---------|--|--------|--|-----------------|--|----------------|--|----------|--|--------------|--|
|         |     | DIMENSION UNITS   |  | SCALE |  | CURRENT REV DESC:  |  |         |  |        |  |                 |  |                |  |          |  |              |  |
|         | = 0 | mm  |  | 5:1   |  | <div>molex</div> <div>32WAY STAK50H HYBRID ASSEMBLY<br/>CONNECTOR ASSEMBLY</div> |  |         |  |        |  |                 |  |                |  |          |  |              |  |
|         | = 0 | GENERAL TOLERANCES<br>(UNLESS SPECIFIED)  |  |       |  |  |  |         |  |        |  |                 |  |                |  |          |  |              |  |
|         | = 0 | ANGULAR TOL ± 3.0°  |  |       |  |  |  |         |  |        |  |                 |  |                |  |          |  |              |  |
|         | = 0 | 4 PLACES  |  | ±     |  |  |  |         |  |        |  |                 |  |                |  |          |  |              |  |
|         | = 0 | 3 PLACES  |  | ±     |  |  |  |         |  |        |  |                 |  |                |  |          |  |              |  |
|         | = 0 | 2 PLACES  |  | ± 0.3 |  | PRODUCT CUSTOMER DRAWING   |  |         |  |        |  |                 |  |                |  |          |  |              |  |
|         | = 0 | 1 PLACE   |  | ± 0.3 |  |  |  |         |  |        |  |                 |  |                |  |          |  |              |  |
|         | = 0 | 0 PLACES  |  | ± 0.3 |  |  |  |         |  |        |  |                 |  |                |  |          |  |              |  |
|         | = 0 | DRAFT WHERE APPLICABLE<br>MUST REMAIN<br>WITHIN DIMENSIONS  |  |       |  | THIRD ANGLE PROJECTION   |  | DRAWING |  | SERIES |  | DOCUMENT NUMBER |  | DOC TYPE       |  | DOC PART |  | REVISION     |  |
|         | = 0 |   |  |       |  |  |  | D-SIZE  |  | 160028 |  | 1600280011      |  | PSD            |  | 000      |  | A3           |  |
|         | = 0 |   |  |       |  |  |  |         |  |        |  | MATERIAL NUMBER |  | CUSTOMER       |  |          |  | SHEET NUMBER |  |
|         | = 0 |   |  |       |  |  |  |         |  |        |  | SEE CHART       |  | GENERAL MARKET |  |          |  | 1 OF 2       |  |

