

MATERIAL NUMBER	ENGINEERING NUMBER	CARRIER	PIN ORIENTATION	DIMENSION "A"	DIMENSION "B"
197134003	19713-4003	STRIP	*TAB FIRST*	.355/9.02	.250/6.35
197134004	19713-4004	STRIP	*PINS FIRST*		

ⓐ

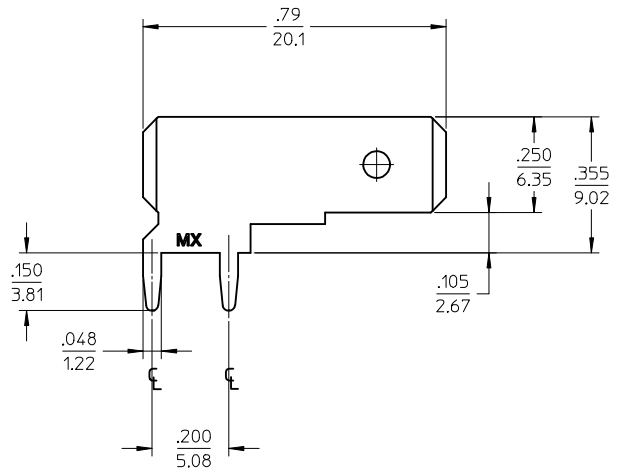

MAX $\frac{.010}{0.25}$ CUTOFF FLASH ALLOWABLE

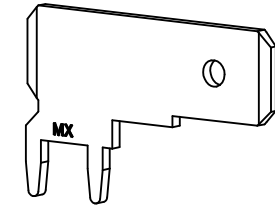
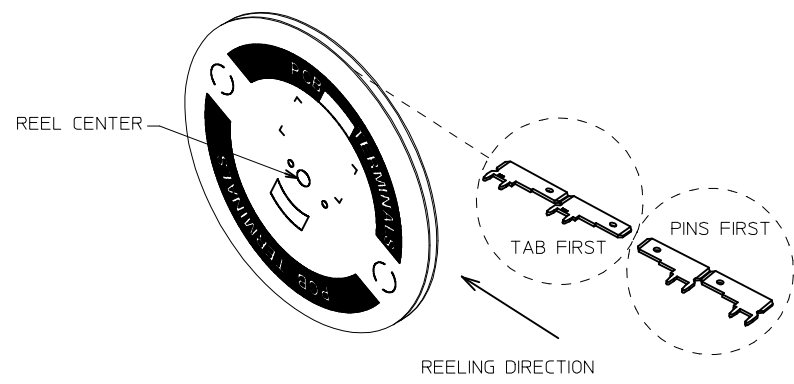
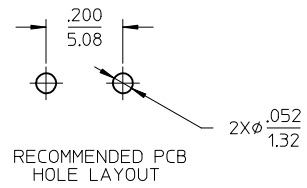
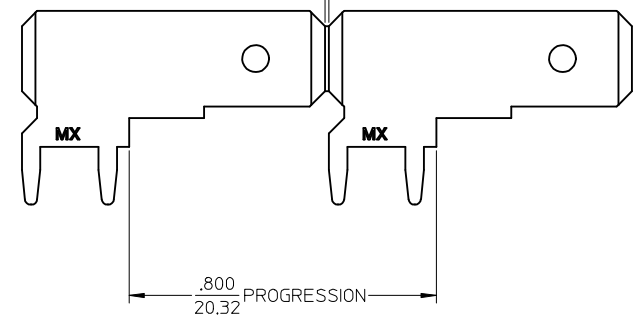

- NOTES:
1. BARE EDGES PERMISSIBLE AT CARRIER CUT OFF.
 2. MATERIAL: BRASS C26000 (.032/0.81) THICK
 3. TAB CONFORMS TO NEMA SPECIFICATIONS.
 4. ALL DIMENSIONS AND NOTES REFERENCE UNLESS OTHERWISE NOTED.
 - ⓐ 5. PLATING: MATTE TIN, 150μN/3.81μm MINIMUM THICKNESS OVER NICKEL 50μN/1.25μm MINIMUM THICKNESS.
 6. REF.: 7,000 MINIMUM PARTS PER REEL, REEL HAS 24" DIAMETER REEL WITH A 1.25" DIAMETER CENTER HOLE.

EC NO: ETC2003-0292 DRWN:DMYRICK 2004/05/13 CHKD:HBEITZE 2004/05/14 APPR:RDEROSS 2004/05/14	QUALITY SYMBOLS	GENERAL TOLERANCES (UNLESS SPECIFIED)		SCALE 4:1	DESIGN UNITS INCH	THIRD ANGLE PROJECTION	REVISE ON CAD ONLY
	DESCRIPTION ▽ -0 ∇ -0		mm	INCH	DIMENSION STYLE		TITLE QUICK DISCONNECT PCB MOUNTABLE .250 X .032 MOLEX INCORPORATED APPROVED BY RWD DATE 11/08/96 MATERIAL NO. SEE CHART DOCUMENT NO. SD-19713-400 SHEET NO. 1 OF 1
		4 PLACES	±---	±---	IN/MM		
		3 PLACES	±---	±.005	DRAWN BY EDB DATE 11/08/96	CHECKED BY JH DATE 11/08/96	
2 PLACES	±0.13	±.01	APPROVED BY RWD DATE 11/08/96	THIS DRAWING CONTAINS INFORMATION THAT IS PROPRIETARY TO MOLEX INCORPORATED AND SHOULD NOT BE USED WITHOUT WRITTEN PERMISSION			
1 PLACE	±0.25	±---	ANGULAR ±1/2°				
DRAFT WHERE APPLICABLE		MUST REMAIN WITHIN DIMENSIONS					