

LEGEND:

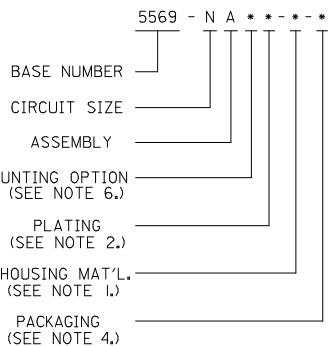

CIRCUIT SIZE	DIM. "A"	DIM. "B"
6	.54 (13.8)	.33 (8.4)
8	.71 (18.0)	.50 (12.6)
10	.87 (22.2)	.66 (16.8)
12	1.04 (26.4)	.83 (21.0)
14	1.20 (30.6)	.99 (25.2)
16	1.37 (34.8)	1.16 (29.4)
18	1.54 (39.0)	1.32 (33.6)
20	1.70 (43.2)	1.49 (37.8)
22	1.87 (47.4)	1.65 (42.0)
24	2.03 (51.6)	1.82 (46.2)

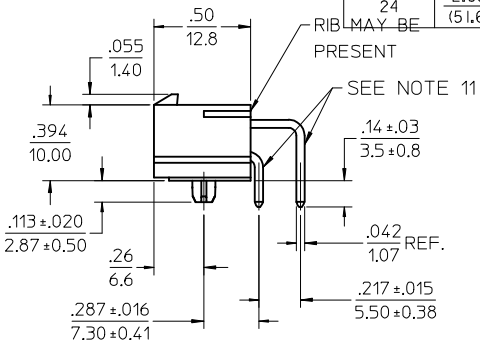

THIS VIEW APPLIES TO ALL CIRCUIT SIZES

NOTES:

- MATERIAL:
HOUSING:
130 = GLASS FILLED LCP, UL94V-0, IEC 60335-1 5TH EDITION GLOW WIRE CAPABLE
COLOR - BLACK
- FINISH (PLATING):
MS = .000100/(0.00254) MIN. MATTE TIN OVER
.000050/(0.00127) MIN. NICKEL
GS = .000030/(0.00076) MIN. SELECT GOLD OVER
.000100/(0.00254) MIN. SELECT MATTE TIN
OVER .000050/(0.00127) MIN. NICKEL OVERALL
- PRODUCT SPECIFICATION: SEE CHARTS
- PACKAGING:
T = TRAY PACKED PER PK-5569-003
- PART MATES WITH MINI-FIT JR. RECEPTACLE SERIES 5557 AND 46992.
- MOUNTING OPTIONS:
7 = PRESS FIT PEG

- DISCOLORATION IN THE BANDOLIER CARRIER AREA OF THE PIN IS INHERENT TO THE PLATING PROCESS AND IS DUE TO THE MASKING EFFECT OF THE CARRIER. THIS DISCOLORATION IS IN A NON-FUNCTIONAL AREA OF THE PIN AND WILL NOT AFFECT THE PERFORMANCE OF THE HEADER ASSEMBLY.
- PART CONFORMS TO CLASS "B" REQUIREMENTS OF COSMETIC SPECIFICATION PS-45499-002.
- CONNECTORS ARE NOT TO BE MATED AND UNMATED WHILE CIRCUITS ARE LIVE.
- PARTS ARE NOT DESIGNED FOR CURRENT SHARING.
- FORMING MARKS ON PINS ARE ACCEPTABLE.
- CORNER CORE-OUTS ARE OPTIONAL AND MAY OR MAY NOT BE PRESENT.
- TEXT ON PART IS FOR REFERENCE ONLY. TEXT AND TEXT LOCATION MAY VARY DEPENDING ON PART NUMBER AND/OR TOOL.

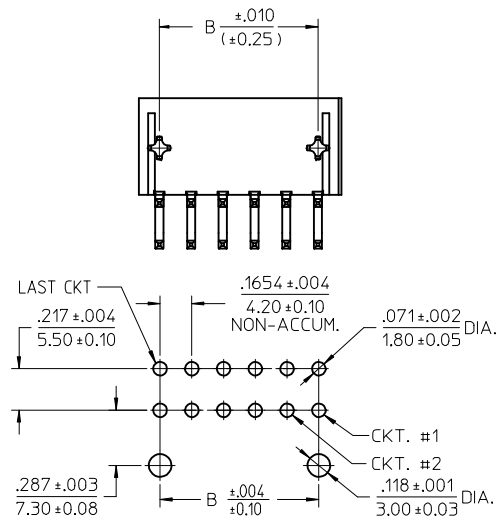
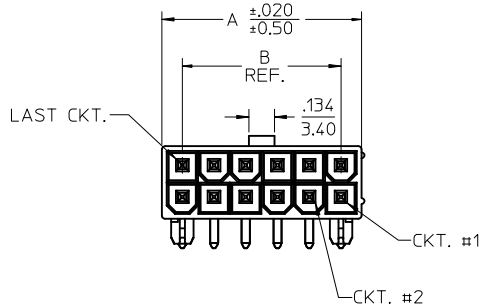

RECOMMENDED HOLE LAYOUT FOR .070/(1.78) MAX. THICK P.C. BOARD VIEWED FROM COMPONENT SIDE FOR 6 THRU 24 CIRCUITS

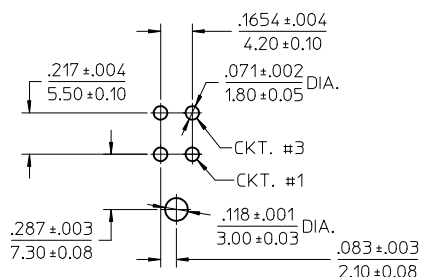
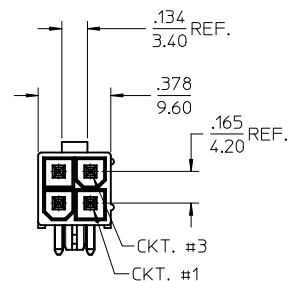

RECOMMENDED HOLE LAYOUT FOR .070/(1.78) MAX. THICK P.C. BOARD VIEWED FROM COMPONENT SIDE FOR 4CKT PARTS

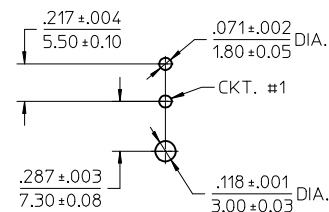
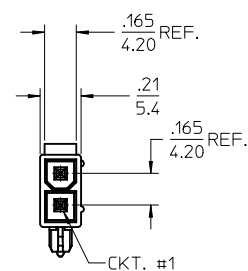

RECOMMENDED HOLE LAYOUT FOR .070/(1.78) MAX. THICK P.C. BOARD VIEWED FROM COMPONENT SIDE FOR 2CKT PARTS

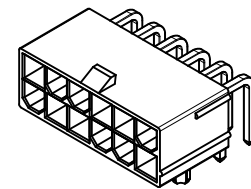
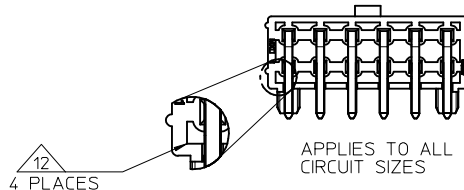

ADD 46999-0271 IEC NO: UCP2016-0460 DRWING: MONT 2015/07/30 CHKD: JBEL 2015/09/08 APPR: FSMITH 2016/09/26	QUALITY SYMBOLS ▽ ⇒ ○ ▽ ⇒ ○ ▽ ⇒ ○	GENERAL TOLERANCES (UNLESS SPECIFIED)		DIMENSION STYLE IN/MM		SCALE 2:1	DESIGN UNITS METRIC	THIRD ANGLE PROJECTION			
		4 PLACES ± --- ± ---	3 PLACES ± --- ±.015	2 PLACES ±.38 ±.015	1 PLACE ±.38 ± ---	0 PLACE ± --- ± ---	DRAWN BY JJAGUIALR	DATE 2009/07/27	TITLE MINI-FIT RTC RIGHT ANGLE HEADER ASSEMBLIES WITH MTG. PEGS (LCP)		
		ANGULAR ±1/2°					CHECKED BY JBELL	DATE 2009/07/27	APPROVED BY FSMITH		DATE 2009/07/31
		DRAFT WHERE APPLICABLE MUST REMAIN WITHIN DIMENSIONS					MATERIAL NO. SEE CHART		DOCUMENT NO. SD-5569-NA2*-130	SHEET NO. 1 OF 2	

THIS DRAWING CONTAINS INFORMATION THAT IS PROPRIETARY TO MOLEX. INCORPORATED AND SHOULD NOT BE USED WITHOUT WRITTEN PERMISSION

TOOLED	PART NO.	ENG. NO.	CKT. SIZE	MOUNTING OPTION	PLATING (SEE NOTE 2)	HOUSING MATERIAL (SEE NOTE 1)	PACKAGING	PRODUCT SPECIFICATION
YES	50-36-2457	5569-02A7MS-130-T	2	PRESS FIT PEGS	MATTE TIN/NICKEL	94V-0	TRAY PACKAGED PER PK-5569-003	PS-5556-004
	50-36-2459	5569-04A7MS-130-T	4	PRESS FIT PEGS	MATTE TIN/NICKEL	94V-0		
	50-36-2462	5569-06A7MS-130-T	6	PRESS FIT PEGS	MATTE TIN/NICKEL	94V-0		
	50-36-2464	5569-08A7MS-130-T	8	PRESS FIT PEGS	MATTE TIN/NICKEL	94V-0		
	50-36-2466	5569-10A7MS-130-T	10	PRESS FIT PEGS	MATTE TIN/NICKEL	94V-0		
	50-36-2296	5569-12A7MS-130-T	12	PRESS FIT PEGS	MATTE TIN/NICKEL	94V-0		
	50-36-2428	5569-14A7MS-130-T	14	PRESS FIT PEGS	MATTE TIN/NICKEL	94V-0		
	50-36-2426	5569-16A7MS-130-T	16	PRESS FIT PEGS	MATTE TIN/NICKEL	94V-0		
NO	50-36-2468	5569-18A7MS-130-T	18	PRESS FIT PEGS	MATTE TIN/NICKEL	94V-0		
	50-36-2471	5569-20A7MS-130-T	20	PRESS FIT PEGS	MATTE TIN/NICKEL	94V-0		
	50-36-2473	5569-22A7MS-130-T	22	PRESS FIT PEGS	MATTE TIN/NICKEL	94V-0		
	50-36-2475	5569-24A7MS-130-T	24	PRESS FIT PEGS	MATTE TIN/NICKEL	94V-0		
	46999-0720	5569-02A7GS-130-T	2	PRESS FIT PEGS	SELECT GOLD/NICKEL	94V-0		
	46999-0721	5569-04A7GS-130-T	4	PRESS FIT PEGS	SELECT GOLD/NICKEL	94V-0		
	46999-0722	5569-06A7GS-130-T	6	PRESS FIT PEGS	SELECT GOLD/NICKEL	94V-0		
	46999-0723	5569-08A7GS-130-T	8	PRESS FIT PEGS	SELECT GOLD/NICKEL	94V-0		
NO	46999-0724	5569-10A7GS-130-T	10	PRESS FIT PEGS	SELECT GOLD/NICKEL	94V-0		
	46999-0725	5569-12A7GS-130-T	12	PRESS FIT PEGS	SELECT GOLD/NICKEL	94V-0		
	46999-0726	5569-14A7GS-130-T	14	PRESS FIT PEGS	SELECT GOLD/NICKEL	94V-0		
	46999-0727	5569-16A7GS-130-T	16	PRESS FIT PEGS	SELECT GOLD/NICKEL	94V-0		
	46999-0728	5569-18A7GS-130-T	18	PRESS FIT PEGS	SELECT GOLD/NICKEL	94V-0		
	46999-0729	5569-20A7GS-130-T	20	PRESS FIT PEGS	SELECT GOLD/NICKEL	94V-0		
	46999-0730	5569-22A7GS-130-T	22	PRESS FIT PEGS	SELECT GOLD/NICKEL	94V-0		
	46999-0731	5569-24A7GS-130-T	24	PRESS FIT PEGS	SELECT GOLD/NICKEL	94V-0		

SEE SHEET 1 EC NO: UCP2016-0460 DRWN: J.MONTI 2015/07/30 CHKD: J.BELL 2015/09/08 APPR: F.S.MITH 2016/09/26	QUALITY SYMBOLS 	GENERAL TOLERANCES (UNLESS SPECIFIED)		DIMENSION STYLE IN/MM		SCALE 1:1	DESIGN UNITS METRIC	THIRD ANGLE PROJECTION	
		4 PLACES ± --- ± ---	3 PLACES ± --- ± .015	2 PLACES ± .38 ± .015	1 PLACE ± .38 ± ---	0 PLACE ± --- ± ---	DRAWN BY JJAGUIALR	DATE 2009/07/27	TITLE MINI-FIT RTC RIGHT ANGLE HEADER ASSEMBLIES WITH MTG. PEGS (LCP)
		ANGULAR ±1/2°					CHECKED BY JBELL	DATE 2009/07/27	
		DRAFT WHERE APPLICABLE MUST REMAIN WITHIN DIMENSIONS					APPROVED BY FSMITH	DATE 2009/07/31	
MATERIAL NO. SEE CHART					DOCUMENT NO. SD-5569-NA2*-130		SHEET NO. 2 OF 2		