

# SPFR SERIES 1000 VDC HIGH-AMPERAGE SOLAR FUSES

1000 VDC • Fast-Acting • 250-400 Amperes



## Specifications

- Voltage Rating:** 1000 VDC
- Ampere Ratings:** 250, 300, 350 and 400 A
- Interrupting Rating:** 10,000 A; Time Constant less than 1ms
- Fuse Type:** Fast-Acting
- Approvals:** UL Recognized 1000 VDC UL 248 (File No. 71611)  
CSA Certified (File No. 29862)

## Ordering Information

CATALOG NUMBER	SYSTEM NUMBER	AMPERAGE
SPFR 250	SPFR250.X	250
SPFR 300	SPFR300.X	300
SPFR 350	SPFR350.X	350
SPFR 400	SPFR400.X	400

## Recommended Fuseholders

SPFRHV Series

## Dimensions in mm (inches)

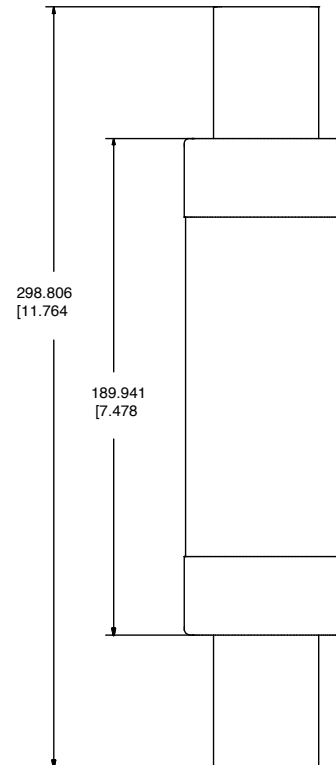

## Description

The SPFR series was designed to meet the growing needs of the solar industry with higher amperage and voltage requirements. It was developed specifically for solar applications ranging from 250 A to 400 A.

## Applications

- Solar inverters
- High-amperage combiner boxes

## Features/Benefits

- DC voltage rating meets European system requirements and North American utility scale requirements
- Multiple amperage ratings
- UL Class H Dimensions
- Full range protection

## Web Resources

Downloadable CAD drawings and other technical information:  
[www.littelfuse.com/spfr](http://www.littelfuse.com/spfr)



Look for this logo to indicate products that are used in solar applications. Visit our website [www.littelfuse.com/solar](http://www.littelfuse.com/solar) for the latest updates on approvals, certifications, codes and standards.