

\*\*\* 2530 Series \*\*\*

Material : UL 94V-0 Nylon 6/6

Color : White

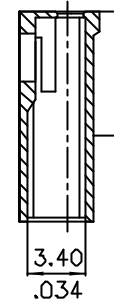
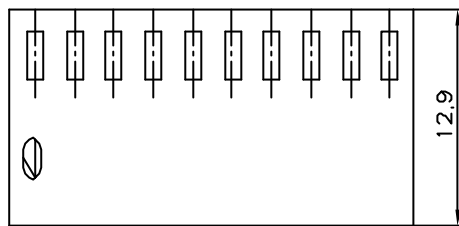
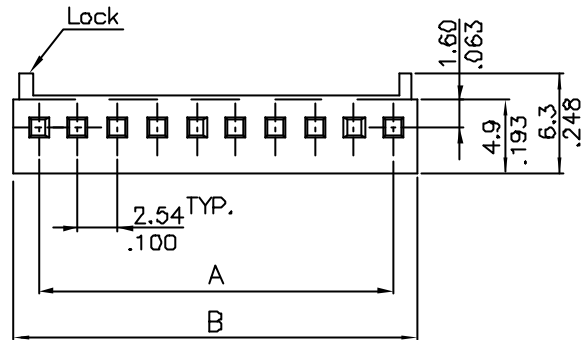

Part No.		Dimension		Part No.		Dimension	
With Lock	Without Lock	A	B	With Lock	Without Lock	A	B
2530S020013	2530S020N13	2.540(.100)	5.7(.224)	2530S140013	2530S140N13	33.020(1.300)	36.2(1.425)
2530S030013	2530S030N13	5.080(.200)	8.2(.323)	2530S150013	2530S150N13	35.560(1.400)	38.7(1.524)
2530S040013	2530S040N13	7.620(.300)	10.8(.425)	2530S160013	2530S160N13	38.100(1.500)	41.3(1.626)
2530S050013	2530S050N13	10.160(.400)	13.3(.524)	2530S170013	2530S170N13	40.640(1.600)	43.8(1.724)
2530S060013	2530S060N13	12.700(.500)	15.9(.626)	2530S180013	2530S180N13	43.180(1.700)	46.3(1.823)
2530S070013	2530S070N13	15.240(.600)	18.4(.724)	2530S190013	2530S190N13	45.720(1.800)	48.9(1.925)
2530S080013	2530S080N13	17.780(.700)	20.9(.823)	2530S200013	2530S200N13	48.260(1.900)	51.4(2.024)
2530S090013	2530S090N13	20.320(.800)	23.5(.925)	2530S210013	2530S210N13	50.800(2.000)	54.0(2.126)
2530S100013	2530S100N13	22.860(.900)	26.0(1.024)	2530S220013	2530S220N13	53.340(2.100)	56.5(2.224)
2530S110013	2530S110N13	25.400(1.000)	28.6(1.126)	2530S230013	2530S230N13	55.880(2.200)	59.1(2.327)
2530S120013	2530S120N13	27.940(1.100)	31.1(1.224)	2530S240013	2530S240N13	58.420(2.300)	61.6(2.425)
2530S130013	2530S130N13	30.480(1.200)	33.6(1.323)	2530S250013	2530S250N13	60.960(2.400)	64.2(2.528)

				<b>LECO CORPORATION</b>	APPROVED BY:	PART NO.: 2530S**0*13				
D	E010060			<b>GENERAL TOLERANCE</b>	CHECKED BY:	TITLE: HOUSING				
C	E990348				DRAW BY: <b>Angela</b> May. 21/'01	DRAWING NO.: 253001S				
B	E960305					UNITS	SCALE	SIZE	SHEET	REV.
A	DWG REL.					mm	~	A4	1/1	D
REV.	ECO. NO.	CHG	APPD.	.XXX ± .010 .004	.XXX ±					