

28B0686-200- BROADBAND CYLINDRICAL CORES

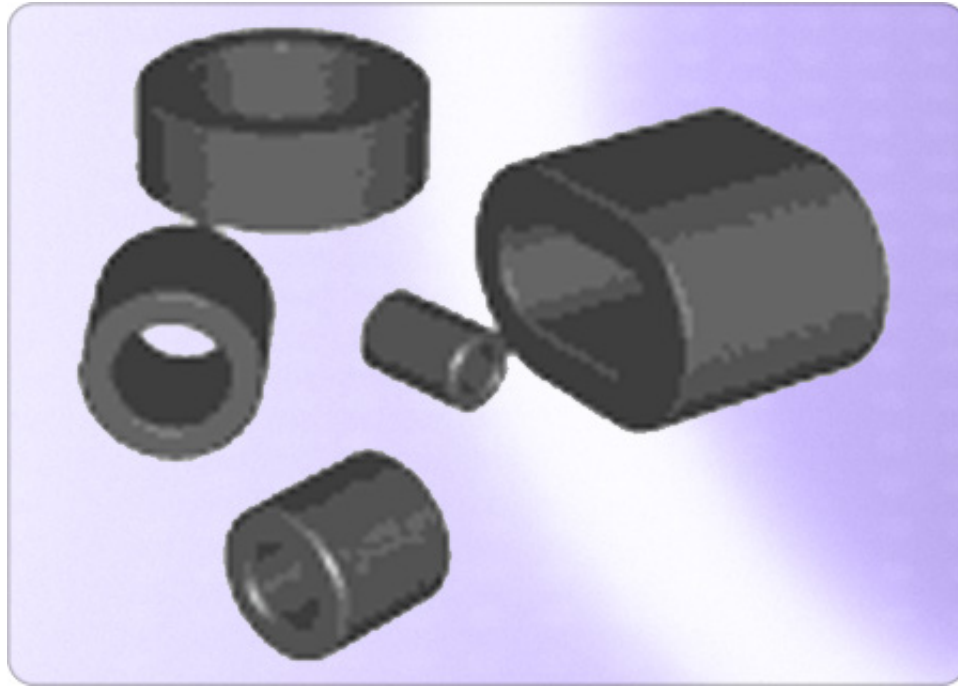

BROADBAND SOLID FERRITE CORES FOR ROUND CABLES AND WIRING HARNESSSES

Laird Cylindrical EMI suppression ferrites provide a cost effective means of reducing common and differential mode EMI. These cores are most frequently used to suppress common mode EMI on the internal and external cable assemblies of electronic equipment. By decreasing the levels of EMI radiated by internal cables, ferrite cores can reduce the cost and amount of overall shielding required to confine EMI within a product's enclosure. They may also be successfully used on power cables that carry digital or analog signaling. To achieve maximum EMI filtering performance in a given application, select a ferrite with an inner diameter most closely matching the outer diameter of the wire or wire bundle to be filtered. The in-circuit impedance may be substantially increased by passing 2 turns of the wire conductor through the ferrite core. A typical common mode application might have two conductors passed through a ferrite core. With equal and opposite currents flowing through the core, zero net bias is established through the component, and maximum impedance is thus realized from the ferrite.



Prototyping Available



Custom Solutions



Standard Stock



Samples Available

Specifications

Additional Product Description Standard Part	Applications <ul style="list-style-type: none"> • Internal and external computer data and power cables • Products with limited PC board space available for surface mount components • Printer cables • Power supply cables • Monitor cables • USB Cables 	Dimension A (inches) 0.69	Dimension A (mm) 17.42
Dimension B (inches) 0.38	Dimension B (mm) 9.53	Dimension C (inches) 1.13	Dimension C (mm) 28.58
Figure Number 1	Material Type Broad Band Material	Nominal Z Ohms at 100 MHz 242	Part Size Code 0686
Product Line Round and Cylindrical Cores	Typical Z Ohms , at 25 MHz 124, at 300 MHz 390		

Features

Wide range of sizes with inner diameters from 0.90 mm (0.035") to 35.65 mm (1.400")

Precision formed smooth surfaces prevent damage to wire insulation

Available in Steward broad band (28), high frequency (HF) and Low frequency (LF) materials

Custom designs available.