

Recommended PCB Layout  
(Top View)

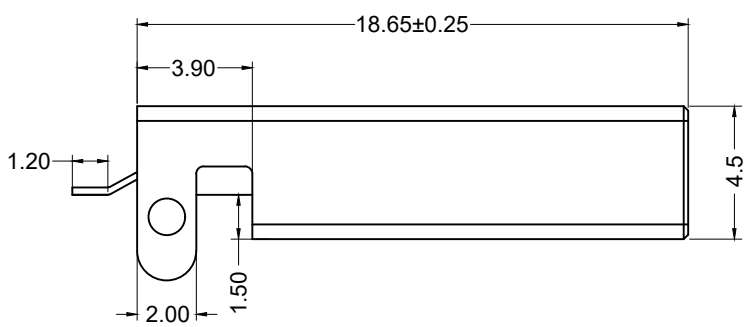

**Material and Finish**

Insulator: High Temp.  
Thermoplastic  
UL94V-0

Contact: Copper Alloy

Plating Options:

Standard: Gold Flash  
on Contact Area,  
Tin on Solderails,  
with Nickel Underplated

30 Option: 30u" Gold  
on Contact Area,  
Tin on Solderails,  
with Nickel Underplated

Shield: Steel, Tin Plated

**Electrical Specifications:**

Current Rating:1.0A

Voltage Rating:30V AC(rms)

Contact Resistance:  
30m ohm. Max.

Insulation Resistance:  
1000M ohm. Min.

Withstanding Voltage:  
500V AC For One Minute

Operating Temperature Range:  
-55°C To +85°C

Part Number	Contact Area Plating Finish	Insulator Color
KUSBX-SMT2AP5S-W	Gold Flash (standard)	White
KUSBX-SMT2AP5S-W30	30u" Gold (30 option)	
KUSBX-SMT2AP5S-B	Gold Flash (standard)	Black
KUSBX-SMT2AP5S-B30	30u" Gold (30 option)	

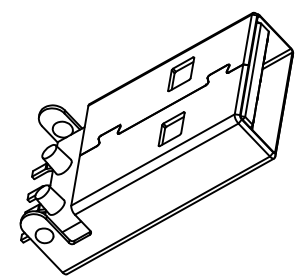

Tolerances
X.X ± 0.25
X.XX ± 0.15
Unless Stated
Otherwise

REV.	DATE	DESCRIPTION	REV. BY	CHK. BY	DRAWN BY	DATE
A1	05/11/05	New Drawing	H. MA	C. Furumasu	H. MA	05/10/05
A2	07/27/05	ECO# 05-020	R. Aguirre	H. MA		
B1	09/04/08	ECO# 08-071	S. Vien	H. MA		
B2	07/22/13	ECO #13-050	W. Cook	P. DalCanto		
B3	09/24/13	ECO #13-076	D. Gih	H. MA		
B4	08/17/18	Address Update	G. Serrato	D. Shehan		

**KUSBX-SMT2AP5S-x**

USB Type A Plug, 4 Position, RoHS Compliant

SMT, Through Hole Shield Tabs, With 1.35 Post

