

REVISION RECORD			
REV.	ECO	Engineering Change Request/Notice Number	DATE
1	SIN	N.A.	27/03/2007
2	SIN	N.A.	30/05/2007

Ordering Information: 5622-720F-XX

ML- 30u" Au  
SL- 15u" Au

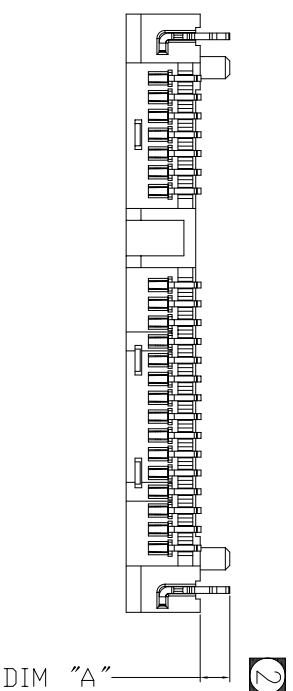
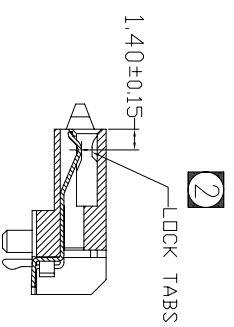
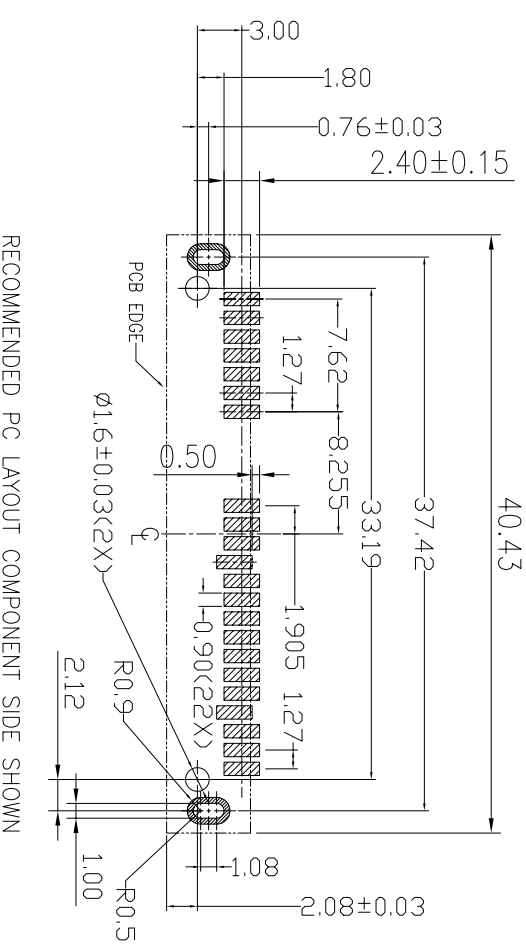
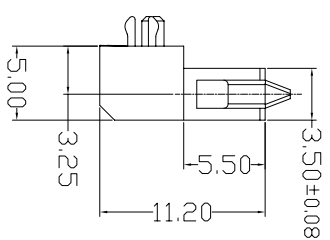
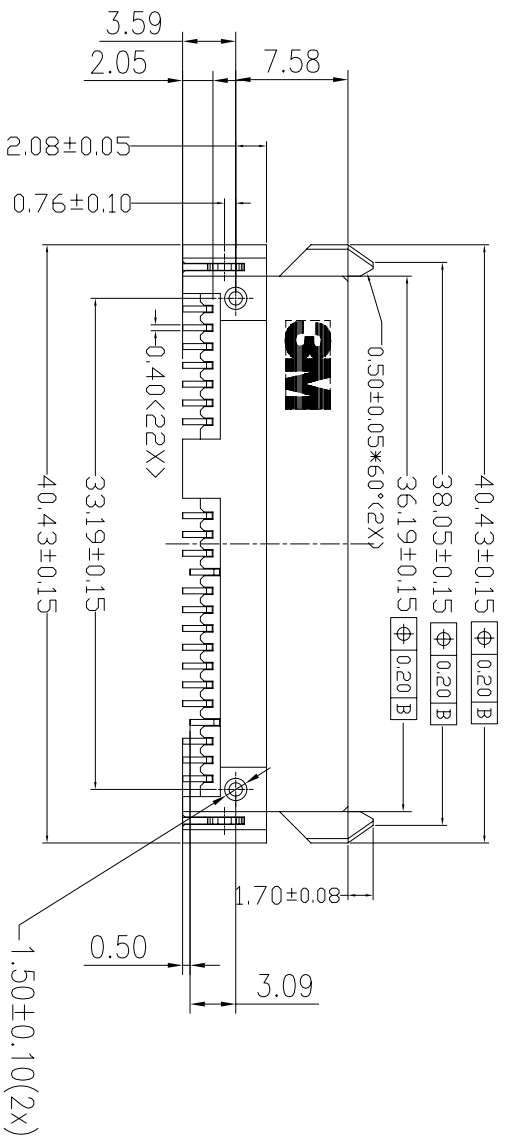
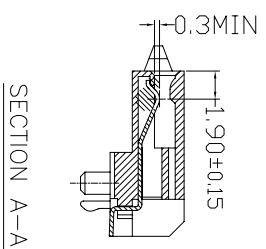
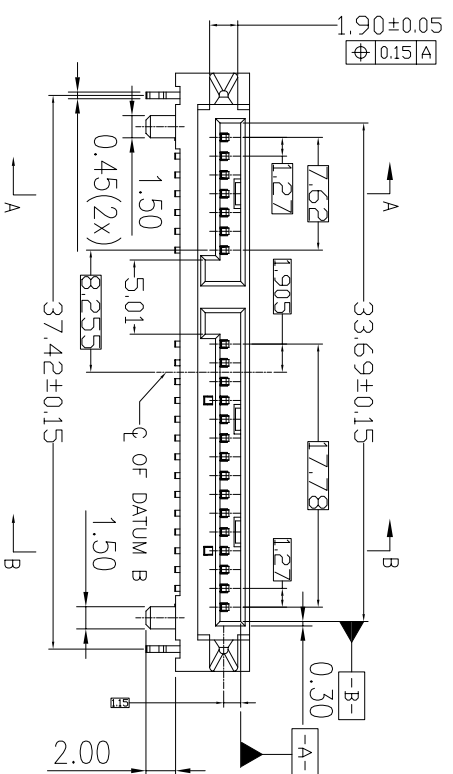

PRELIMINARY

- NOTES:
- 1 : SATA SERIES BACKPLANE RECEPTACLE
  - 2 : HOUSING MATERIAL: High Temp LCP
  - 3 : CONTACT MATERIAL: Copper Alloy
  - 4 : CONTACT PLATING: Mating Area - Min. 30u" Au/Min. 15u" Au  
Solder tail Area - Min. 30u" Matte Sn
  - 5 : HOUSING COLOR: BLACK
  - 6 : LOCK TABS  
PCB THICKNESS 1.45~1.78, DIM"A"=2.36  
PCB THICKNESS 1.20, DIM"A"=2.00
  - 7 : ROHS COMPLIANT

UNIT: MM	DFTG	SAJUT BANDHU	DATE	30/05/07
GEN. TOLERANCES	CHKD	SAJUT BANDHU	DATE	30/05/07
LINEAR 0.0 = ± 0.25 0.00 = ± 0.15 .000 = ± 0.05	APPL	ALAN ANG	DATE	30/05/07
ANGLE ±1'	THIS DOCUMENT CONTAINS INFORMATION WHICH IS PROPRIETARY TO 3M COMPANY. NO REPRODUCTION OR IN PART, SHALL BE MADE WITHOUT AUTHORIZATION FROM 3M.			
PROJECTION	INTERPRET PER ANSI Y14.5M-1994			

TITLE	3M APAC INNOVATION CENTRE	DIVISION	ESD	STATUS	PRELIMINARY
SIZE	A3	DRAWING NO. 78-9100-3991-2		REV	2
SCALE : 2:1					
DEF LIST <input type="checkbox"/> YES <input type="checkbox"/> NO					
SHT 1 of 1					