

3M™ DIN C-FORM & R-FORM SOCKET, DIN 41612 SERIES

VERTICAL, RIGHT ANGLE, SOLDER TAIL OR PRESS-FIT TERMINATION

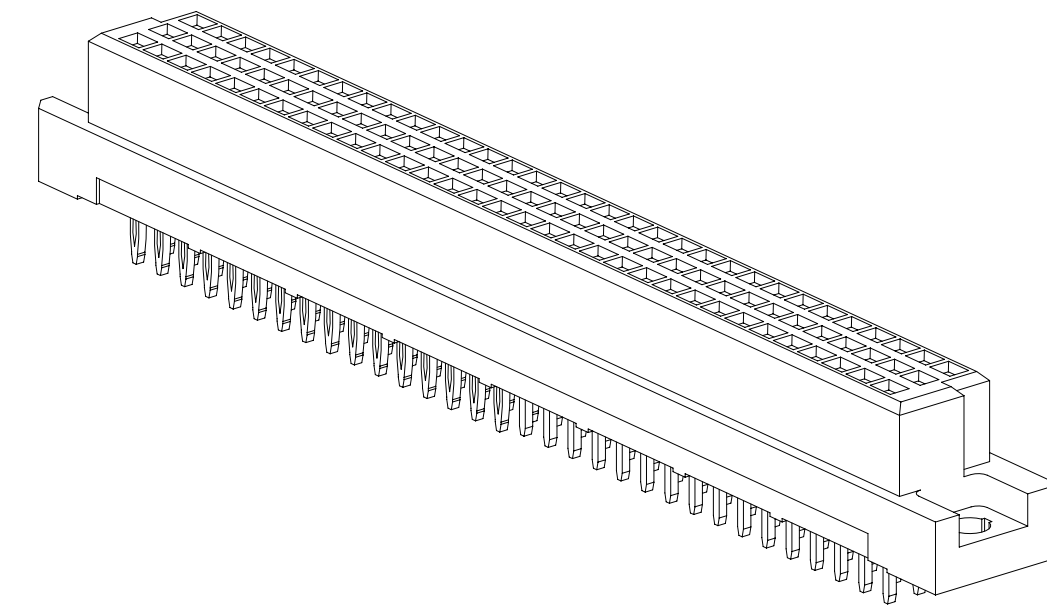

DIN-XXXCSX-XXX
VERTICAL VERSION

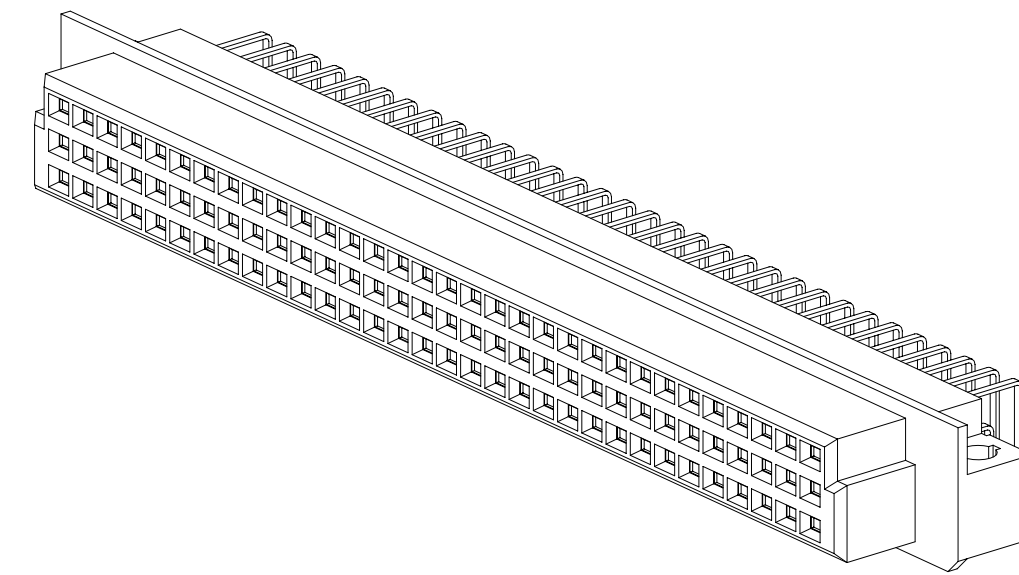

DIN-XXXRSX-XXX
RIGHT ANGLE VERSION

2 PHYSICAL :

INSULATOR: GLASS FILLED POLYESTER (PBT)
 MATERIAL: UL94V-0
 FLAMMABILITY: UL94V-0
 COLOR: GRAY
 CONTACT: COPPER ALLOY
 MATERIAL: COPPER ALLOY
 PLATING: 50μ" MIN. NICKEL
 UNDER PLATING: SEE ORDERING INFORMATION
 WIPING AREA: SEE ORDERING INFORMATION
 TERMINATION AREA: SEE ORDERING INFORMATION

2 ELECTRICAL :

CURRENT RATING: 3.0A AT 30°C T-RISE ABOVE AMBIENT
 CONTACT RESISTANCE: ≤20mΩ
 INSULATION RESISTANCE: ≥1,000 MΩ, 100 V_{DC}
 WITHSTANDING VOLTAGE: 1,000V_{AC} FOR 1 MINUTE

2 ENVIRONMENTAL :

TEMPERATURE RATING: -55°C TO 125°C
 PROCESS TEMPERATURE RATING: MAX. INSULATOR TEMPERATURE 191°C
 (SOLDER WAVE PROCESS ONLY)

- NOTES
- REGULATORY INFORMATION: ROHS COMPLIANT. SEE THE REGULATORY INFORMATION APPENDIX (RIA) IN THE "ROHS COMPLIANCE" SECTION OF WWW.3MCONNECTORS.COM FOR COMPLIANCE INFORMATION.
 - IN THE EVENT OF CONFLICT BETWEEN THIS DATA AND THAT CONTAINED IN THE PRODUCT SPECIFICATION, THE PRODUCT SPECIFICATION TAKES PRECEDENT.

3M ELECTRONICS MATERIALS SOLUTIONS DIVISION
 INTERCONNECT SOLUTIONS
<http://www.3mconnectors.com>

3M IS A TRADEMARK OF 3M COMPANY.
 FOR TECHNICAL, SALES OR ORDERING
 INFORMATION CALL 800-225-5373

MM [INCH]			
TOLERANCE - UNLESS NOTED			
	X.	.X	.XX
MM	±.50	±.25	±.15
[INCH]	±.020	±.010	±.006
[] = DIM. FOR REFERENCE ONLY			

RU
 UL FILE NO: E68080

DIMENSIONS: MM [INCHES]
 [INCHES] IS REF. ONLY

DESIGN REFERENCE	NEXT ASSEMBLY	REV	ECO	ISSUE DATE AND DESCRIPTION	DRFT	CHKD
				FEB 24, 2017 PRODUCTION RELEASE	JNC	WL
APPROVED	DATE	APPROVED	DATE	This document and the information it contains are 3M property and may not be reproduced or further distributed without 3M permission, or used or disclosed other than for 3M authorized purposes. All rights reserved.		
CASTIGLIONE	FEB 20, 2017	W. LEE	FEB 20, 2017			
DIVISION		DIVISION CODE		© 3M COPYRIGHT 2017 3M Center St. Paul, MN 55144		
DO NOT SCALE DRAWING		SCALE	TOLERANCES EXCEPT AS NOTED	TITLE DIN C & R-FORM SKT, RA, VERT, SOLDER TAIL OR PRESS-FIT		
THIRD ANGLE PROJECTION		1	INCHES	CAGE NUMBER D 78-5100-2670-7		
INTERPRET PER ASME Y14.5 - 2009			MILLIMETERS	DRAWING NO. 78-5100-2670-7		
MAX SURFACE ROUGHNESS			0	REV. A		
LIT SURFACES			0	MODEL SHT 1 OF 4		
MARKED ONLY			0			

78-5100-2670-7
 DRAWING NUMBER
 A
 REVISION
 A.2 2/24/2017 10:32 AM UTC-06:00

3M™ DIN C-FORM & R-FORM SOCKET, DIN 41612 SERIES

VERTICAL, RIGHT ANGLE, SOLDER TAIL OR PRESS-FIT TERMINATION

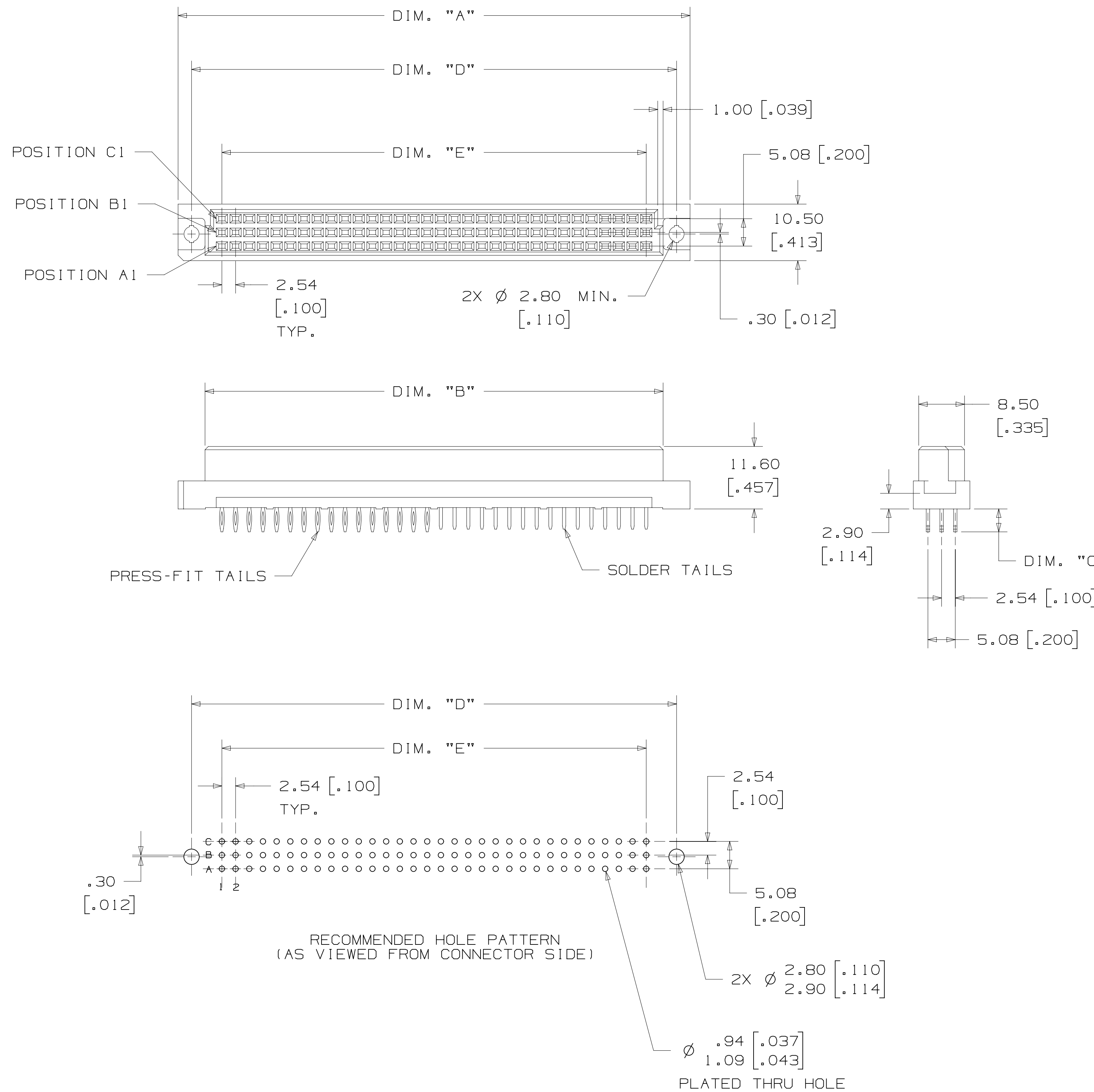

CONTACT QTY.	PART NUMBER	DIM. "A"	DIM. "B"	DIM. "D"	DIM. "E"	CONTACT QTY.
16	DIN-016CSA-XXX-XXXX	54.40 [2.142]	44.40 [1.748]	50.00 [1.969]	38.10 [1.500]	16
32	DIN-032CSB-XXX-XXXX	54.40 [2.142]	44.40 [1.748]	50.00 [1.969]	38.10 [1.500]	32
48	DIN-048CSC-XXX-XXXX	54.40 [2.142]	44.40 [1.748]	50.00 [1.969]	38.10 [1.500]	48
32	DIN-032CSD-XXX-XXXX	54.40 [2.142]	44.40 [1.748]	50.00 [1.969]	38.10 [1.500]	32
16	DIN-016CSE-XXX-XXXX	54.40 [2.142]	44.40 [1.748]	50.00 [1.969]	38.10 [1.500]	16
32	DIN-032CSA-XXX-XXXX	95.00 [3.740]	85.00 [3.346]	90.00 [3.543]	78.74 [3.100]	32
64	DIN-064CSB-XXX-XXXX	95.00 [3.740]	85.00 [3.346]	90.00 [3.543]	78.74 [3.100]	64
96	DIN-096CSC-XXX-XXXX	95.00 [3.740]	85.00 [3.346]	90.00 [3.543]	78.74 [3.100]	96
64	DIN-064CSD-XXX-XXXX	95.00 [3.740]	85.00 [3.346]	90.00 [3.543]	78.74 [3.100]	64
32	DIN-032CSE-XXX-XXXX	95.00 [3.740]	85.00 [3.346]	90.00 [3.543]	78.74 [3.100]	32

ORDERING INFORMATION C-FORM VERSION

DIN-XXXCSX-XXX-XX

CONTACT QUANTITY:
(SEE TABLE 1)

A = A ROW ONLY (SEE NOTE)
B = ROWS A & C FILLED
C = ROWS A, B & C FILLED
D = ROWS A & B FILLED
E = B ROW ONLY (SEE NOTE)

TERMINATION OPTIONS:
SEE TABLE 2

PLATING:

SH = 1-3μ" GOLD ON CONTACT AREA
120-200μ" MATTE TIN ON TERMINAL
FJ = 10-20μ" GOLD ON CONTACT AREA
120-200μ" MATTE TIN ON TERMINAL
KR = 30-40μ" GOLD ON CONTACT AREA
120-200μ" MATTE TIN ON TERMINAL
HM = 3μ" GOLD ON CONTACT AREA, 7μ" MIN. PdNi
120-200μ" MATTE TIN ON TERMINAL
KV = 30μ" GOLD ON CONTACT AREA, 1-3μ" GOLD ON BOARD TERMINATION

NOTE:
1) A AND E OPTIONS ARE CURRENTLY NOT COVERED IN UL FILE NO. E68080.
2) MATES WITH C-FORM AND R-FORM PLUGS.

SOLDER TERMINATION OPTION NO.	DIM. "C"	COMMENTS
R1L	3.75 [.148]	WITH RETENTION CLIP
R3L	2.29 [.090]	WITH RETENTION CLIP
S1L	3.75 [.148]	NO RETENTION CLIP
S3L	2.29 [.090]	NO RETENTION CLIP
W	14.70 [.579]	NO RETENTION CLIP
PRESS-FIT TERMINATION OPTION NO.	DIM. "C"	COMMENTS
PS	5.99 [.236]	
PSL	4.25 [.167]	
PW1	12.90 [.508]	

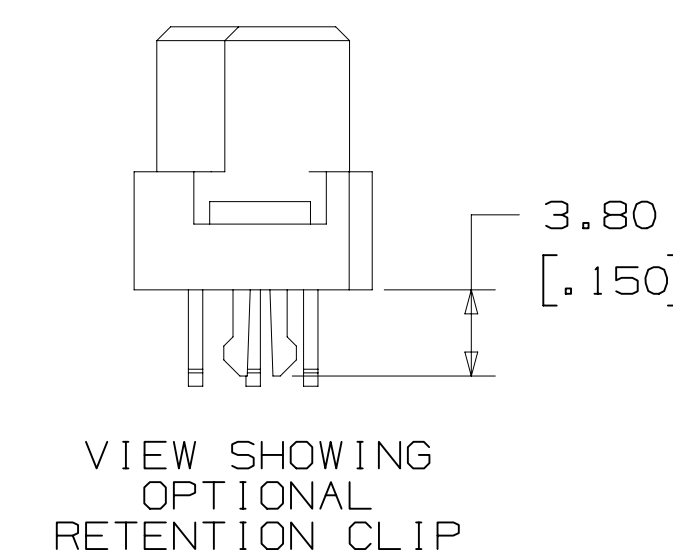

DESIGN REFERENCE	NEXT ASSEMBLY	REV	ECO	ISSUE DATE AND DESCRIPTION	DRFT	CHKD
				FEB 20, 2017		
DO NOT SCALE DRAWING	SCALE 2/1	TOLERANCES EXCEPT AS NOTED		INCHES		
THIRD ANGLE PROJECTION		MILLIMETERS		DATE		
INTERPRET PER ASME Y14.5 - 2009		MAX SURFACE ROUGHNESS		CAGE NUMBER		
DTX SURFACES		MARKED ONLY		DRAWING NO.		
				D 78-5100-2670-7		
				REV. A		
				SHT 2 OF 4		

78-5100-2670-7
DRAWING NUMBER
REV. A
DATE FEB 20, 2017
MFG DATE
APPR. W. LEE
DATE FEB 20, 2017
© 3M COPYRIGHT 2017
This document and the information it contains are 3M property and may not be reproduced or further distributed without 3M permission, or used or disclosed other than for 3M authorized purposes. All rights reserved.
3M Center St. Paul, MN 55144
A.2 2/24/2017 10:32 AM UTC-06:00

3M™ DIN C-FORM & R-FORM SOCKET, DIN 41612 SERIES

VERTICAL, RIGHT ANGLE, SOLDER TAIL OR PRESS-FIT TERMINATION

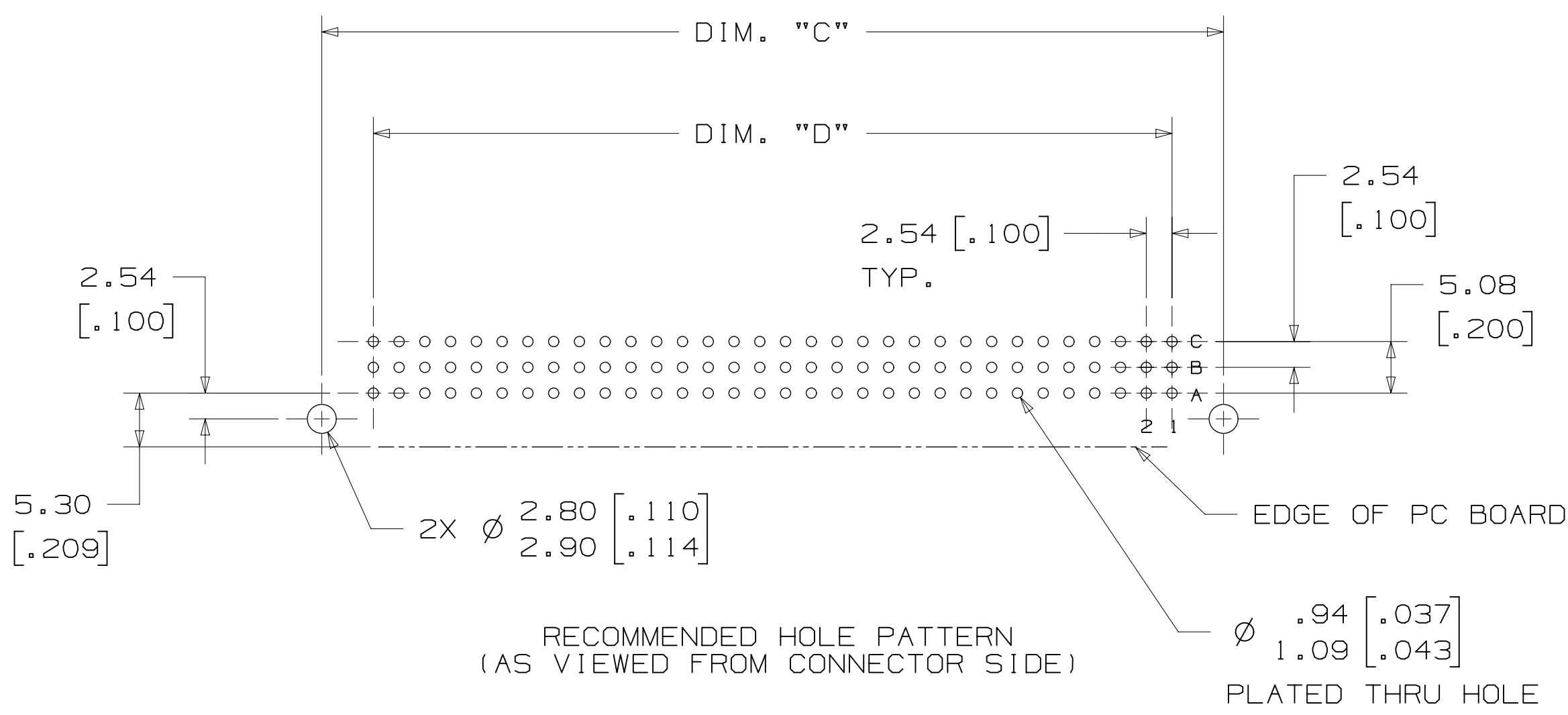
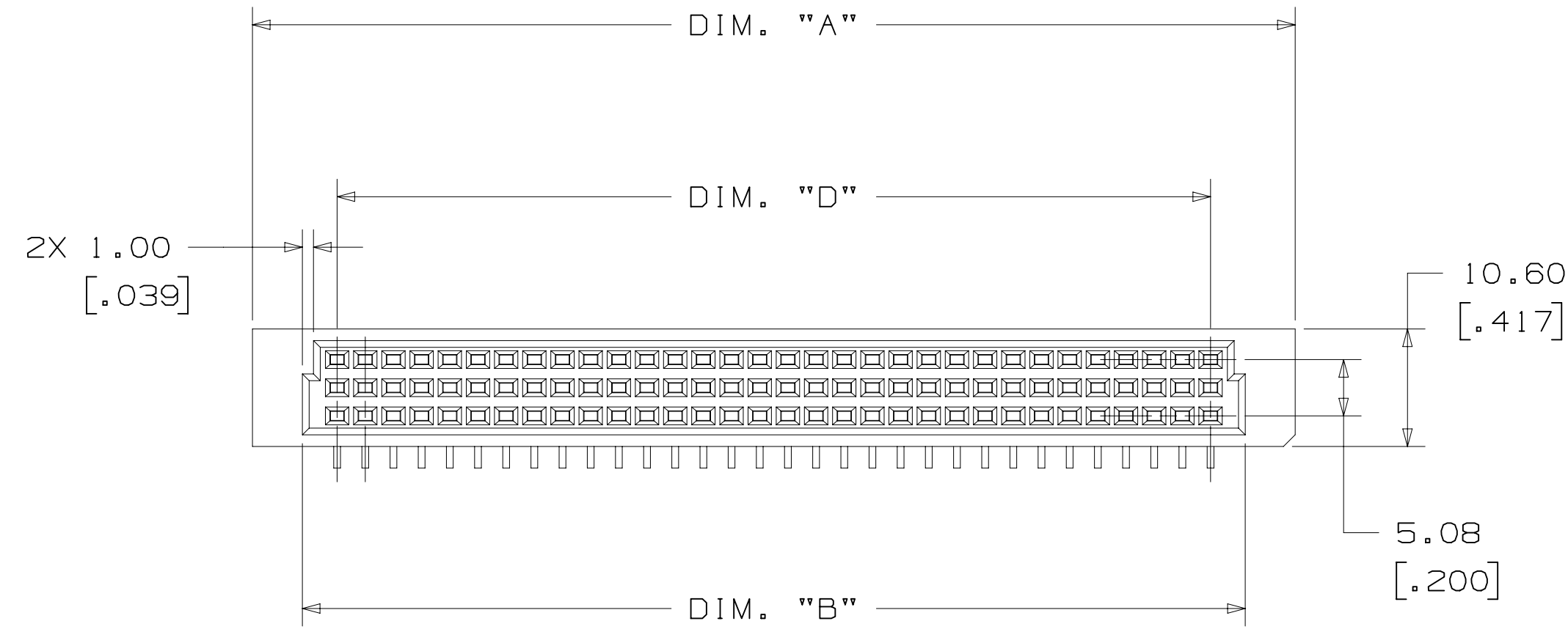
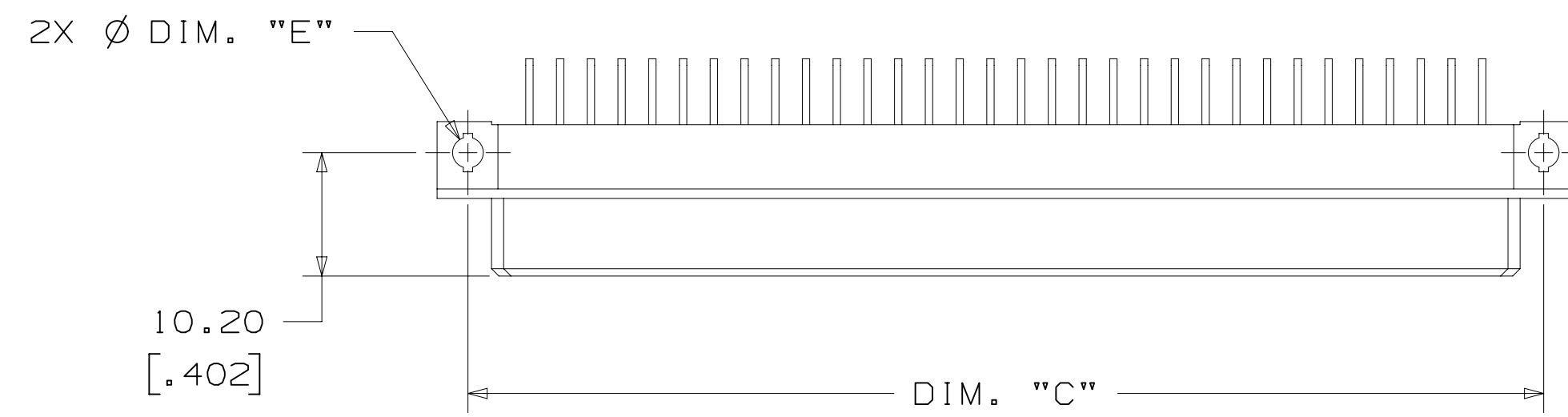

CONTACT QTY.	PART NUMBER	DIM. "A"	DIM. "B"	DIM. "C"	DIM. "D"	DIM. "E"	DIM. "F"	CONTACT QTY.
16	DIN-016RSA-XXX-XXXX	53.40 [2.102]	44.40 [1.748]	48.26 [1.900]	38.10 [1.500]	Ø2.60 [.102]	.25 [.010]	16
32	DIN-032RSB-XXX-XXXX	53.40 [2.102]	44.40 [1.748]	48.26 [1.900]	38.10 [1.500]	Ø2.60 [.102]	.25 [.010]	32
48	DIN-048RSC-XXX-XXXX	53.40 [2.102]	44.40 [1.748]	48.26 [1.900]	38.10 [1.500]	Ø2.60 [.102]	.25 [.010]	48
32	DIN-032RSD-XXX-XXXX	53.40 [2.102]	44.40 [1.748]	48.26 [1.900]	38.10 [1.500]	Ø2.60 [.102]	.25 [.010]	32
16	DIN-016RSE-XXX-XXXX	53.40 [2.102]	44.40 [1.748]	48.26 [1.900]	38.10 [1.500]	Ø2.60 [.102]	.25 [.010]	16
32	DIN-032RSA-XXX-XXXX	94.00 [3.701]	85.00 [3.346]	88.90 [3.500]	78.74 [3.100]	Ø2.60 [.102]	.25 [.010]	32
64	DIN-064RSB-XXX-XXXX	94.00 [3.701]	85.00 [3.346]	88.90 [3.500]	78.74 [3.100]	Ø2.60 [.102]	.25 [.010]	64
96	DIN-096RSC-XXX-XXXX	94.00 [3.701]	85.00 [3.346]	88.90 [3.500]	78.74 [3.100]	Ø2.60 [.102]	.25 [.010]	96
64	DIN-064RSD-XXX-XXXX	94.00 [3.701]	85.00 [3.346]	88.90 [3.500]	78.74 [3.100]	Ø2.60 [.102]	.25 [.010]	64
32	DIN-032RSE-XXX-XXXX	94.00 [3.701]	85.00 [3.346]	88.90 [3.500]	78.74 [3.100]	Ø2.60 [.102]	.25 [.010]	32
40	DIN-040RSA-XXX-XXXX	114.32 [4.501]	105.32 [4.146]	109.22 [4.300]	99.06 [3.900]	Ø2.80 [.110]	.60 [.024]	40
80	DIN-080RSB-XXX-XXXX	114.32 [4.501]	105.32 [4.146]	109.22 [4.300]	99.06 [3.900]	Ø2.80 [.110]	.60 [.024]	80
120	DIN-120RSC-XXX-XXXX	114.32 [4.501]	105.32 [4.146]	109.22 [4.300]	99.06 [3.900]	Ø2.80 [.110]	.60 [.024]	120
80	DIN-080RSD-XXX-XXXX	114.32 [4.501]	105.32 [4.146]	109.22 [4.300]	99.06 [3.900]	Ø2.80 [.110]	.60 [.024]	80
40	DIN-040RSE-XXX-XXXX	114.32 [4.501]	105.32 [4.146]	109.22 [4.300]	99.06 [3.900]	Ø2.80 [.110]	.60 [.024]	40

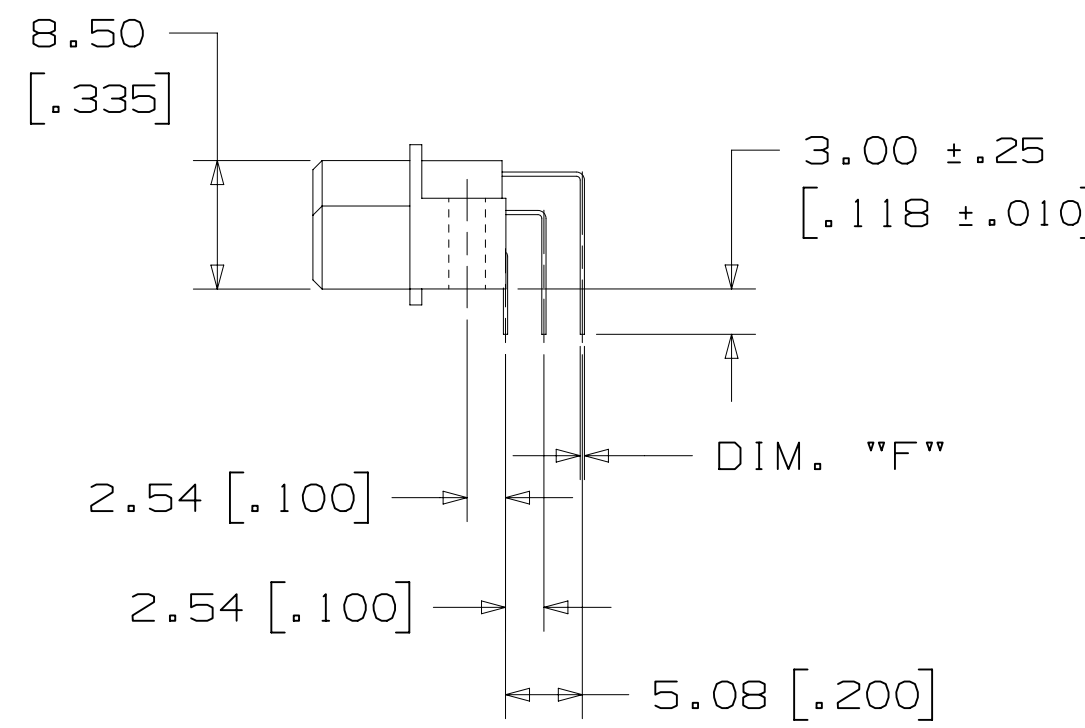

ORDERING INFORMATION R-FORM VERSION

DIN-XXXRSX-XXX-XX

CONTACT QUANTITY:
(SEE TABLE 1)

A = A ROW ONLY (SEE NOTE)
B = ROWS A & C FILLED
C = ROWS A, B & C FILLED
D = ROWS A & B FILLED
E = B ROW ONLY (SEE NOTE)

PLATING:

SH = 1-3µ" GOLD ON CONTACT AREA
120-200µ" MATTE TIN ON TERMINAL
FJ = 10-20µ" GOLD ON CONTACT AREA
120-200µ" MATTE TIN ON TERMINAL
KR = 30-40µ" GOLD ON CONTACT AREA
120-200µ" MATTE TIN ON TERMINAL
HM = 3µ" GOLD ON CONTACT AREA, 7µ" MIN. PdNi
120-200µ" MATTE TIN ON TERMINAL

TERMINATION OPTIONS:

SR1 = 3.00 [.118]
RR1L = 3.00 [.118] WITH 'B' RETENTION CLIPS

NOTE:
1) A AND E OPTIONS ARE CURRENTLY NOT COVERED IN UL FILE NO. E68080.
2) MATES WITH C-FORM AND R-FORM PLUGS.

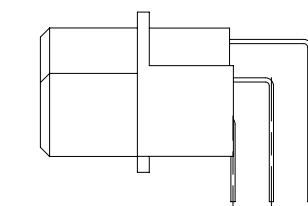

SR1
WITHOUT OPTIONAL
RETENTION CLIPS

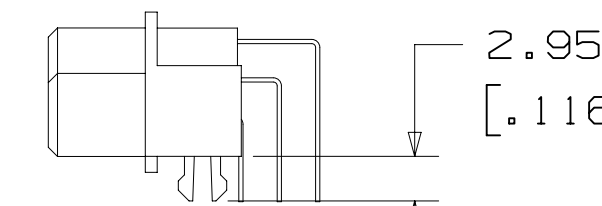

RR1L
WITH "B" OPTIONAL RETENTION
CLIPS FOR .062 PCB THICKNESS

DESIGN REFERENCE	NEXT ASSEMBLY	REV	ECO	ISSUE DATE AND DESCRIPTION	DRFT	CHKD
				FEB 20,2017		
DIVISION	DIVISION CODE	DATE		DATE		
	EMSD	FEB 20,2017		FEB 20,2017		
DO NOT SCALE DRAWING	SCALE 2/1	TOLERANCES EXCEPT AS NOTED		INCHES		
THIRD ANGLE PROJECTION		MILLIMETERS		ANGLES		
INTERPRET PER ASME Y14.5 - 2009		MAX SURFACE ROUGHNESS		MARKED ONLY		
CAGE NUMBER		SIZE	DRAWING NO.	REV.		
D78-5100-2670-7			A	SHT 3 OF 4		

3M™ DIN C-FORM & R-FORM SOCKET, DIN 41612 SERIES

VERTICAL, RIGHT ANGLE, SOLDER TAIL OR PRESS-FIT TERMINATION

Technical Information: The technical information, recommendations and other statements contained in this document are based upon tests or experience that 3M believes are reliable, but the accuracy or completeness of such information is not guaranteed.

Product Use: Many factors beyond 3M's control and uniquely within user's knowledge and control can affect the use and performance of a 3M product in a particular application. Given the variety of factors that can affect the use and performance of a 3M product, user is solely responsible for evaluating the 3M product and determining whether it is fit for a particular purpose and suitable for user's method of application.

Warranty, Limited Remedy, and Disclaimer: Unless an additional warranty is specifically stated on the applicable 3M product packaging or product literature, 3M warrants that each 3M product meets the applicable 3M product specification at the time 3M ships the product. 3M MAKES NO OTHER WARRANTIES OR CONDITIONS, EXPRESS OR IMPLIED, INCLUDING, BUT NOT LIMITED TO, ANY IMPLIED WARRANTY OR CONDITION OF MERCHANTABILITY OR FITNESS FOR A PARTICULAR PURPOSE OR ANY IMPLIED WARRANTY OR CONDITION ARISING OUT OF A COURSE OF DEALING, CUSTOM OR USAGE OF TRADE. If the 3M product does not conform to this warranty, then the sole and exclusive remedy is, at 3M's option, replacement of the 3M product or refund of the purchase price.

Limitation of Liability: Except where prohibited by law, 3M will not be liable for any loss or damage arising from the 3M product, whether direct, indirect, special, incidental or consequential, regardless of the legal theory asserted, including warranty, contract, negligence or strict liability.

DESIGN REFERENCE		NEXT ASSEMBLY		REV	ECO	ISSUE DATE AND DESCRIPTION		DRFT	CHKD
						FEB 24, 2017 PRODUCTION RELEASE		JNC	WL
APPROVED		DATE		MFG		DATE			
CASTIGLIONE		FEB 20, 2017				FEB 20, 2017			
CHKD		DATE		APPRV		DATE			
				W. LEE		FEB 20, 2017			
DIVISION		DIVISION CODE		 © 3M COPYRIGHT 2017 This document and the information it contains are 3M property and may not be reproduced or further distributed without 3M permission, or used or disclosed other than for 3M authorized purposes. All rights reserved.					
DO NOT SCALE DRAWING		SCALE $\frac{2}{1}$		TOLERANCES EXCEPT AS NOTED INCHES .00 ± .000 ± .0000 ± MILLIMETERS 0 ± .00 ± .000 ± .000 ±					
THIRD ANGLE PROJECTION		INTERPRET PER ASME Y14.5 - 2009		CAGE NUMBER D 78-5100-2670-7 MODEL DET. <input type="checkbox"/> YES <input checked="" type="checkbox"/> NO SHT 4 OF 4					
MAX SURFACE ROUGHNESS		SURFACES							
<input checked="" type="checkbox"/> MARKED ONLY		ANGLES							

78-5100-2670-7
 DRAWING NUMBER
 A REVISION
 A.2 2/24/2017 10:32 AM UTC-06:00