

# SMT PC Board Sockets

- ❖ Accepts pins between 0.8mm and 1.8mm diameter.
- ❖ SMT product is pick and place-able using standard assembly machines.
- ❖ Rated to 5 Amps and 9 Amps electrical current.
- ❖ Greatly reduces process costs by removing the need for secondary operations.
- ❖ Reduced component costs.

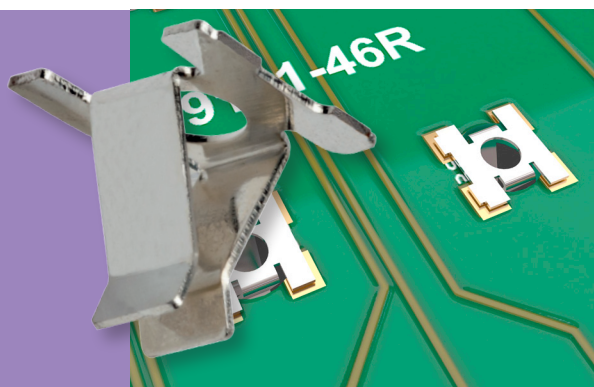

## 0.8mm TO 1.5mm MATING PIN

### ❖ Electrical

Current Rating: 5A max.

### ❖ Packaging

Format: Tape & Reel

Reel quantity: 900 on a Ø330mm reel

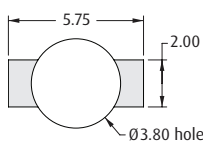
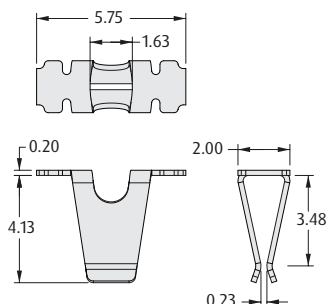

Recommended PC Board Pattern

### Orientation of SMT Socket in PCB

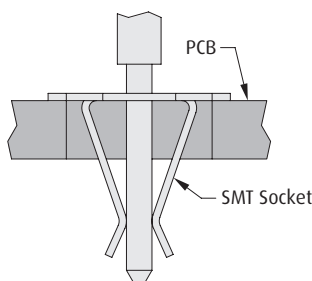

## 1.1mm TO 1.8mm MATING PIN

### ❖ Electrical

Current Rating: 9A max.

### ❖ Packaging

Format: Tape & Reel

Reel quantity: 800 on a Ø330mm reel

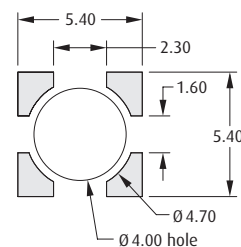
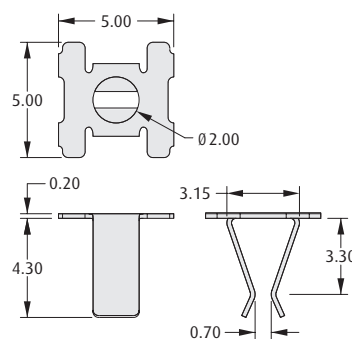

Recommended PC Board Pattern

## HOW TO ORDER

**S9XX1 - 46 R**

### SERIES CODE

<b>S9091</b>	0.8 to 1.5mm Mating pin
<b>S9101</b>	1.1 to 1.8mm Mating pin

### PACKAGING

<b>R</b>	Tape & Reeled
----------	---------------

### FINISH

<b>46</b>	Tin
-----------	-----

All dimensions in mm.