

Jun.1.2019 Copyright 2019 HIROSE ELECTRIC CO., LTD. All Rights Reserved.  
In case of consideration for using Automotive equipment / device which demand high reliability, kindly contact our sales window correspondents.

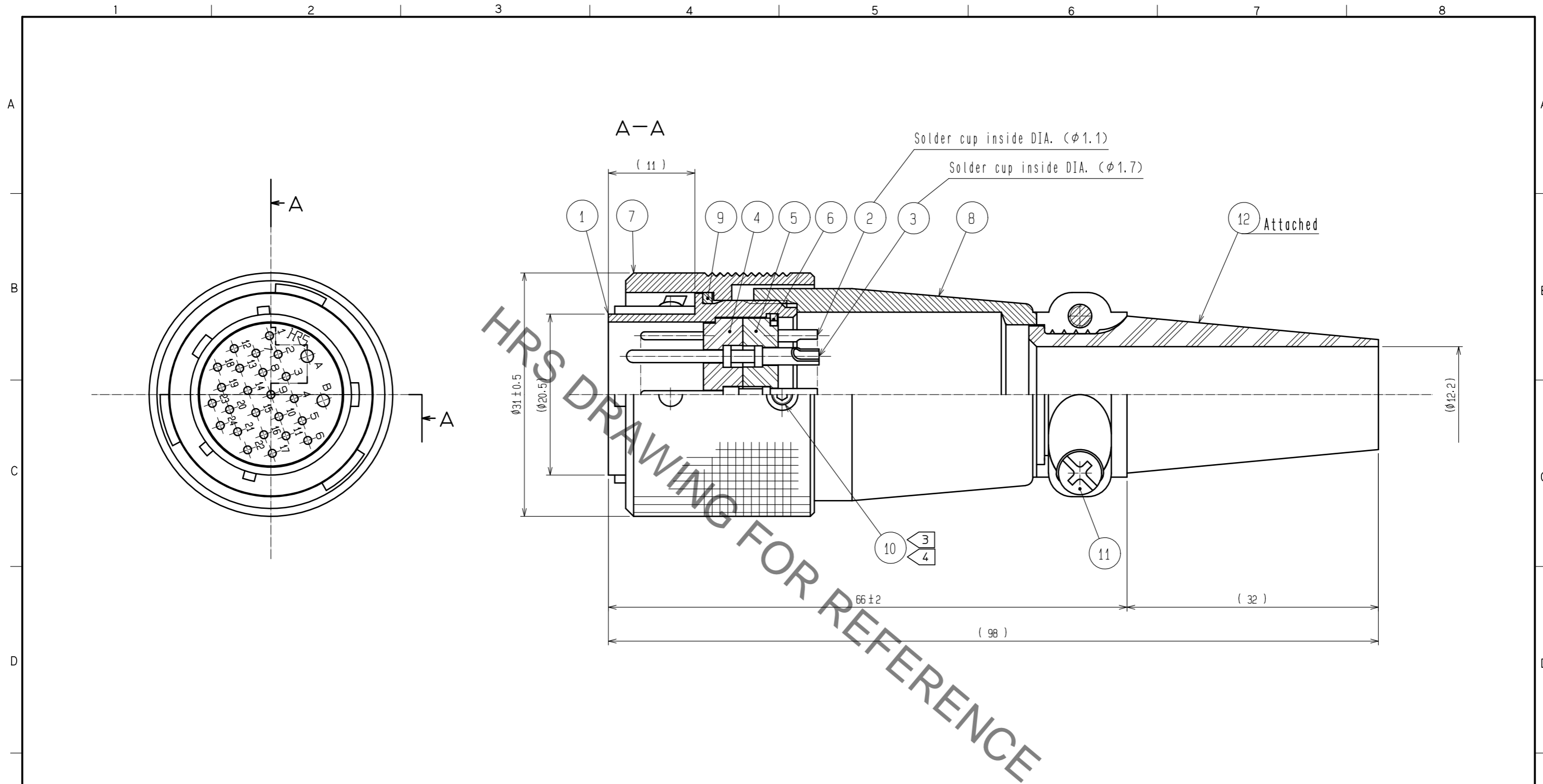

- Notes
- 1 Rotation examples of REF. No. ① and ⑥ are shown.
  - 2 An example of solder cup direction REF. No. ② and ③ is shown.
  - ③ The recommended clamp torque of REF. No. ⑩ : 0.2 to 0.3 N · m.
  - ④ Across flats of hexagon hole of REF. No. ⑩ to be 1.27.

6	Phosphor bronze	Nickel plating	12	Chloprene rubber	(Black)
5	Phenol-formal dehyde	(Black) UL94V-0	11	Brass	Nickel plating JIS B 1111 Pan head machine screw M3X0.5X8
4	Phenol-formal dehyde	(Black) UL94V-0	10	Steel	Nickel plating JIS B 1177 Hexagon socket set screw M2.6X0.45X2
3	Copper alloy	Silver plating 2µm min.	9	Polyacetal	(White)
2	Copper alloy	Silver plating 2µm min.	8	Aluminum alloy	Matte finish nickel plated
1	Aluminum alloy	Matte finish nickel plated	7	Brass	Matte finish nickel plated
NO.	MATERIAL	FINISH . REMARKS	NO.	MATERIAL	FINISH . REMARKS

UNITS mm			SCALE 2 : 1	COUNT 	DESCRIPTION OF REVISIONS	DESIGNED	CHECKED	DATE
<b>HRS</b> HIROSE ELECTRIC CO., LTD.		APPROVED : HY. KOBAYASHI	18.03.13	DRAWING NO.	EDC-020921-31-00			
		CHECKED : HY. KOBAYASHI	18.03.13	PART NO.	JRC21BPA-26P(31)			
		DESIGNED : TH. KAMEYA	18.03.13	CODE NO.	CL114-0268-4-31			
		DRAWN : TH. KAMEYA	18.03.13					