

## TYPE YAE-G BOX

INSULUG™

TERMINAL -  
 NYLON INSULATED,  
 RING-TONGUE  
 MULTI-FINGER  
 INSULATION GRIP

300 VOLTS MAX. 105° C MAX.

INSULUG™ Type YAE-N nylon insulated terminals are designed with a multi-finger insulation grip for paper, EPR and other elastic or hard to grip insulations. The metal fingers firmly grip the insulation providing superior holding characteristics, cable support and strain relief. Type YAE-N terminals are rated 105°C and meet military standard MS25036 class 2 and MIL-T-7928 (ASG) requirements.

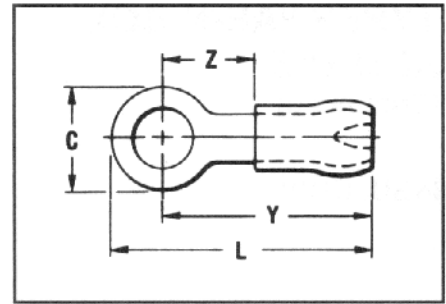
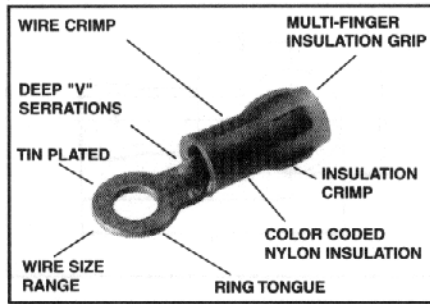

B-9

### Features and Benefits

- Multi-finger insulation grip.
  - ◇ Provides superior insulation holding characteristics, especially on EPR and other elastic-type insulations.
- Brazed seam.
  - ◇ Provides stronger more durable termination.
- Manufactured of pure electrolytic copper.
  - ◇ Provides maximum conductivity, low resistance and ductility for excellent crimp forming properties.
- Deep V groove, inner barrel serrations.
  - ◇ Provide optimum conductivity, reliability, and holding power.
- Smooth funnel entry.
  - ◇ Easy wire insertion.



CATALOG NUMBER	WIRE RANGE	STUD SIZE	MIL. STD.**	DIMENSIONS				BULK CATALOG NUMBER*	INSTALLATION TOOLING	TAPE MOUNTED CATALOG NO. 2000/Reel	INSTALLATION TOOLING	WIRE STRIP LENGTH
				C	L MAX.	Y MAX.	Z MAX.					
YAE22G18 BOX•	26-20	1.2	-148	.15	.70	.62	.22	YAE22G18•	M8ND with N14HET-25V1 Die	YAE22G18M• YAE22G12M• YAE22G16M• YAE22G13M• YAE22G14M• YAE22G15M•	TFM with DFM11D1 Die	5/32"
YAE22G12 BOX•	Max. Insul.	1.2	-	.25	.75	.62	.22	YAE22G12•				
YAE22G16 BOX•	Dia. Accom.:	3.4	-144	.18	.75	.62	.22	YAE22G16•				
YAE22G13 BOX•	.098	4-6	-145	.25	.75	.62	.22	YAE22G13•				
YAE22G14 BOX•	Color Code:	6-8	-146	.32	.83	.67	.27	YAE22G14•				
YAE22G15 BOX•	Amber	8-10	-147	.32	.83	.67	.27	YAE22G15•				

• Not UL recognized  
 \* 1000/Reel  
 \*\* Class 2

### TYPES YAE-N BOX AND YAE (Continued)

INSULUG™

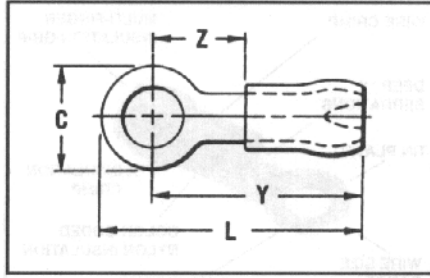

B-10

CATALOG NUMBER	WIRE RANGE	STUD SIZE	MIL STD.**	DIMENSIONS				BULK CATALOG NUMBER	INSTALLATION TOOLING	TAPE MOUNTED CATALOG NO. 2000/REEL	INSTALLATION TOOLING	WIRE STRIP LENGTH
				C	L MAX.	Y MAX.	Z MIN.					
YAE18N29 BOX	22-16 † Max. Insul. Dia. Accom.: .125 Color Code: Red	1-2	—	.14	.75	.68	.19	YAE18N29	MR8-33T-1 (no extra dies required) M8ND with one of following dies: N14HET-25V1 N10ET-9 N14HET-15  or Y10D Y10-22	YAE18N29M	TFM with DFM10D1 die	3/16"
YAE18N27 BOX		2	—	.19	.77	.66	.19	YAE18N27		YAE18N27M		
YAE18N7 BOX		4	—	.25	.80	.68	.19	YAE18-N7		YAE18-N7M		
YAE18N17 BOX		4	-148	.25	.80	.68	.19	YAE18N17		YAE18N17M		
YAE18N26 BOX		4	—	.23	.78	.68	.19	YAE18N26		YAE18N26M		
YAE18N21 BOX		4-6	-102	.25	.89	.77	.28	YAE18N21		YAE18N21M		
YAE18N25 BOX		4-6	—	.22	.79	.68	.19	YAE18N25		YAE18N25M		
YAE18G43 BOX		4-6	—	.25	.90	.68	.19	YAE18G43		YAE18G43M		
YAE18N24 BOX		6-8	—	.28	.92	.77	.28	YAE18N24		YAE18N24M		
YAE18N1 BOX		6-8	-149	.31	.92	.77	.28	YAE18N1		YAE18N1M		
YAE18N BOX	8-10	-103	.31	.92	.77	.28	YAE18N	YAE18NM				
YAE18N2 BOX		12, 1/4	-150	.45	1.11	.88	.40	YAE18N2	YAE18N2M			
YAE18N3 BOX		5/16	-104	.45	1.11	.88	.40	YAE18N3	YAE18N3M			
YAE14N43 BOX	16-14	4-6	-106	.25	.82	.69	.20	YAE14N43	YAE14N43M	TFM with DFM9D1 die	3/16"	
YAE14N1 BOX	Max. Insul.	6-8	-153	.31	.92	.75	.28	YAE14N1	YAE14N1M			
YAE14N BOX	Dia.	8-10	-108	.31	.92	.75	.28	YAE14N	YAE14NM			
YAE14N2 BOX	Accom.: .156	1/4	-154	.45	1.11	.88	.40	YAE14N2	YAE14N2M			
YAE14N3 BOX	Color Code:	5/16	-109	.45	1.11	.88	.40	YAE14N3	YAE14N3M			
YAE14N4 BOX	Blue	3/8	-110	.53	1.19	.93	.44	YAE14N4	YAE14N4M			
YAE12N7 BOX	14-12	10	—	.31	1.06	.93	.29	YAE12N7	YAE12N7M	TFM with DFM7D1 die	21/64"	
YAE12N9 BOX	Max. Insul.	6-8	—	.31	1.06	.90	.28	YAE12N9	YAE12N9M			
YAE12N1 BOX	Dia.	6-8	—	.31	1.06	.90	.28	YAE12N1	YAE12N1M			
YAE12N BOX	Accom.: .180	8-10	—	.31	1.06	.90	.28	YAE12N	YAE12NM			
YAE12N2 BOX	Color Code: Green	1/4	—	.46	1.25	1.02	.40	YAE12N2	YAE12N2M			
YAE10N5 BOX		4-6	-111	.38	1.15	.96	.28	YAE10N5	* YAE10N5M			
YAE10N11 BOX	12-10	6-8	-156	.38	1.17	.98	.30	YAE10N11	* YAE10N11M	TFM with DFM7D1 die	3/8"	
YAE10N BOX	Max. Insul. Dia.	8-10	-112	.38	1.15	.96	.28	YAE10N	* YAE10NM			
YAE10N3 BOX	Accom.: .209	1/4	-157	.54	1.39	1.12	.44	YAE10N3	* YAE10N3M			
YAE10N2	Color Code: Yellow	5/16	-113	.54	1.39	1.12	.44	YAE10N2	* YAE10N2M			
YAE10N4		3/8	-114	.54	1.39	1.12	.44	YAE10N4	* YAE10N4M			

\* 1000/Reel

\*\* Class 2

† Use Y10D or Y10-22 only when crimping #16 AWG.