

PRODUCT NUMBER

71600-YXXLF

LEAD FREE, SEE NOTE 6

TOTAL NB OF POSITION 04 TO 64
SEE SHEET 2

OPTIONAL STRAIN RELIEF
SEE SHEET 2

TRIANGLE INDICATES
POSITION 1
NOTE 5

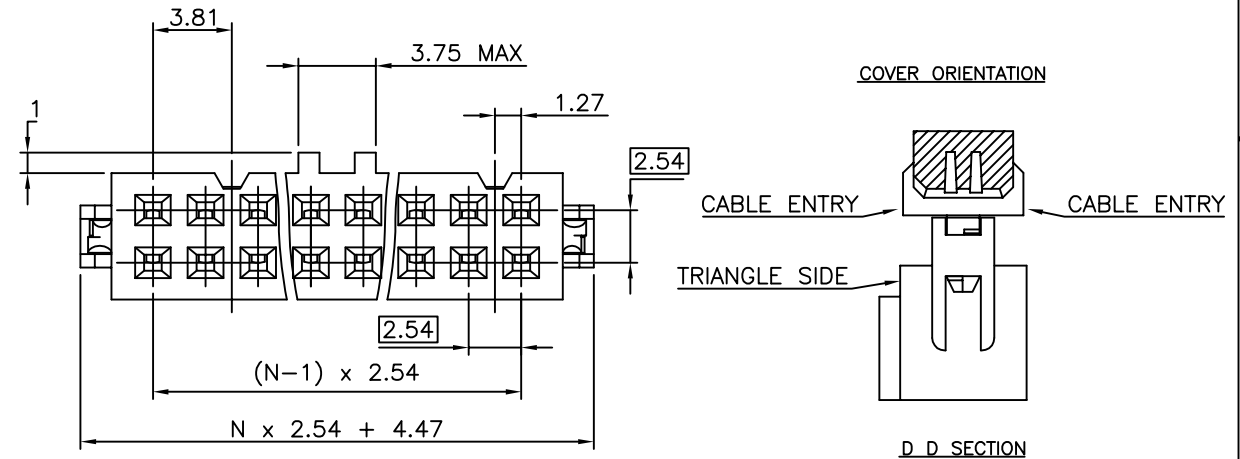
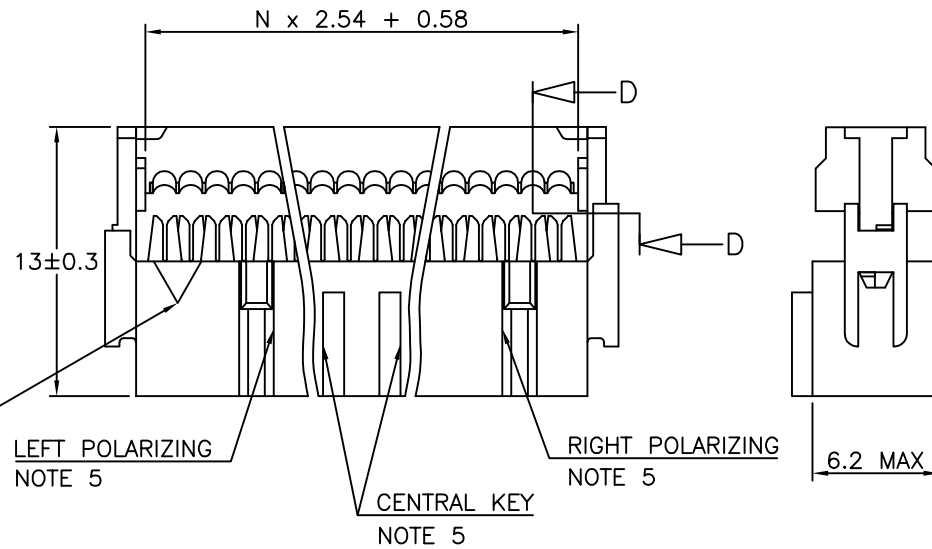

NOTES:

- 1 - PLASTIC MAT'L : GLASS FILLED HIGH TEMPERATURE THERMOPLASTIC. UL94V-0 COLOR: GREY
- 2 - PIN MATERIAL : PHOSPHOR BRONZE
- 3 - PRODUCT PACKAGED IN TUBES.
- 4 - TO DETERMINE DIMENSIONS :
N = NUMBER OF POSITIONS PER ROW
EXAMPLE : 8 POS N x 2.54 = 20.32mm
- 5 - 2x5, 2x6, 2x7 HAVE NO LEFT POLARIZING SLOT.
- 2x2, 2x3 WITH CENTRAL KEY HAVE NO TRIANGLE, NO LEFT AND RIGHT POLARIZING SLOT.
- 2x2 WITHOUT CENTRAL KEY HAS NO LEFT AND RIGHT POLARIZING SLOT.
- 2x3, 2x4 WITHOUT CENTRAL KEY HAVE NO LEFT POLARIZING SLOT
- 2x4 WITH CENTRAL KEY HAVE NO LEFT AND RIGHT POLARIZING SLOT
- 6 - THIS PRODUCT MEETS EUROPEAN UNION DIRECTIVES AND OTHER COUNTRY REGULATIONS AS PER GS-22-008.
PACKAGING SPECIFICATION AS PER GS-14-920.

mat'l. code SEE NOTES		surface ISO 1302	tolerance ISO 406 ISO 1101	projection	product family 2.54MM IDC	
ltr	ecn no	dr	date	tolerances unless otherwise specified	title	
AP	F12-0046	LMU	12.04.25	angles	QUICKIE III FEM 0.76µm Au	
AR	B-17851	LMU	14.06.05	linear		
				X.X ±0.3	scale 5:1	
				X.XX ±0.13		
				X.XXX ±0.05		
AK	F05-0180	LMU	05.04.22	dr	D.LE	01.01.24
AL	F06-0270	LMU	06.09.12	engr	P.NZ	01.01.24
AM	F06-0274	LMU	06.09.25	chr	JF.N	01.01.24
AN	F09-0233	LMU	09.12.15	appd	P.NZ	01.01.24
sheet	revision	AR	AF			
index	sheet	1	2			

FCJ
type CUSTOMER Drawing
sheet 1 of 2
71600
A3

STRAIN RELIEF OPTION AVAILABILITY	Nbr OF POSITIONS
1/6	04
0/1/2/3/6	06
0/1/2/3/6	08
0/1/2/3/6	10
0/1/2/3/6	14
0/1/2/3/6	16
0/1/2/3/6	18
0/1/2/3/6	20
0/1/3	24
0/1/2/3/6	26
0/1/2/3/6	30
0/1/2/3/6	34
0/1/2/3/6	40
0/1/2/3/6	50
0/1/2/3/6	60
0/1/2/3/6	64

624
304
204 / 224
004
DASHES NOT AVAILABLE

PLATING
0.76µm GOLD ON CONTACT AREA
1.27 µm Ni REMAINDER OF PRODUCT

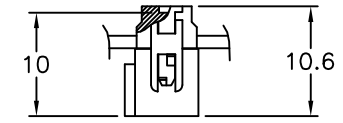

WITHOUT STRAIN RELIEF

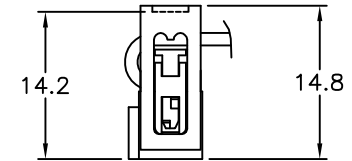

WITH LOW PROFILE STRAIN RELIEF

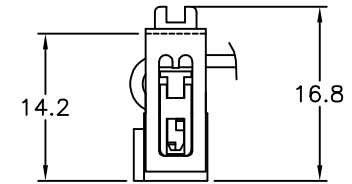

WITH STANDARD STRAIN RELIEF

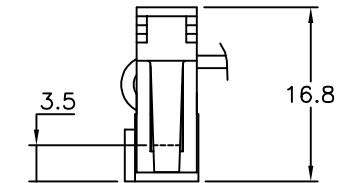

WITH LATCHING STRAIN RELIEF

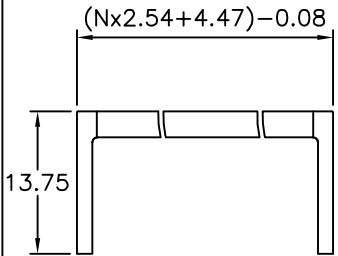

LOW PROFILE STRAIN RELIEF

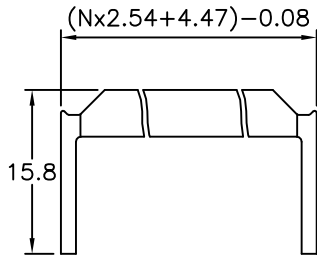

STANDARD STRAIN RELIEF

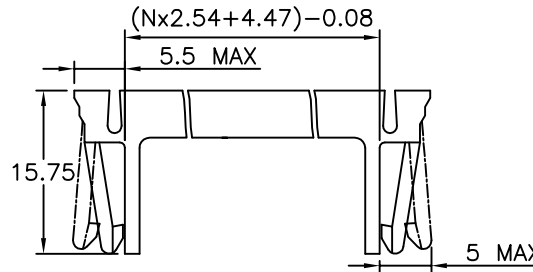

LATCHING STRAIN RELIEF FOR SLIM HEADER

PRODUCT NUMBER	WITH CENTRAL KEY	WITHOUT CENTRAL KEY	STANDARD STRAIN RELIEF	WITHOUT STRAIN RELIEF	LOW PROFILE STRAIN RELIEF	LATCHING STRAIN RELIEF
71600-6YYLF	●					●
71600-3YYLF		●	●			
71600-2YYLF	●				●	
71600-1YYLF	●			●		
71600-0YYLF	●		●			

mat'l. code		surface ISO 1302		tolerance ISO 406 ISO 1101		projection		product family QUICKIE	
ltr	ecn no	dr	date	tolerances unless otherwise specified		mm		title	
AF	B-17851	LMU	14.06.05	angles	linear	mm		IDC RECEPT DR	
AA	F10199	GCO	01.04.26			scale N/A		sheet 2 of - size	
AB	F03019	DLE	03.01.23	dr	D.LE	01.01.24		71600 A3	
AC	F05-0180	LMU	05.04.22	engr	P.NZ	01.01.24		type CUSTOMER Drawing	
AD	F06-0270	LMU	06.09.12	chr	JF.N	01.01.24			
AE	F06-0274	LMU	06.09.25	appd	P.NZ	01.01.24			
sheet index	revision sheet								

Copyright FCJ
 FCconnect.com