

TMC with straight dip-solder termination

Dimensional drawings

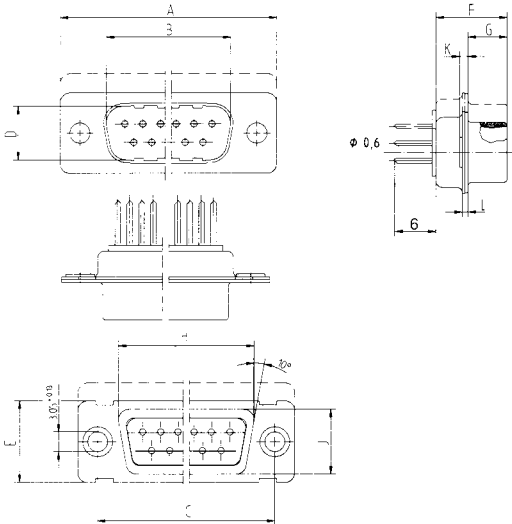

Male connector

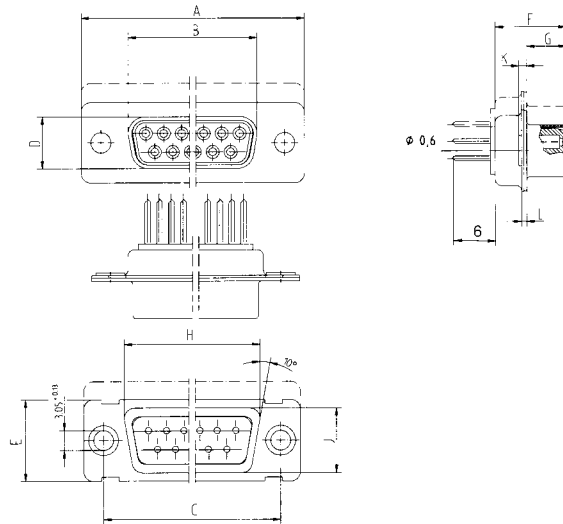

Female connector



Dimensional drawings

	Male connector					Female connector				
	TMC-P-....TL <i>Performance Level 207</i> 					TMC-S-....TL <i>Performance Level 207</i> 				
Number of pins	09	15	25	37	50	09	15	25	37	50
Standard	<i>Standard version</i> 023132 023133 023019 023134 023135*					<i>Standard version</i> 003552 003553 003554 003555 013920				

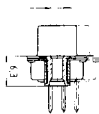
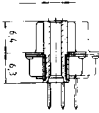
Riveted nut and sleeve 	<i>Version with riveted nut and sleeve M3 as accessories</i> 023136 023137 023138 023139 023140*	<i>Version with riveted nut and sleeve M3 as accessories</i> 003634 013052 003625 013702 013897
	<i>Version with riveted nut and sleeve 4/40 as accessories</i> 023141 023142 023143 023144 023145*	<i>Version with riveted nut and sleeve 4/40 as accessories</i> 003633 013551 003626 013701 013898
Threaded bolt and sleeve 	<i>Version with threaded bolt and sleeve M3 as accessories</i> 023146 023147 023148 023149 023150*	<i>Version with threaded bolt and sleeve M3 as accessories</i> 003635 013550 003628 013700 013892
	<i>Version with threaded bolt and sleeve 4/40 as accessories</i> 023151 023152 023153 023154 023155*	<i>Version with threaded bolt and sleeve 4/40 as accessories</i> 003636 013549 003627 013699 013893

	Male connectors					Female connectors				
	TMC-P-....TL <i>Performance Level 207</i>					TMC-S-....TL <i>Performance Level 207</i>				
Number of pins	09	15	25	37	50	09	15	25	37	50
Threaded bolt and sleeve	Version with threaded bolt 4/40 and sleeve M3 as accessories 023156 023157 023158 023159 023160*					Version with threaded bolt 4/40 and sleeve M3 as accessories 013032 013033 013029 013034 003641				

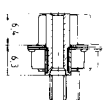

Assembly details

TMC with straight dip-solder termination

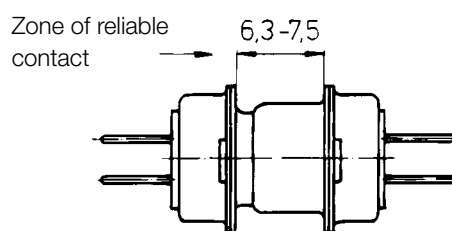
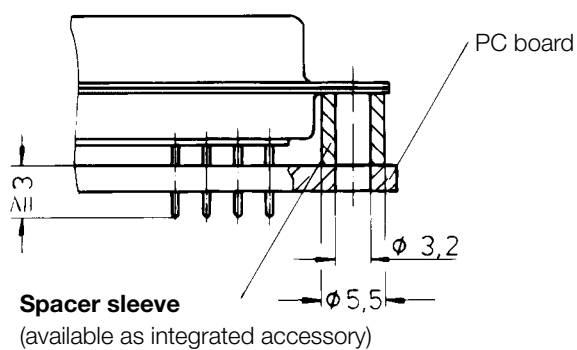

PC board hole patterns

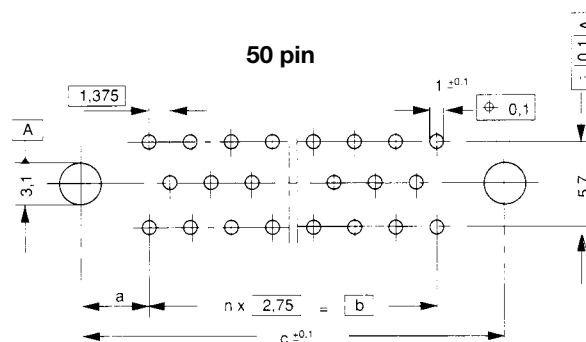
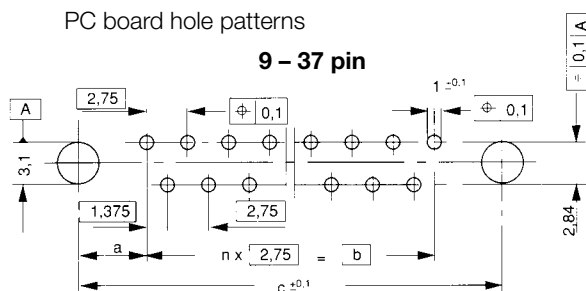

Number of pins	a	b	c	n
9	7	11	25	4
15	7,025	19,25	33,3	7
25	7	33	47	12
37	7	49,5	63,5	18
50	8,55	44	61,1	16