

EAO – Your Expert Partner for Human Machine Interfaces

82-6152.22A4 - Illuminated pushbutton 22 mm stainless-steel, maintain

82-6152.22A4 - Illuminated pushbutton 22 mm stainless-steel, maintain



Attention: The preview is based on a sample product. This can differ from your current configuration.

Mounting

Design	flush
Mounting cut-out	Ø 22,3 mm

Front

Front shape	round
Front ring shape	flush
Front dimension	Ø 25 mm
Front bezel material	Stainless steel

Other Attributes

Operating voltage	24 V VDC
Weight	0,018 kg
Operation current	7 mA

Operating-/Indication part

Lens optics	opaque
Lens material	Stainless steel
Lens profile	flat
Lens illumination	illuminative
Lens colour	Stainless steel

IP-Rating

Front protection	IP65, IP67
------------------	------------

Connection Method

Terminal	Screw terminal
----------	----------------

Actuator

Switching action	Maintained
------------------	------------

Switching element

Switching current	3 A
Contact material	Silver
Contacts	1 C
Switching system	Snap-action switching element
Switching voltage	240 V VAC/DC

Illumination

Illumination	Dot with LED bi-colour red/green
--------------	----------------------------------

Function

Illuminated pushbutton

EAO – Your Expert Partner for Human Machine Interfaces

82-6152.22A4 - Illuminated pushbutton 22 mm stainless-steel, maintain

Dimensions

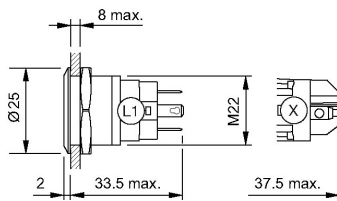

Mounting cut-outs

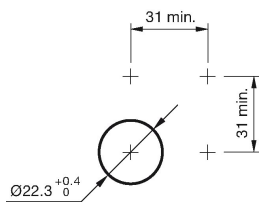

Wiring diagram

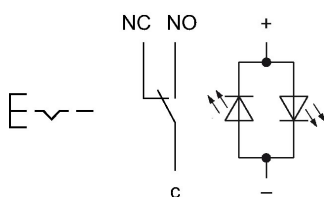

Component layout

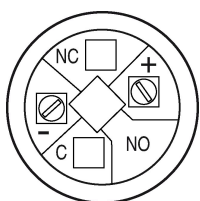

Legend

Switching action: C = Maintained

Contacts: C = Changeover