

2N5050
2N5051
2N5052

**SILICON
NPN POWER TRANSISTORS**



TO-66 CASE



www.centralemi.com

DESCRIPTION:

The CENTRAL SEMICONDUCTOR 2N5050, 2N5051, and 2N5052 are silicon NPN transistors designed for general purpose amplifier and switching applications.

MARKING: FULL PART NUMBER

MAXIMUM RATINGS: ($T_C=25^{\circ}\text{C}$)

Collector-Base Voltage
Collector-Emitter Voltage
Emitter-Base Voltage
Continuous Collector Current
Continuous Base Current
Power Dissipation
Operating Junction Temperature
Storage Temperature
Thermal Resistance

SYMBOL	2N5050	2N5051	2N5052	UNITS
V_{CBO}	125	150	200	V
V_{CEO}	125	150	200	V
V_{EBO}		6.0		V
I_C		2.0		A
I_B		1.0		A
P_D		40		W
T_J		-65 to +175		$^{\circ}\text{C}$
T_{stg}		-65 to +200		$^{\circ}\text{C}$
Θ_{JC}		3.76		$^{\circ}\text{C/W}$

ELECTRICAL CHARACTERISTICS: ($T_C=25^{\circ}\text{C}$ unless otherwise noted)

SYMBOL	TEST CONDITIONS	MIN	MAX	UNITS
I_{CEX}	$V_{CE}=\text{Rated } V_{CEO}, V_{BE(off)}=1.5\text{V}$		0.5	mA
I_{CEX}	$V_{CE}=\text{Rated } V_{CEO}, V_{BE(off)}=1.5\text{V}, T_C=150^{\circ}\text{C}$		5.0	mA
I_{CEO}	$V_{CE}=62.5\text{V}$ (2N5050)		0.1	mA
I_{CEO}	$V_{CE}=75\text{V}$ (2N5051)		0.1	mA
I_{CEO}	$V_{CE}=100\text{V}$ (2N5052)		0.1	mA
I_{EBO}	$V_{EB}=6.0\text{V}$		0.1	mA
BV_{CEO}	$I_C=200\text{mA}$ (2N5050)	125		V
BV_{CEO}	$I_C=200\text{mA}$ (2N5051)	150		V
BV_{CEO}	$I_C=200\text{mA}$ (2N5052)	200		V
$V_{CE(SAT)}$	$I_C=0.75\text{A}, I_B=0.1\text{A}$		1.0	V
$V_{CE(SAT)}$	$I_C=2.0\text{A}, I_B=0.4\text{A}$		5.0	V
$V_{BE(ON)}$	$V_{CE}=5.0\text{V}, I_C=0.75\text{A}$		1.2	V
h_{FE}	$V_{CE}=5.0\text{V}, I_C=0.75\text{A}$	25	100	
h_{FE}	$V_{CE}=5.0\text{V}, I_C=1.0\text{A}$	25		
h_{FE}	$V_{CE}=5.0\text{V}, I_C=2.0\text{A}$	5.0		
h_{fe}	$V_{CE}=10\text{V}, I_C=250\text{mA}, f=1.0\text{kHz}$	25		
f_T	$V_{CE}=10\text{V}, I_C=250\text{mA}, f=5.0\text{MHz}$	10		MHz

R0 (15-January 2019)

2N5050
2N5051
2N5052

SILICON
NPN POWER TRANSISTORS



ELECTRICAL CHARACTERISTICS - Continued: (T_C=25°C unless otherwise noted)

SYMBOL	TEST CONDITIONS	MIN	MAX	UNITS
C _{ob}	V _{CB} =10V, I _E =0, f=100kHz		250	pF
t _r	<div> V_{CC}=120V, I_C=750mA, I_{B1}=I_{B2}=100mA, R_L=150Ω </div>		300	ns
t _s			3.5	μs
t _f			1.2	μs

TO-66 CASE - MECHANICAL OUTLINE

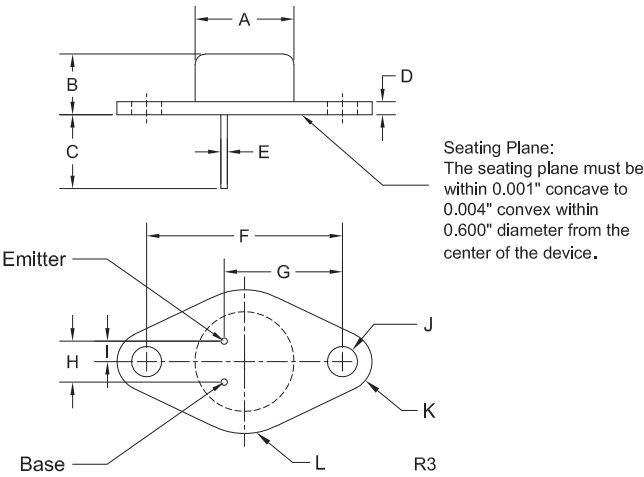

SYMBOL	INCHES		MILLIMETERS	
	MIN	MAX	MIN	MAX
A (DIA)	0.470	0.500	11.94	12.70
B	0.250	0.340	6.35	8.64
C	0.360	-	9.14	-
D	0.050	0.075	1.27	1.91
E (DIA)	0.028	0.034	0.71	0.86
F	0.956	0.964	24.28	24.48
G	0.570	0.590	14.48	14.99
H	0.190	0.210	4.83	5.33
I	0.093	0.107	2.36	2.72
J (DIA)	0.142	0.152	3.61	3.86
K (RAD)	0.141		3.58	
L (RAD)	0.345		8.76	

TO-66 (REV:R3)

MARKING:
FULL PART NUMBER

R0 (15-January 2019)

OUTSTANDING SUPPORT AND SUPERIOR SERVICES



PRODUCT SUPPORT

Central's operations team provides the highest level of support to insure product is delivered on-time.

- Supply management (Customer portals)
- Inventory bonding
- Consolidated shipping options
- Custom bar coding for shipments
- Custom product packing

DESIGNER SUPPORT/SERVICES

Central's applications engineering team is ready to discuss your design challenges. Just ask.

- Free quick ship samples (2nd day air)
- Online technical data and parametric search
- SPICE models
- Custom electrical curves
- Environmental regulation compliance
- Customer specific screening
- Up-screening capabilities
- Special wafer diffusions
- PbSn plating options
- Package details
- Application notes
- Application and design sample kits
- Custom product and package development

REQUESTING PRODUCT PLATING

1. If requesting Tin/Lead plated devices, add the suffix " TIN/LEAD" to the part number when ordering (example: 2N2222A TIN/LEAD).
2. If requesting Lead (Pb) Free plated devices, add the suffix " PBFREE" to the part number when ordering (example: 2N2222A PBFREE).

CONTACT US

Corporate Headquarters & Customer Support Team

Central Semiconductor Corp.
145 Adams Avenue
Hauppauge, NY 11788 USA
Main Tel: (631) 435-1110
Main Fax: (631) 435-1824
Support Team Fax: (631) 435-3388
www.centrasemi.com

Worldwide Field Representatives:
www.centrasemi.com/wwreps

Worldwide Distributors:
www.centrasemi.com/wwdistributors

For the latest version of Central Semiconductor's **LIMITATIONS AND DAMAGES DISCLAIMER**, which is part of Central's Standard Terms and Conditions of sale, visit: www.centrasemi.com/terms