



# Shielded Power Inductors – MSS5131



- 5.1 × 5.1 mm footprint; 3.1mm high shielded inductors
- Low DCR and excellent current handling

**Designer's Kit C362** contains 3 of each value

**Core material** Ferrite

**Core and winding loss** See [www.coilcraft.com/coreloss](http://www.coilcraft.com/coreloss)

**Terminations** RoHS compliant matte tin over nickel over phos bronze (current production) or gold over nickel over phos bronze (prior production). Other terminations available at additional cost.

**Weight** 0.20 – 0.24 g

**Ambient temperature** –40°C to +85°C with (40°C rise) Irms current.

**Maximum part temperature** +125°C (ambient + temp rise). **Derating.**

**Storage temperature** Component: –40°C to +125°C.

Tape and reel packaging: –40°C to +80°C

**Resistance to soldering heat** Max three 40 second reflows at +260°C, parts cooled to room temperature between cycles

**Moisture Sensitivity Level (MSL)** 1 (unlimited floor life at <30°C / 85% relative humidity)

**Failures in Time (FIT) / Mean Time Between Failures (MTBF)**

38 per billion hours / 26,315,789 hours, calculated per Telcordia SR-332

**Packaging** 600/7" reel, 2500/13" reel; Plastic tape: 12 mm wide, 0.35 mm thick, 8 mm pocket spacing, 3.25 mm pocket depth

**PCB washing** Tested to MIL-STD-202 Method 215 plus an additional aqueous wash. See [Doc787\\_PCB\\_Washing.pdf](#).

| Part number <sup>1</sup> | Inductance <sup>2</sup><br>±20% (µH) | DCR<br>max<br>(Ohms) | SRF<br>typ <sup>3</sup><br>(MHz) | Isat (A) <sup>4</sup> |             |             | Irms (A) <sup>5</sup> |              |
|--------------------------|--------------------------------------|----------------------|----------------------------------|-----------------------|-------------|-------------|-----------------------|--------------|
|                          |                                      |                      |                                  | 10%<br>drop           | 20%<br>drop | 30%<br>drop | 20°C<br>rise          | 40°C<br>rise |
| MSS5131-222ML_           | 2.2                                  | 0.020                | 65.0                             | 1.76                  | 2.08        | 2.30        | 2.00                  | 3.30         |
| MSS5131-332ML_           | 3.3                                  | 0.028                | 60.0                             | 1.33                  | 1.58        | 1.73        | 1.60                  | 2.90         |
| MSS5131-472ML_           | 4.7                                  | 0.038                | 48.0                             | 1.08                  | 1.32        | 1.42        | 1.40                  | 2.50         |
| MSS5131-562ML_           | 5.6                                  | 0.042                | 44.0                             | 1.00                  | 1.20        | 1.30        | 1.30                  | 2.30         |
| MSS5131-682ML_           | 6.8                                  | 0.050                | 42.0                             | 0.98                  | 1.14        | 1.24        | 1.20                  | 2.16         |
| MSS5131-822ML_           | 8.2                                  | 0.058                | 40.0                             | 0.90                  | 1.04        | 1.18        | 1.10                  | 2.00         |
| MSS5131-103ML_           | 10                                   | 0.070                | 38.0                             | 0.85                  | 0.98        | 1.13        | 1.00                  | 1.90         |
| MSS5131-123ML_           | 12                                   | 0.080                | 35.0                             | 0.72                  | 0.85        | 0.94        | 0.97                  | 1.60         |
| MSS5131-153ML_           | 15                                   | 0.100                | 32.0                             | 0.67                  | 0.78        | 0.86        | 0.94                  | 1.50         |
| MSS5131-183ML_           | 18                                   | 0.120                | 26.0                             | 0.61                  | 0.72        | 0.79        | 0.89                  | 1.40         |
| MSS5131-223ML_           | 22                                   | 0.145                | 22.0                             | 0.54                  | 0.64        | 0.70        | 0.87                  | 1.30         |
| MSS5131-273ML_           | 27                                   | 0.161                | 19.0                             | 0.48                  | 0.56        | 0.62        | 0.85                  | 1.20         |
| MSS5131-333ML_           | 33                                   | 0.200                | 18.0                             | 0.44                  | 0.52        | 0.58        | 0.80                  | 1.10         |
| MSS5131-393ML_           | 39                                   | 0.215                | 17.0                             | 0.42                  | 0.50        | 0.55        | 0.74                  | 1.00         |
| MSS5131-473ML_           | 47                                   | 0.270                | 16.0                             | 0.38                  | 0.46        | 0.51        | 0.71                  | 0.95         |
| MSS5131-563ML_           | 56                                   | 0.280                | 15.0                             | 0.34                  | 0.42        | 0.47        | 0.70                  | 0.90         |
| MSS5131-683ML_           | 68                                   | 0.368                | 12.5                             | 0.31                  | 0.38        | 0.42        | 0.66                  | 0.85         |
| MSS5131-823ML_           | 82                                   | 0.420                | 12.0                             | 0.27                  | 0.32        | 0.35        | 0.62                  | 0.80         |
| MSS5131-104ML_           | 100                                  | 0.580                | 11.5                             | 0.26                  | 0.30        | 0.33        | 0.55                  | 0.69         |
| MSS5131-124ML_           | 120                                  | 0.610                | 11.0                             | 0.23                  | 0.27        | 0.30        | 0.51                  | 0.62         |
| MSS5131-154ML_           | 150                                  | 0.820                | 10.0                             | 0.21                  | 0.26        | 0.28        | 0.47                  | 0.58         |
| MSS5131-184ML_           | 180                                  | 1.00                 | 9.0                              | 0.19                  | 0.23        | 0.25        | 0.43                  | 0.54         |
| MSS5131-224ML_           | 220                                  | 1.10                 | 8.0                              | 0.18                  | 0.21        | 0.23        | 0.39                  | 0.50         |
| MSS5131-274ML_           | 270                                  | 1.43                 | 7.5                              | 0.15                  | 0.18        | 0.20        | 0.35                  | 0.45         |
| MSS5131-334ML_           | 330                                  | 1.58                 | 6.8                              | 0.13                  | 0.17        | 0.19        | 0.32                  | 0.42         |
| MSS5131-394ML_           | 390                                  | 1.80                 | 5.4                              | 0.12                  | 0.15        | 0.16        | 0.30                  | 0.38         |

1. Please specify **termination** and **packaging** codes:

MSS5131-394MLC

**Termination:** L = RoHS compliant matte tin over nickel over phos bronze (current production) or gold over nickel over phos bronze (prior production).

**Special order:**

**T** = RoHS tin-silver-copper (95.5/4/0.5) over gold over nickel over phos bronze or **S** = non-RoHS tin-lead (63/37) over gold over nickel over phos bronze.

**Packaging:** C = 7" machine-ready reel EIA-481 embossed plastic tape (600 per full reel).

**B = Less than full reel** In tape, but not machine-ready. To have a leader and trailer added (\$25 charge), use code letter C instead.

**D = 13" machine-ready reel** EIA-481 embossed plastic tape. Factory order only, not stocked (2500 per reel per full reel).

2. Inductance tested at 100 kHz, 0.1 Vrms, 0 Adc using an Agilent/HP 4263B LCR meter or equivalent.
3. SRF measured using Agilent/HP 4191A or equivalent.
4. DC current at 25°C that causes the specified inductance drop from its value without current. [Click for temperature derating information.](#)
5. Current that causes the specified temperature rise from 25°C ambient. This information is for reference only and does not represent absolute maximum ratings. [Click for temperature derating information.](#)
6. Electrical specifications at 25°C. Refer to Doc 362 "Soldering Surface Mount Components" before soldering.

**SPICE models**  
ON OUR WEB SITE



[www.coilcraft.com](http://www.coilcraft.com)

**US** +1-847-639-6400 [sales@coilcraft.com](mailto:sales@coilcraft.com)

**UK** +44-1236-730595 [sales@coilcraft-europe.com](mailto:sales@coilcraft-europe.com)

**Taiwan** +886-2-2264 3646 [sales@coilcraft.com.tw](mailto:sales@coilcraft.com.tw)

**China** +86-21-6218 8074 [sales@coilcraft.com.cn](mailto:sales@coilcraft.com.cn)

**Singapore** + 65-6484 8412 [sales@coilcraft.com.sg](mailto:sales@coilcraft.com.sg)

Document 642-1 Revised 09/02/15

© Coilcraft Inc. 2017

This product may not be used in medical or high risk applications without prior Coilcraft approval. Specification subject to change without notice. Please check web site for latest information.



# Shielded Power Inductors – MSS5131

## Typical L vs Current

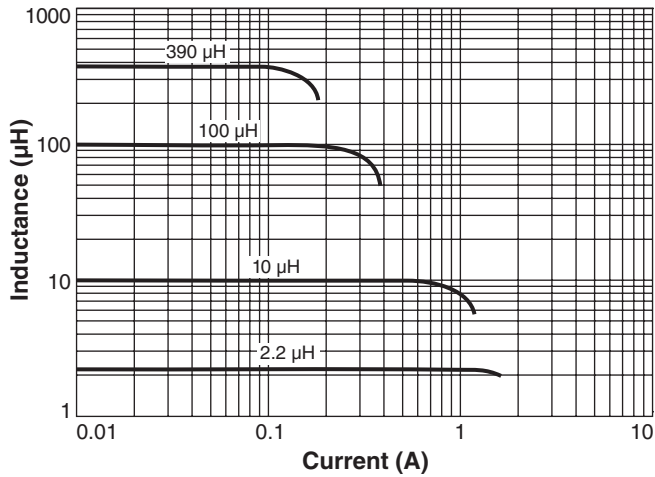

## Typical L vs Frequency

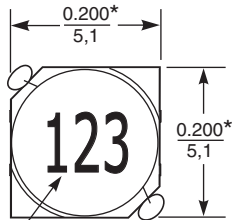
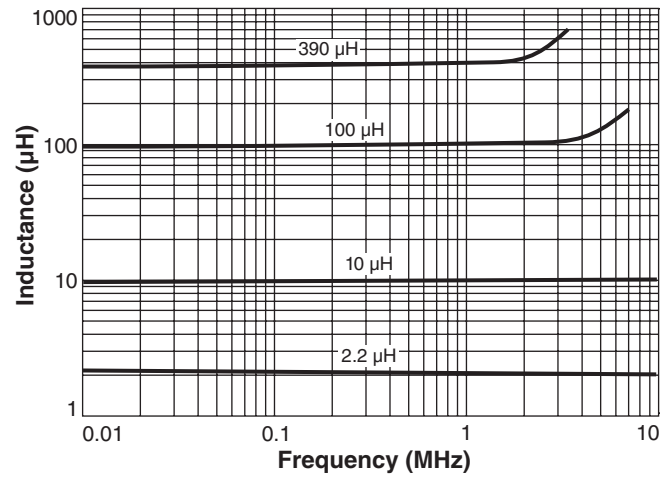

Dash number

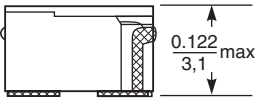

\*Dimensions are of the case not including the termination. For maximum overall dimensions including the termination, add 0.035 in / 0,9 mm.

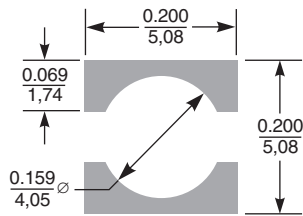
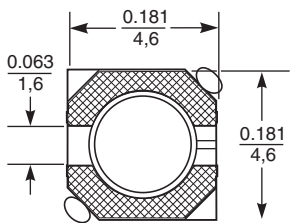

**Recommended Land Pattern**

Dimensions are in  $\frac{\text{inches}}{\text{mm}}$



**US** +1-847-639-6400 sales@coilcraft.com  
**UK** +44-1236-730595 sales@coilcraft-europe.com  
**Taiwan** +886-2-2264 3646 sales@coilcraft.com.tw  
**China** +86-21-6218 8074 sales@coilcraft.com.cn  
**Singapore** + 65-6484 8412 sales@coilcraft.com.sg

Document 642-2 Revised 09/02/15  
 © Coilcraft Inc. 2017  
 This product may not be used in medical or high risk applications without prior Coilcraft approval. Specification subject to change without notice. Please check web site for latest information.