



5744, 5745, 5746, 5749 Low cost, labor saving, slide on heat sink featuring spring action



Low cost, labor saving, slide on heat sink features spring action to firmly hold the device tab to the heat sink providing maximum metal to metal contact and good thermal conduction. Available with solderable tabs for horizontal or vertical mounting to the PC board.

FIGURE A

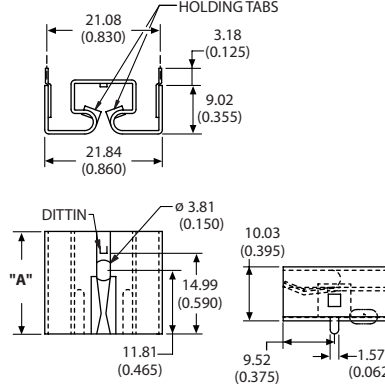
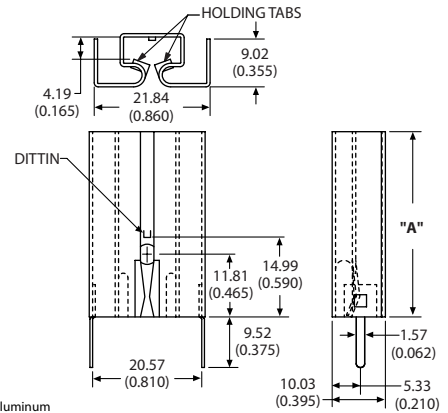

FIGURE B



Material: 0.63 (0.025) Thick Aluminum  
Finish: Black Anodize

ORDERING INFORMATION

Part Number	Description	Figure	"A" Dim	Dia of PCB Plated Thru Hole for Tabs
574402B00000	Low cost slide on heat sink	A	19.05 (0.750)	
574402B03200	With solderable tabs for horizontal mounting	A	19.05 (0.750)	1.91 (0.075)
574502B00000	Low cost slide on heat sink	B	19.05 (0.750)	
574502B03300	With solderable tabs for vertical mounting	B	19.05 (0.750)	1.91 (0.075)
574602B00000	Low cost slide on heat sink	B	17.53 (0.690)	
574602B03300	With solderable tabs for vertical mounting	B	17.53 (0.690)	1.91 (0.075)
574902B00000	Low cost slide on heat sink	B	34.92 (1.375)	
574902B03300	With solderable tabs for vertical mounting	B	34.92 (1.375)	1.91 (0.075)

For additional options see page 82

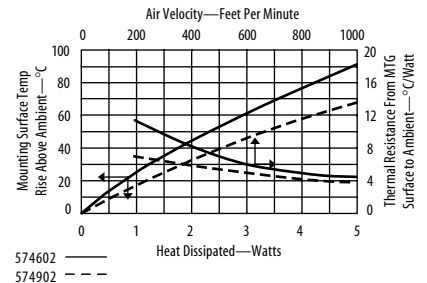
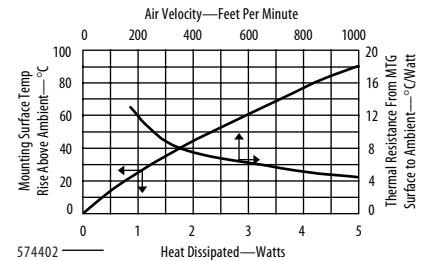

5741 Low cost, labor saving, slide on heat sink featuring spring action



Low cost, labor saving, slide on heat sink features spring action to firmly hold the device tab to the heat sink providing maximum metal to metal contact and good thermal conduction. Includes a clearance hole in the top side to allow the use of optional hardware to attach device and heat sink to circuit board or other surface. Also available with solderable tabs for vertical mounting to the PC board.

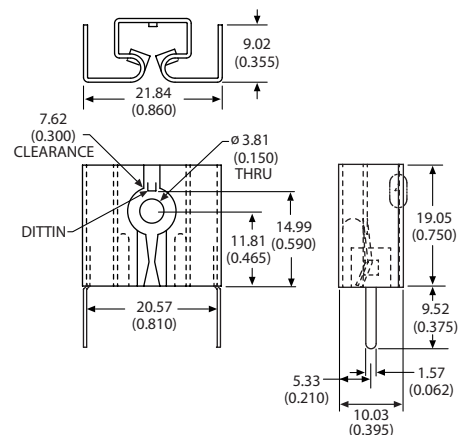
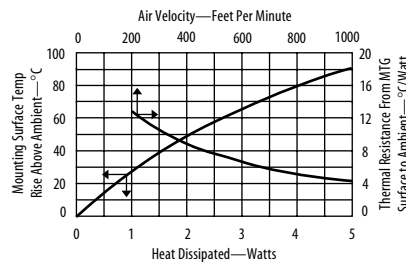

Material: 0.63 (0.025) Thick Aluminum  
Finish: Black Anodize

ORDERING INFORMATION

Part Number	Description	Dia of PCB Plated Thru Hole for Tabs
574102B00000	Low cost slide on heat sink	
574102B03300	With solderable tabs	1.91 (0.075)

POPULAR OPTIONS: 574102B0 00 00

Base part no. A

Position	Code	Description	Details
A	37	Solderable tab with step to limit insertion depth	Page 92

For additional options see page 82



5425

## Space saving staggered fin heat sink

Grease & Epoxy  
page 112

Mounting Kits  
page 99



**Space saving staggered fin heat sink for vertical mounting** TO-220 devices. Features integrated solderable mounting tabs that can be twisted for attachment to the PC board. Heat sink is also available with tin plating for soldering directly to the PC board.

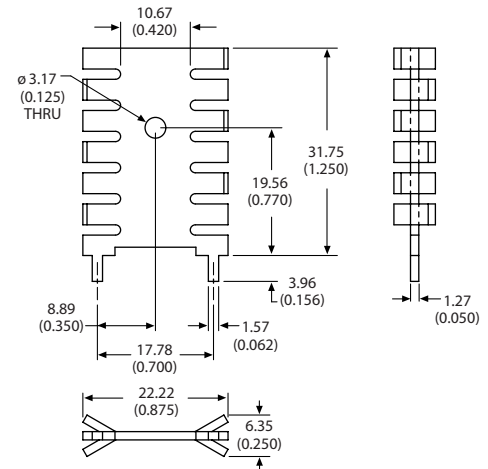
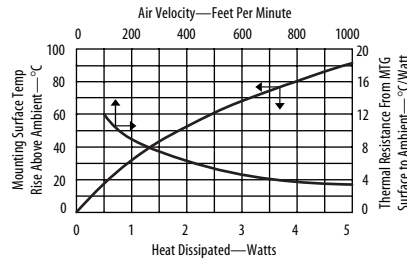

Material: 1.27 (0.050) Thick Aluminum  
Finish: See Table

### ORDERING INFORMATION

**Dia of PCB Plated Thru Hole for Tabs**

Part Number	Finish	Dia of PCB Plated Thru Hole for Tabs
542502B00000	Black anodize	2.39 (0.094)
542502D00000	Tin plated	2.39 (0.094)

For additional options see page 82

5925

## Space saving twisted fin heat sink

Grease & Epoxy  
page 112

Mounting Kits  
page 99



**Space savings twisted fin heat sink for vertical mounting** TO-220 devices. Features staked on solderable mounting tabs for easy attachment to the PC board.

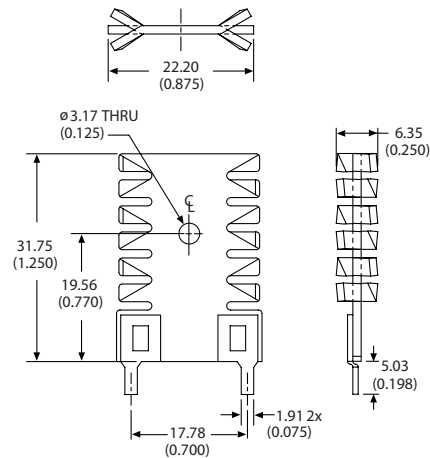
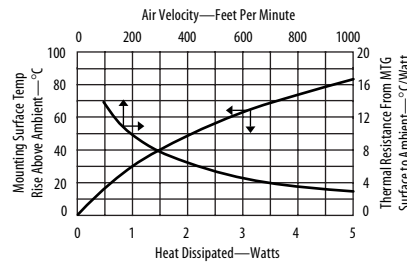

Material: 1.27 (0.050) Thick Aluminum  
Finish: See Table

### ORDERING INFORMATION

**Dia of PCB Plated Thru Hole for Tabs**

Part Number	Finish	Dia of PCB Plated Thru Hole for Tabs
592502B03400	Black anodize	2.39 (0.094)
592502U03400	Unfinished	2.39 (0.094)

For additional options see page 82



## 5751, 5793, 5794 Snap down style heat sink featuring two side fins



Snap down style heat sink feature two side fins that act as springs to hold the semiconductor firmly to the heat sink. Models include an integrated clip and device locking catch for more robust applications. Available for both standard and bevel edged TO-220 packages.

FIGURE A

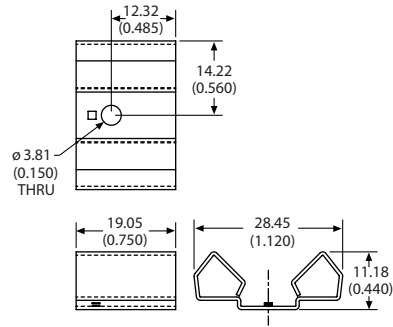
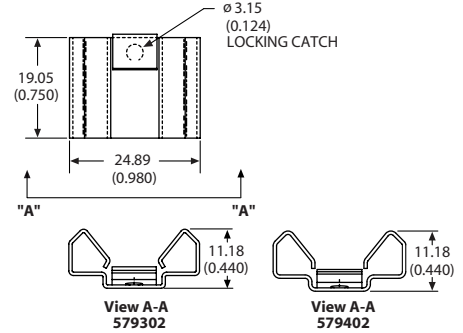

FIGURE B



Material: 0.63 (0.025) Thick Aluminum  
Finish: Black Anodize

### ORDERING INFORMATION

Part Number	Description	Figure
575102B00000	Snap down heat sink	A
579302B00000	With integrated clip and locking catch	B
579402B00000	With integrated clip and locking catch for TO-220 with beveled edge	B

For additional options see page 82

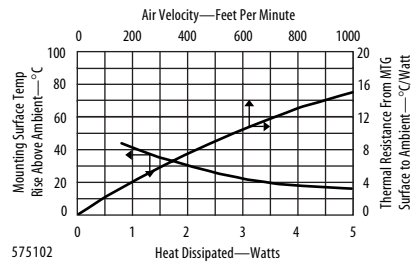
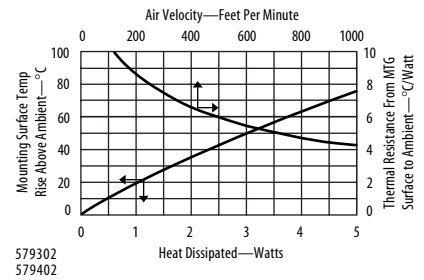



5768

## Plug in style heat sink featuring four spring action clips



Plug in style heat sink features four spring action clips to firmly hold the device to the heat sink ensuring maximum metal to metal thermal contact. Available with solderable mounting tabs for both horizontal and vertical mounting to the PC board.

FIGURE A

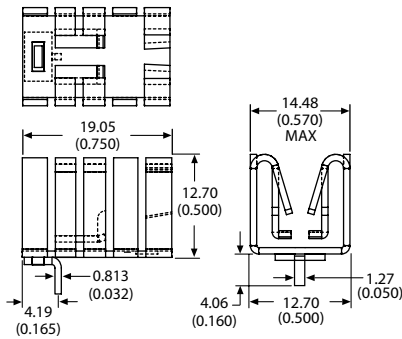
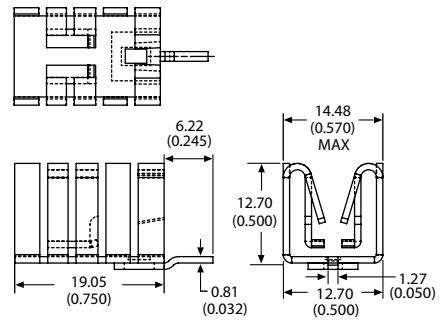

FIGURE B



Material: 0.81 (0.032) Thick Aluminum  
 Finish: See Table

### ORDERING INFORMATION

Part Number	Description	Figure	Finish	Dia of PCB Plated Thru Hole for Tabs
576802B00000	Slim plug in heat sink	A	Black anodize	
576802C00000	Slim plug in heat sink	A	Gold chromate	
576802U00000	Slim plug in heat sink	A	Unfinished	
576802B03100	With single tab for horizontal mounting	A	Black anodize	1.73 (0.068)
576802C03100	With single tab for horizontal mounting	A	Gold chromate	1.73 (0.068)
576802U03100	With single tab for horizontal mounting	A	Unfinished	1.73 (0.068)
576802B04000	With single tab for vertical mounting	B	Black anodize	1.75 (0.069)
576802C04000	With single tab for vertical mounting	B	Gold chromate	1.75 (0.069)
576802U04000	With single tab for vertical mounting	B	Unfinished	1.75 (0.069)

For additional options see page 84

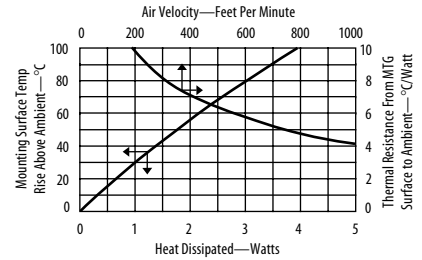

## PF432, PF433, PF434, PF435, PF436 Plug in style heat sink features pre blackened finish



Plug in style heat sink features Pre-blackened finish and two spring action clips to firmly hold the device to the heat sink ensuring maximum metal to metal thermal contact. Available with solderable mounting tabs for both horizontal and vertical mounting to the PC board.

FIGURE A

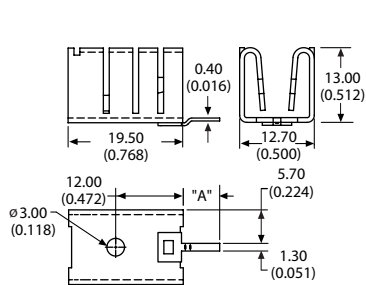

FIGURE B

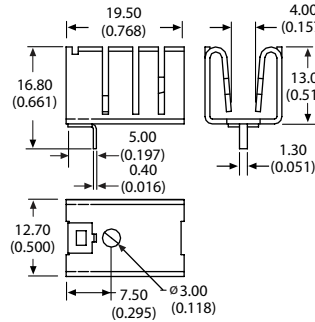
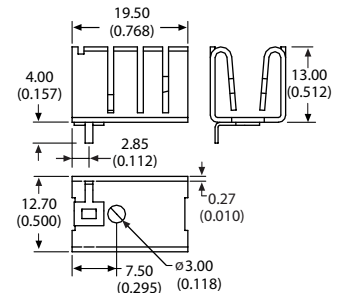

FIGURE C



Material: 0.71 (0.028) Thick Aluminum  
 Finish: Pre-Black Anodize\*

### ORDERING INFORMATION

Part Number	Description	Figure	Dim "A"	Dia of PCB Plated Thru Hole for Tabs
PF432	Plug in style heat sink with solderable tab, vertical mount	A	6.20 (0.244)	1.60 (0.063)
PF433	With vertical mount no tab	A		
PF434	With solderable tab, horizontal mount	B		1.60 (0.063)
PF435	With solderable tab, vertical mount	A	9.50 (0.374)	1.60 (0.063)
PF436	With solderable tab offset from center, horizontal mount	C		1.60 (0.063)

\*Edges cut during the manufacturing process will be unfinished.  
 See page 110 for more information

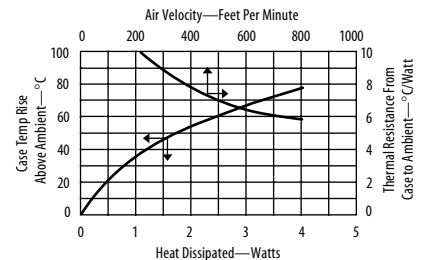

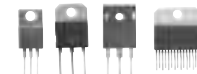

6374

## Extruded heat sink for SIP packages

Grease & Epoxy page 112

Mounting Kits page 99

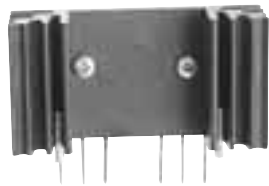

**Extruded heat sink for SIP packages.** Solderable pins allows vertical mounting without stress on the device leads. Can also be used for dual TO-220, TO-218, TO-247, and multiwatt devices.

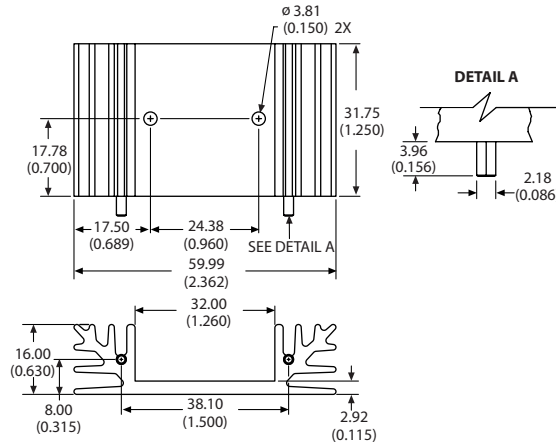
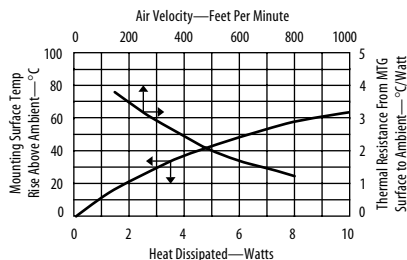

### ORDERING INFORMATION

Part Number	Description	Dia of PCB Plated Thru Hole for Pins
6374B	Extruded heat sink with solderable pins	2.89 (0.114)

For additional options see page 85

Material: Aluminum  
Finish: Black Anodize

YB32-4

## High power flat back extruded channel style heat sink

Grease & Epoxy page 112

Mounting Kits page 99



**High power flat back extruded channel style heat sink** features a wide channel to accommodate several devices. Includes two solderable pins to allow vertical mounting without stress on the device leads. Can be used with TO-220, TO-218, TO-247, and multiwatt devices.

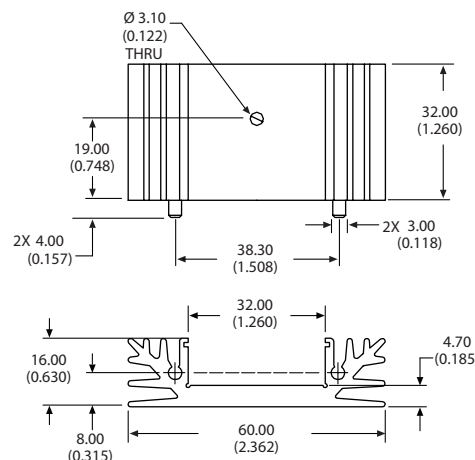
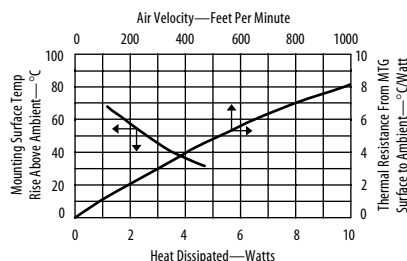

### ORDERING INFORMATION

Part Number	Description	Dia of PCB Plated Thru Hole for Pins
YB32-4	High power flat back extruded heat sink	3.48 (0.137)

Material: Aluminum  
Finish: Black Anodize

5810, 5811, 5812

## Flat back extruded heat sink featuring solderable pins

Grease & Epoxy page 112

Mounting Kits page 99



**Flat back extruded heat sink features solderable pins** which allow vertical mounting without stress on the device leads. Available in three heights for TO-220 and TO-218 devices.

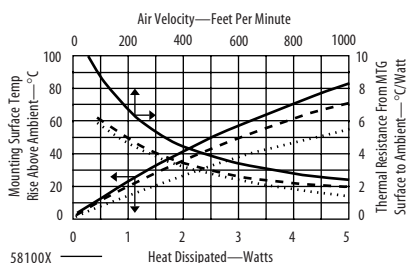

58100X ———  
58110X - - - -  
58120X ·····

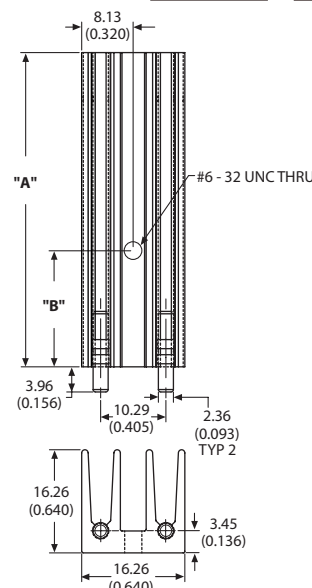

### ORDERING INFORMATION

Part Number	Device	"A" Dim	"B" Dim	Dia of PCB Plated Thru Hole for Pins
581001B02500	TO-218	25.40 (1.000)	21.59 (0.850)	2.67 (0.105)
581002B02500	TO-220	25.40 (1.000)	18.29 (0.720)	2.67 (0.105)
581101B02500	TO-218	38.10 (1.500)	21.59 (0.850)	2.67 (0.105)
581102B02500	TO-220	38.10 (1.500)	18.29 (0.720)	2.67 (0.105)
581201B02500	TO-218	50.80 (2.000)	21.59 (0.850)	2.67 (0.105)
581202B02500	TO-220	50.80 (2.000)	18.29 (0.720)	2.67 (0.105)

For additional options see page 83

Material: Aluminum  
Finish: Black Anodize

THRU HOLE DISCRETE SEMICONDUCTOR PACKAGES