

0.5mm Pitch
SERIES

6254

0.5mmピッチ NON-ZIF RA SMT 両面接点
0.5mmPitch LIF RA SMT Dual-sided contact

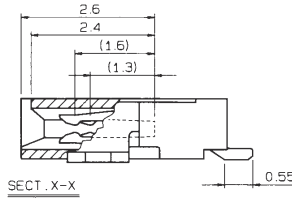
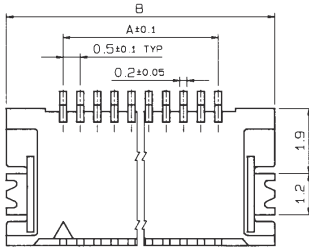

NO. OF POS.	A	B
5	2.0	5.6
6	2.5	6.1
7	3.0	6.6
8	3.5	7.1
9	4.0	7.6
10	4.5	8.1
11	5.0	8.6
12	5.5	9.1
13	6.0	9.6
14	6.5	10.1
15	7.0	10.6
16	7.5	11.1
17	8.0	11.6
18	8.5	12.1
19	9.0	12.6
20	9.5	13.1

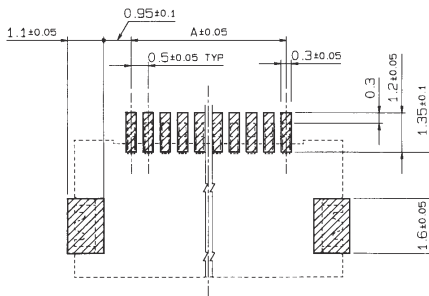
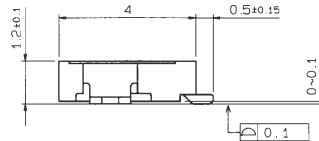
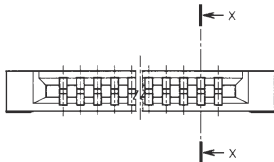

基板配付寸法
MOUNTING LAYOUT

	FPC		FFC	
	1	2	1	2
M	0.5±0.12	0.5±0.1	0.5±0.1	0.5±0.08
P	0.5±0.02	0.5±0.05	0.5±0.03	0.5±0.05
A	A±0.03	A±0.05	A±0.03	A±0.05
W	W±0.07	W±0.07	W±0.07	W±0.07
WD	0.35 ^{+0.04} _{-0.03}	0.35±0.05	0.3 ^{+0.03} _{-0.02}	0.3 ^{+0.05} _{-0.02}

適用FPC, FFC寸法
APPLICABLE FPC, FFC

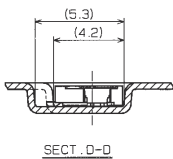
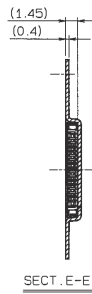
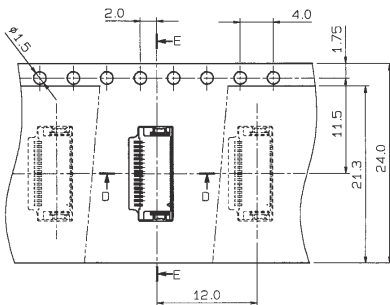
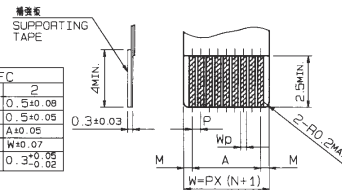

注文コード ORDERING CODE
04 6254 0XX 000 XXX+

RoHS 対応品
RoHS Compliant Product

800+ : スズ銅めっき Sn-Cu Plated
829+ : 金めっき Au Plated

極数 NUMBER OF POSITIONS

生産対応可能極数については、営業部に
ご確認ください。
Feel free to contact our sales department
for available numbers of positions.

梱包数量 2000個 /リール
PACKING QUANTITY : 2000/Reel