Product Change Notification (PCN)

Issue Date : 22.12.2009
Modification/Revision Date: 22.12.2009

2.54mm Pitch Header – Long Latch

Change Notification # PCN200912001

Change Description :

Change dimension from 7.65 to 7.85mm

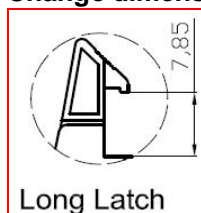

Date of Change and Implementation :

December 2009

Key Characteristics of Change :

Mechanical

Products Affected :

AWH xxG-02x2-IDC-Series
AWH xxG-02x2-LC-Series
AWH xxG-E2x2-IDC-Series
AWH xxA-02x2-LC-Series
AWH xxG-02x2-T-Series
AWH xxA-02x2-T-Series

Product Change Notification (PCN)

Reason for Change :
Improved Handling

Response :

No response to this notification is required.
Please contact an ASSMANN WSW components GmbH Sales Representative to obtain qualification samples.

Reference Documents / Attachments:

Document: Drawing ASS 2231 COrev03
 ASS 0532 COrev03
 ASS 1247A COrev03
 ASS 1247B COrev03
 ASS 2310 COrev04
 ASS 2311 COrev04

as attached

PCN Revision History:

Date of Revision: 22.12.2009

Revision Number: 00

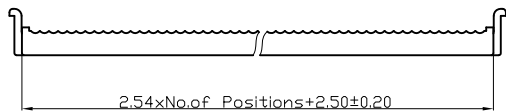
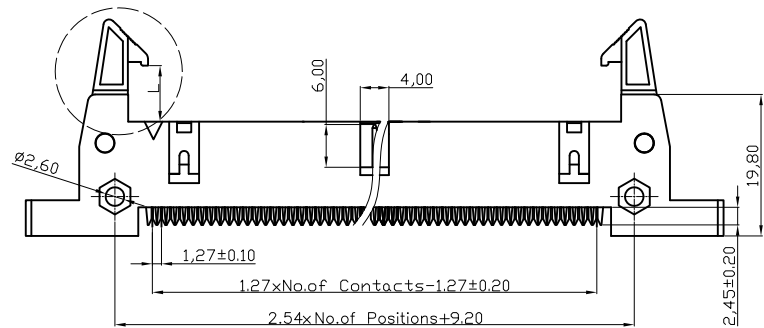
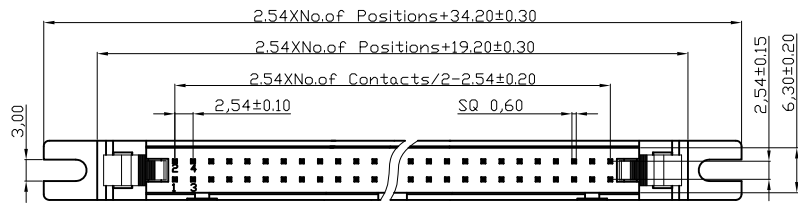

NOTES:

MATERIAL

- 1. Insulator Material: PBT+30%G.F.,(UL94V-0),Grey
- 2. Contact Material : Brass
- 3. Contact Plating : 1u" Au selective Over Ni

ELECTRICAL

- 1. Current Rating : 3.0 AMP
- 2. Withstand Voltage : 1000V AC/minute
- 3. Contact Resistance : 20mΩ max
- 4. Insulation Resistance: 1000MΩ min

ENVIRONMENTAL

- 1. Operation Temperature: -40°C to +105°C
- 2. Packing : Tray

Ordering Information

AWH xxG-E2x2-IDC

No. of Contacts :
10,14,16,20,26,
30,34,40,50,60,64

Latch Type
0 -without latch
2 -with short latches
3 -with long latches

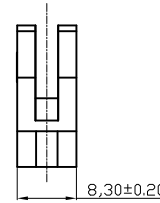

without Latch

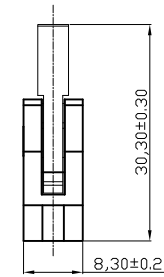

with Latch

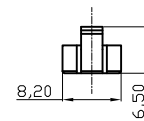

Short Latch

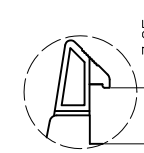

Long Latch

RoHS compliant

Scale	1:1	Date	29.05.2006	Name	Hellwig	Customer-No.	
TOLERANCE		Drawn					
X.X	±0.40						
X.XX	±0.25	Approved	03.11.2009	Hellwig		ASSMANN WSW-No.	AWH xxG-E2x2-IDC
X.XXX	±0.15	③	Modify dimension from 7.65 to 7.85	03.11.2009	Dean	Drawing-No.	
ANGLE	±3°	②	Increase right view Modification dimensions	16.02.2009	Dean	ASS 0532 CO	rev03
		①	Drawn	29.05.2006	Hellwig	Replace	Sheet
DIM	TOL	Id.	Modification	Date	Name		



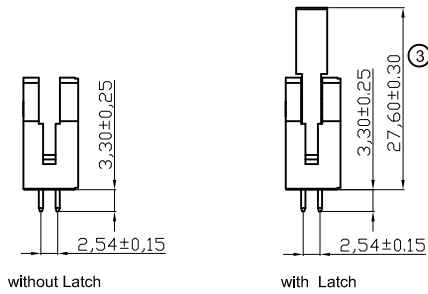
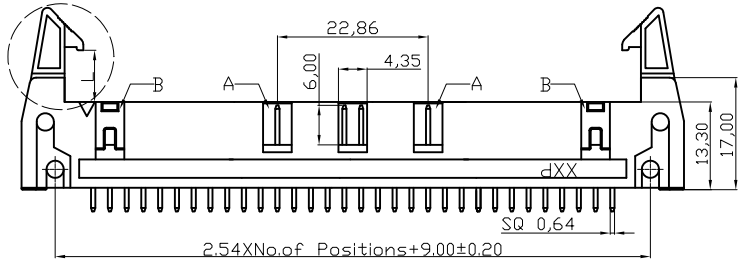
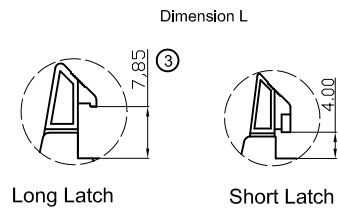
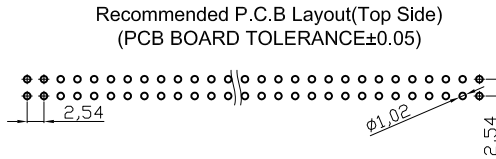
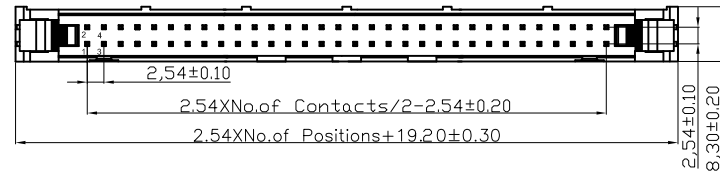

NOTES:
MATERIAL
 1.Insulator Material:PBT+30%G.F.(UL94V-0),Black
 2.Contact Material : Brass
 3.Contact Plating : Gold Flash over Ni
ELECTRICAL
 1.Current Rating : 3.0AMP
 2.Withstand Voltage : 1000V AC/minute
 3.Contact Resistance : 20mΩ max
 4.Insulation Resistance: 1000MΩ min
ENVIRONMENTAL
 1.Operation Temperature: -40°C to +105°C
 2.Packing: Tray
 3.No side slot "A" and "B" from 6 to 16 pin
 No side slot "A" from 18 to 58 pin

Ordering Information
AWH xxG-02x2-LC

No. of Contacts: 06,08,10,12,14,16,18,20,24,26,30,34,40,50,60,64
 Latch Type: 0 -without latch, 2 -with short latches, 3 -with long latches

RoHS compliant

Scale	1:1					Date	Name	Customer-No.
TOLERANCE						Drawn	21.02.2002	Hellwig
X.X	±0.40					Approved	03.11.2009	Hellwig
X.XX	±0.25							ASSMANN WSW-No. AWH xxG-02x2-LC
X.XXX	±0.15	③	Modify dimensions	03.11.2009	Dean			Drawing-No.
Angle	±3°	②	Redraw	26.03.2009	Dean	ASSMANN WSW components		ASS 1247A CO rev03
		①	Drawn	21.02.2002	Hellwig			Replace
		Id.	Modification	Date	Name			

1

2

3

4

5

6

7

A

A

B

B

C

C

D

D

E

E

F

F

G

G

H

H

NOTES:

MATERIAL

- 1. Insulator Material: PBT+30%G.F., (UL94V-0), Black
- 2. Contact Material : Brass
- 3. Contact Plating : Gold Flash over Ni

ELECTRICAL

- 1. Current Rating : 3.0AMP
- 2. Withstand Voltage : 1000V AC/minute
- 3. Contact Resistance : 20mΩ max
- 4. Insulation Resistance: 1000MΩ min

ENVIRONMENTAL

- 1. Operation Temperature: -40°C to +105°C
- 2. Packing: Tray
- 3. No side slot "A" and "B" from 6 to 16 pin
No side slot "A" from 18 to 58 pin

Ordering Information

AWH xxA-02x2-LC

No. of Contacts:
06,08,10,12,14,16,18,20
24,26,30,34,40,50,60,64

Latch Type:
0 -without latch
2 -with short latches
3 -with long latches

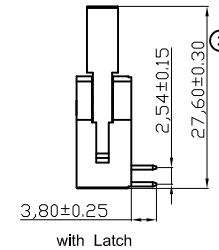
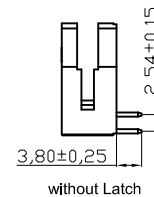
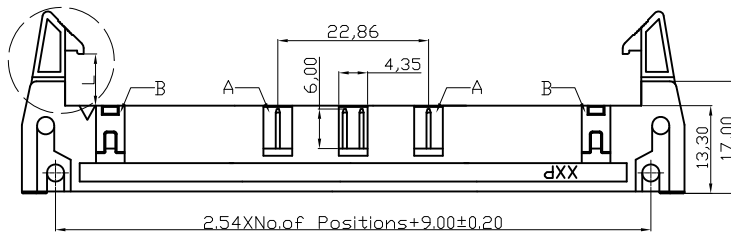
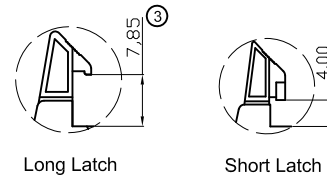
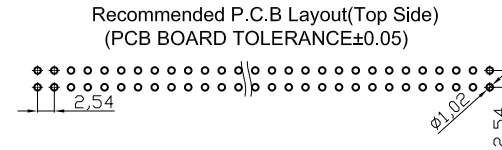
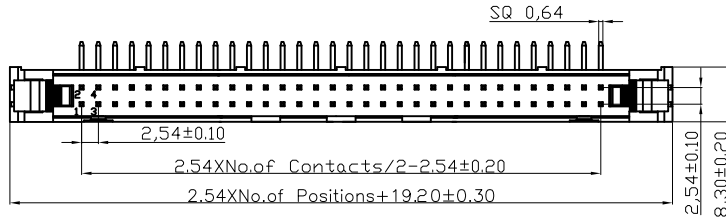

RoHS compliant

Scale	1:1						Date	Name	Customer-No.
TOLERANCE						Drawn	21.02.2002	Hellwig	
X.X	±0.40					Approved	03.11.2009	Hellwig	ASSMANN WSW-No.
X.XX	±0.25								AWH xxA-02x2-LC
X.XXX	±0.15	③	Modify dimensions	03.11.2009	Dean				Drawing-No.
Angle	±3°	②	Redraw	26.03.2009	Dean			ASS 1247B CO	rev03
		①	Drawn	21.02.2002	Hellwig			Replace	Sheet
		Id.	Modification	Date	Name				

1

2

3

4

5

6

7

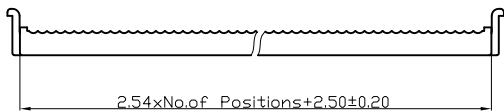
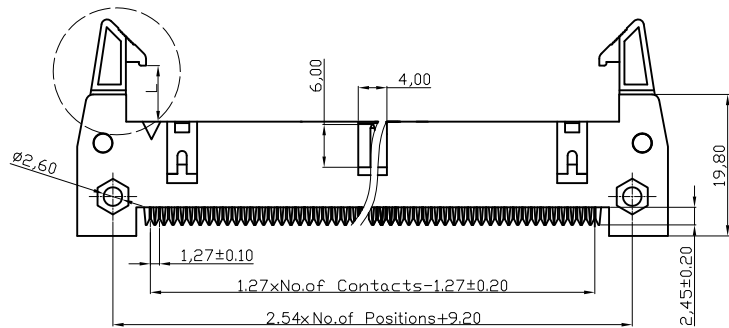
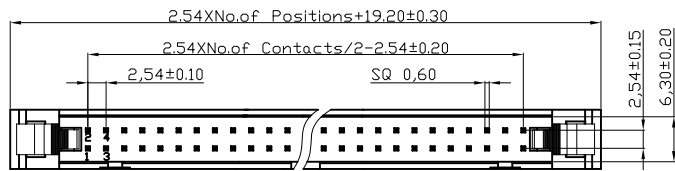

NOTES:

MATERIAL

- 1. Insulator Material: PBT+30%G.F., (UL94V-0), Grey
- 2. Contact Material : Brass
- 3. Contact Plating : 1u" Au selective Over Ni

ELECTRICAL

- 1. Current Rating : 3.0 AMP
- 2. Withstand Voltage : 1000V AC/minute
- 3. Contact Resistance : 20mΩ max
- 4. Insulation Resistance: 1000MΩ min

ENVIRONMENTAL

- 1. Operation Temperature: -40°C to +105°C
- 2. Packing : Tray

Ordering Information

AWH xxG-02x2-IDC

No. of Contacts :
10, 14, 16, 20, 26,
30, 34, 40, 50, 60, 64

Latch Type
0 -without latch
2 -with short latches
3 -with long latches

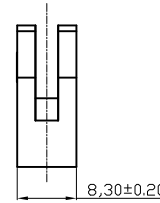

without Latch

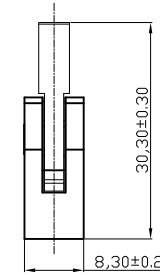

with Latch

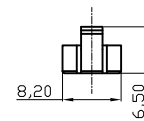

Short Latch

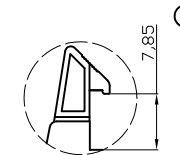

Long Latch

RoHS compliant

Scale	1:1						Date	Name	Customer-No.
TOLERANCE							Drawn	25.01.2006	Alex
X.X	±0.40						Approved	03.11.2009	Hellwig
X.XX	±0.25								
X.XXX	±0.15	③	Modify dimension from 7.65 to 7.85	03.11.2009	Dean				ASSMANN WSW-No. AWH xxG-02x2-IDC
ANGLE	±3°	②	Update	29.06.2009	Dean		Drawing-No.		ASS 2231 CO rev03
		①	Drawn	25.01.2006	Alex		Replace	Sheet	
DIM	TOL	Id.	Modification	Date	Name				

1 2 3 4 5 6 7

A B C D E F

Recommended P.C.B Layout(Top Side)
(PCB BOARD TOLERANCE±0.05)

Dimension L

Long Latch Short Latch

without Latch with Latch

NOTES:

MATERIAL

1.Insulator Material:PBT+30%G.F,(UL94V-0), Grey
2.Contact Material : Brass
3.Contact Plating : Gold Flash / Tin Over Ni

ELECTRICAL

1.Current Rating : 3.0AMP
2.Withstand Voltage : 1000V AC/minute
3.Contact Resistance : 20mΩ max
4.Insulation Resistance: 1000MΩ min

ENVIRONMENTAL

1.Operation Temperature: -40°C to +105°C
2.Packing : Tray
3.No side slot "A" and "B" from 6 to 16 pin
No side slot "A" from 18 to 58 pin

Ordering Information

AWH xxG-02x2-T

⊕ No. of Contacts	06 08	Latch Type	0(w/o latch)
	10 12		2(with short latch)
	14 16		3(with long latch)
	18 20		
	24 26		
	30 34		
	40 50		
	60 64		

RoHS compliant

Scale	1:1						Date	Name	Customer-No.	
TOLERANCE						Drawn	25.01.2006	Alex		
X.X	±0.40					Approved	03.11.2009	Hellwig	ASSMANN WSW-No.	
X.XX	±0.25	④	Modify dimensions	03.11.2009	Dean				AWH xxG-02x2-T	
X.XXX	±0.15	③	Correct No.of Contacts	29.06.2009	Dean				Drawing-No.	
Angle	±3°	②	Update	21.05.2009	Rale				ASS 2310 CO	rev04
		①	Drawn	25.01.2006	Hellwig			Replace	Sheet	
		Id.	Modification	Date	Name					

1 2 3 4 5 6 7

H

SV79

1 2 3 4 5 6 7

A

A

NOTES:

MATERIAL

- 1. Insulator Material: PBT+30%G.F.(UL94V-0), Grey
- 2. Contact Material : Brass
- 3. Contact Plating : Gold Flash / Tin Over Ni

ELECTRICAL

- 1. Current Rating : 3.0AMP
- 2. Withstand Voltage : 1000V AC/minute
- 3. Contact Resistance : 20mΩ max
- 4. Insulation Resistance: 1000MΩ min

ENVIRONMENTAL

- 1. Operation Temperature: -40°C to +105°C
- 2. Packing : Tray
- 3. No side slot "A" and "B" from 6 to 16 pin
- No side slot "A" from 18 to 58 pin

Ordering Information

AWH xxA-02x2-T	
④ No. of Contacts 06 08 10 12 14 16 18 20 24 26 30 34 40 50 60 64	Latch Type 0(w/o latch) 2(with short latch) 3(with long latch)

B

B

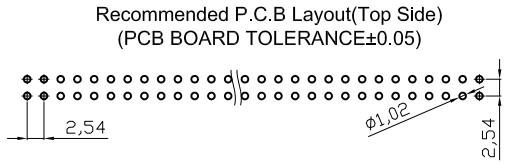
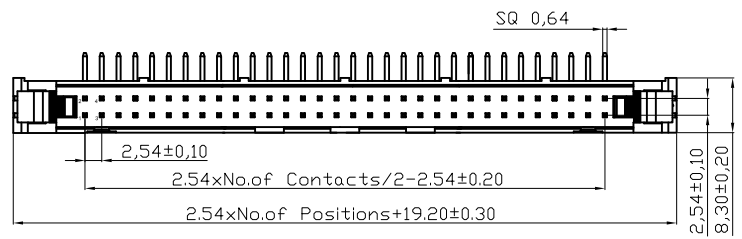

C

C

Dimension L

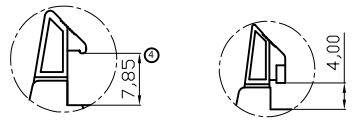

Long Latch

Short Latch

D

D

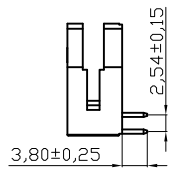
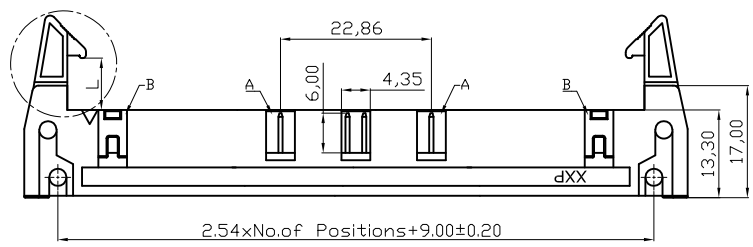

without Latch

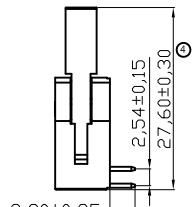

with Latch

E

E

F

F

RoHS compliant

Scale	1:1						Date	Name	Customer-No.	
TOLERANCE						Drawn	25.01.2006	Alex		
X.X	±0.40	④	Change dimension	27.10.2009	Dean	Approved	27.10.2009	Hellwig	ASSMANN WSW-No. AWH xxA-02x2-T	
X.XX	±0.25	③	Correct No. of contacts	29.06.2009	Dean				Drawing-No.	
X.XXX	±0.15	②	Update	21.05.2009	Rale	ASSMANN WSW components			ASS 2311 CO	rev04
Angle	±3°	①	Drawn	25.01.2006	Hellwig				Replace	Sheet
			Id.	Modification	Date	Name				

1 2 3 4 5 6 7