Product Change Notification(PCN)

Issue Date: 13.09.2012
Modification / Revision Date: 26.10.2012

D-Sub connector 9-37ways, 90°, dual-port-Style (2010 catalogue page 14)

Change Notification # : PCN 20120913-A-DD XX X-X

Description of changes:

1. Amendment of the specification
2. Dimension Shell heigh : New : 12.50 mm
3. Dimension mating face heigh : New : 6.0 mm
4. Dimension overall length : New : 25.5 +/-0.5 mm
5. Dimension Boardlock to Front : New : 16.4 mm
6. remove Port spacing "C" - OBSELETE
7. Catalogue 2010 shows different specification
8. Draw.-No. ASS 4956 C0rev01 substitutes ASS 0731A C0rev05

Date of change and Implementation: Change: June 2010 / Implementation: 15.08.2012

Key Characteristics of Change: DIMENSIONS - some tiny dimensions and tolerances

Products Affected:

A-DD xx A-1	09-37 ways
A-DD xx A-2	09-37 ways
A-DD xx A-3	09-37 ways
A-DD xx A-4	09-37 ways
A-DD xx B-1	09-37 ways
A-DD xx B-2	09-37 ways
A-DD xx B-3	09-37 ways
A-DD xx B-4	09-37 ways
A-DD xx C-1	09-37 ways - OBSELETE
A-DD xx C-2	09-37 ways - OBSELETE
A-DD xx C-3	09-37 ways - OBSELETE
A-DD xx C-4	09-37 ways - OBSELETE

Reason for Change: Change of manufacturing location

Response : No response to this notification is required.

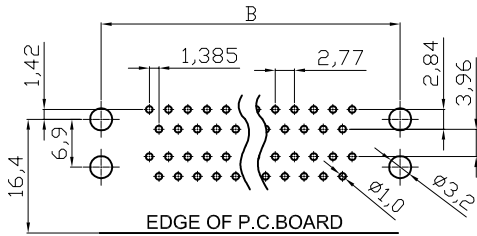
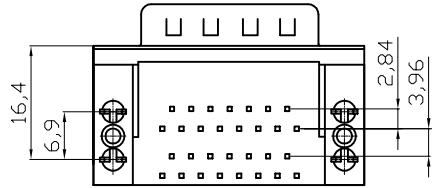
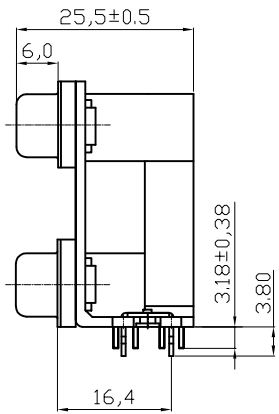
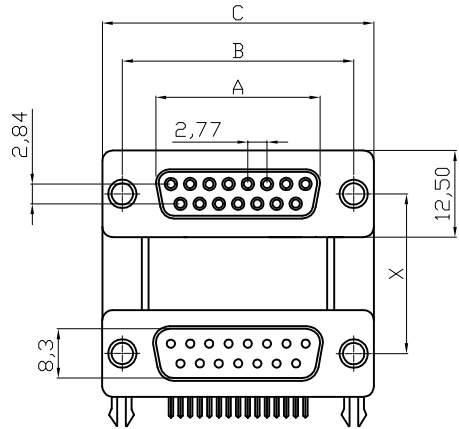

RECOMMENDED P.C.B LAYOUT (TOP VIEW)
TOLERANCES: ±0.10mm

SPECIFICATION
MATERIAL
 Insulator: PBT, rated UL94V-0, black
 Contacts: Copper alloy
 Shell: Steel : 7439-89-6
 Rivet, Boardlock: Copper alloy

CONTACT PLATING
 Contact area: Gold flash
 Solder tails: 100u" Tin over 40u" Nickel
 Shell plating: Tin plated
 Underplate: 50u" Nickel

ELECTRICAL
 Operation voltage: 250 VAC max.
 Current rating: 3 Amps max.
 Contact resistance: 25 mohms max.
 Insulation resistance: 3000 Mohms min @ 500 VDC
 Dielectric withstanding voltage: 1000 VAC / minute
 Operating temperature: -55°C ~ +105°C

① Order Code:

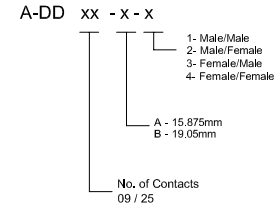

Dimensions

POSITION	A	B	C
9	16.92	25.00	30.8
15	25.25	33.30	39.2
25	38.96	47.10	53.1
37	54.42	63.50	69.4

RoHS compliant

Unit: mm

Scale	Free					Date	Name	Customer-No.	
TOLERANCE						Drawn	31.08.2012	Winnie	
X.	±0.50					Approved	26.10.2012	Winnie	
X.X	±0.30								
X.XX	±0.20								
DIM	TOL	① Update	26.10.2012	Winnie	ASSMANN WWSW components	Drawing-No.		ASSMANN WSW-No. A-DD XX X-X	
		① Drawn	31.08.2012	Winnie		ASS 4956 CO			rev01
Angle	±5°	Id.	Modification	Date		Name	Replace		Sheet
									1/1

1

2

3

4

5

6

7