

# TAC-3, TA(N)2-3 SERIES

## 4x7 SMT & Side Push Type

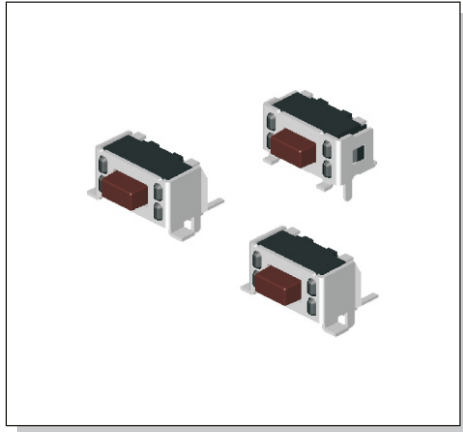

### HOW TO ORDER

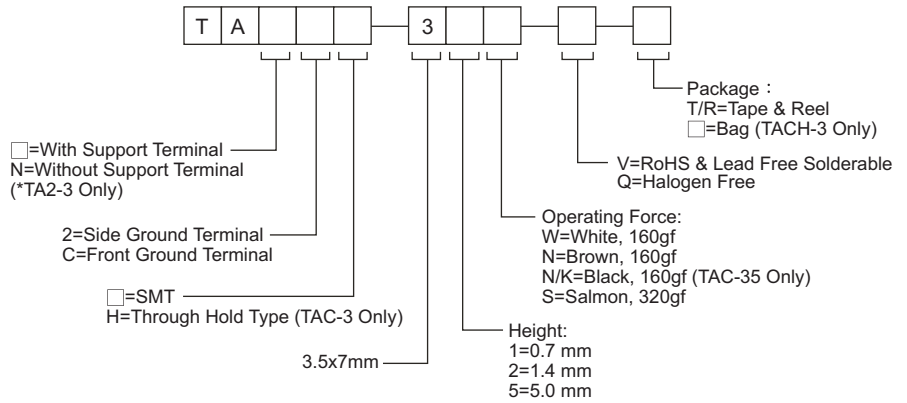

### SPECIFICATION

#### MECHANICAL

Operation Force: 320 ± 50gf Salmon (S)  
 160 ± 50gf White (W)  
 Stroke : 0.25+0.1/-0.2mm

#### ENVIRONMENTAL

Operation Temperature Range : -25°C to +70°C  
 Storage Temperature Range : -30°C to +80°C

#### ELECTRICAL

Electrical Life : 50,000 cycles  
 Rating : 50mA, 12VDC

#### PACKAGE

Tape and Reel: 900 pcs/reel  
 TACH-3: 500 pcs/bag

### CIRCUIT

#### TAC-3

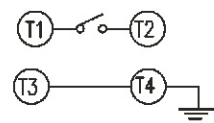

#### TA(N)2-3

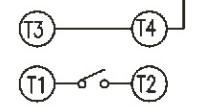

#### TACH-3

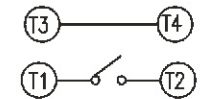

### TAC-3

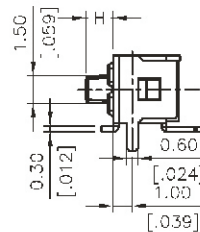
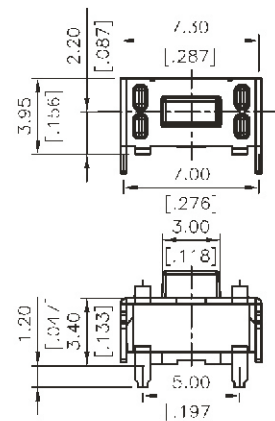

TAC-35	5.00[.196]
TAC-32	1.40[.055]
TAC-31	0.70[.027]
PART NO.	H

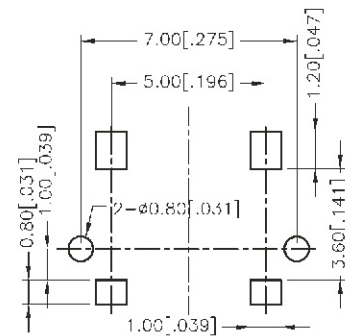

P.C.B. LAYOUT

### TAN2-3

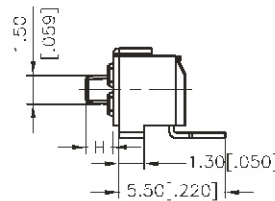
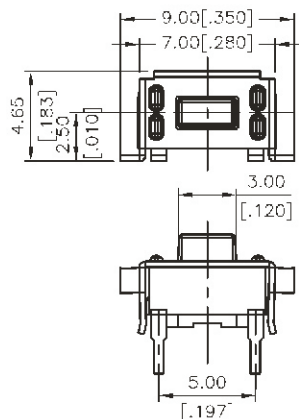

TAN2-35	5.00[.196]
TAN2-32	1.40[.055]
TAN2-31	0.70[.027]
PART NO.	H

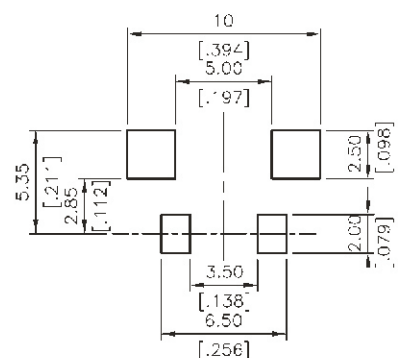

P.C.B. LAYOUT

# TAC-3, TA(N)2-3 SERIES

## 4x7 SMT & Side Push Type

### TA2-3

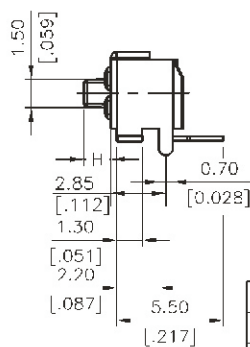
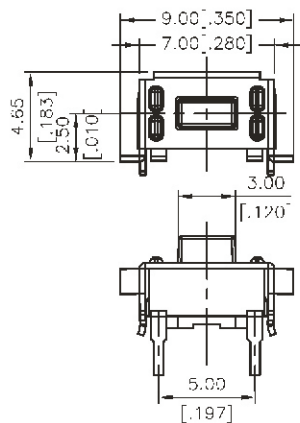

TA2-35	5.00 [.196]
TA2-32	1.40 [.055]
TA2-31	0.70 [.027]
PART NO.	H

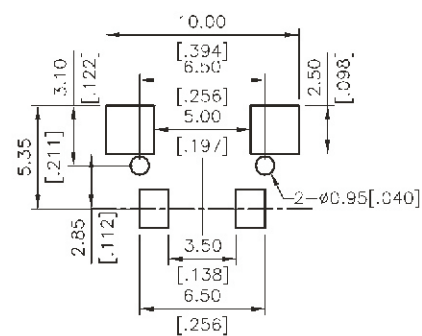

P.C.B. LAYOUT

### TACH-3

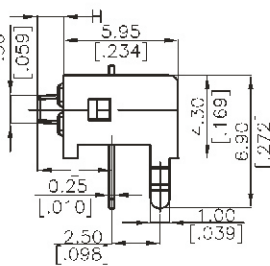
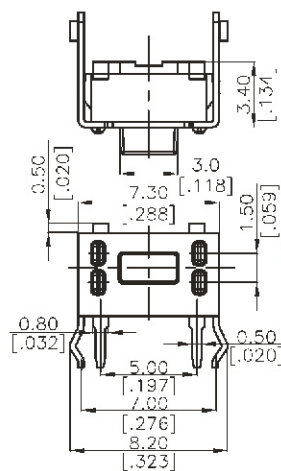

TACH-32	1.40 [.055]	3.85 [.152]
TACH-31	0.70 [.027]	3.15 [.124]
PART NO.	H	L

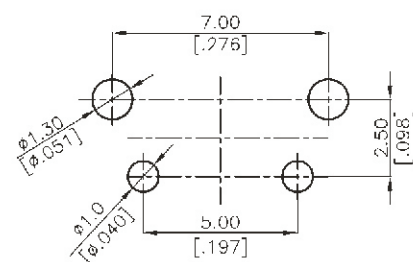

P.C.B. LAYOUT