

This document is the property of Amphenol Corporation and is delivered on the express condition that it is not to be disclosed, reproduced or used, in whole or in part, for manufacture or sale by anyone other than Amphenol Corporation without its prior consent, & that no right is granted to disclose or to use any information in this document.

REVISIONS				
SYM	ECN	DESCRIPTION	DATE	APPROVED
1	HK--	First Release Drawing	Feb/27/2013	IP

### D-SUB TECHNICAL DATA

SHELL : Steel, 100u" min tin over 50u" min nickel over 50u" copper  
 BODY : Class-Filled Thermoplastic PBT UL 94V-0 Rated,Black  
 CONTACTS : Copper Alloy  
 Gold Flash over 50u" min nickel on mating area.  
 100u" min tin over 50u" min nickel on solder area.  
 ELECTRICAL : Voltage rating 250 V Rms to 50 Hz  
 Current rating 3A.  
 Withstanding Voltage >500 V Rms to 50 Hz for one minute  
 Insulation resistance >1000 M Ohms  
 Contact resistance 20 mOhms max.  
 CLIMATIC : Temperature range -55 °C up to 85°C

### PRODUCT CODE

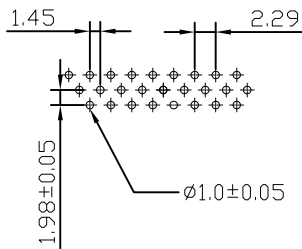
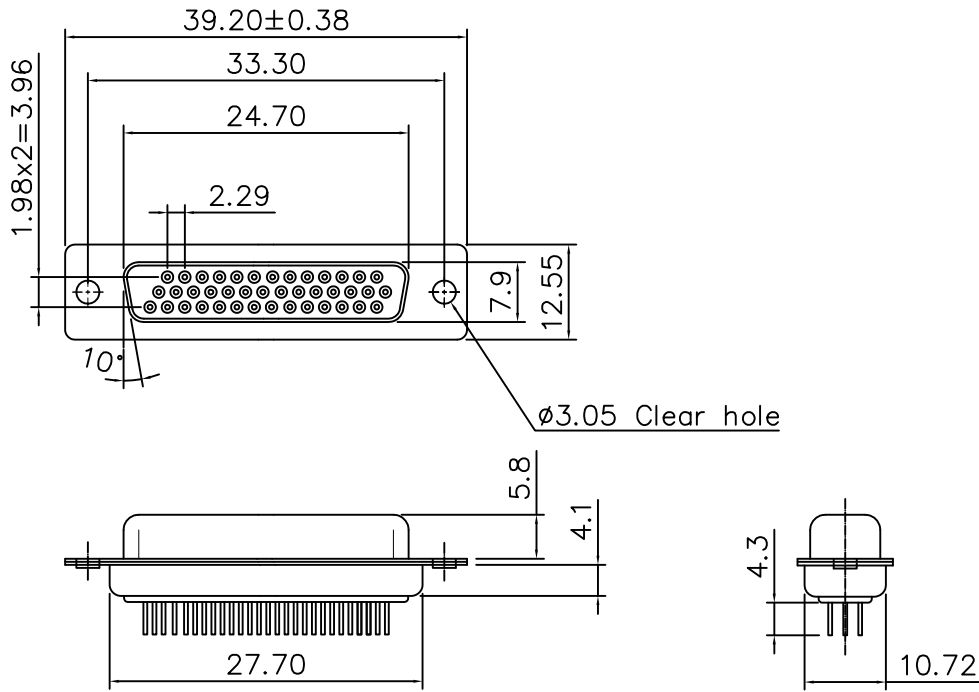
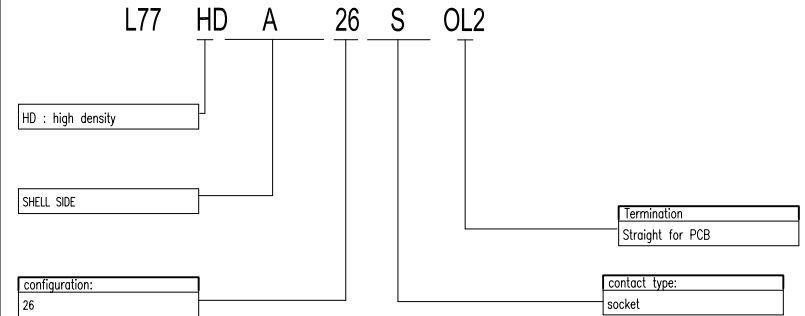

RECOMMENDED P.C.B LAYOUT  
 TOLERANCE±0.05



UNLESS OTHERWISE SPECIFIED TOLERANCES		APPROVAL		DATE
U.S.	METRIC	DRAWN	Patna Liu	Feb/27/2013
.X +/-	0.50	CHECKED	Tony Tang	Feb/27/2013
.XX +/-	0.30	CHECKED		
.XXX +/-	0.20			
FRACTIONS +/-				
ANGLES +/-	5°			
FOR MATERIALS AND FINISHES SEE NOTES		DRAWING FILE :		
REMOVE SHARP EDGES		ANGLE OF PROJECTION		
DIMENSIONS				
U.S.	INCHES	SIZE DRAWING NO.		
METRIC	MM	A4 L77HDA26SOL2		
		SCALE	NONE	SHEET 1 OF 1

Amphenol		
TITLE		
D-sub,ST,HD,26F G/F.		
REV.	DRAWING NO.	SIZE
1	L77HDA26SOL2	A4