

A

B

C

D

E

F

REVISIONS				
SYM	ZONE	ECN, ERN NO.	DATE	APPRD.
E		REVISED PER EAR 13822	JAN18/11	L.C.

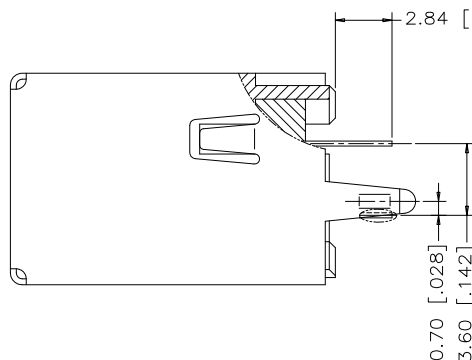
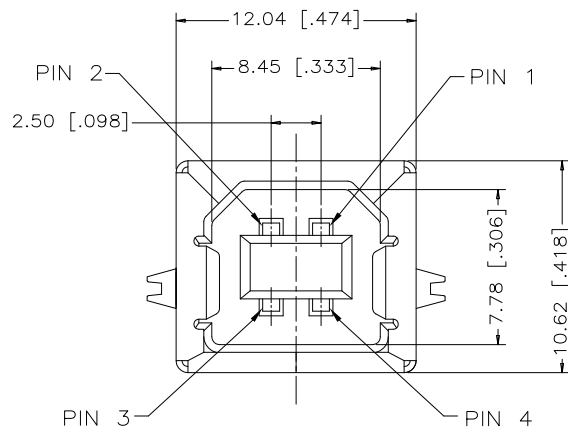

NOTES:

- HOUSING: HIGH TEMPERATURE THERMOPLASTIC OR POLYESTER(PBT) (SEE PART NUMBER) FLAMMABILITY UL94V-0 COLOUR: SEE PART NUMBER
- CONTACTS: PHOSPHOR BRONZE CONTACT PLATING: SEE AMPHENOL PART NUMBER SYSTEM FOR PLATING OPTIONS 50µin[1.27 MICRONS] MIN. NICKEL UNDERPLATE
- SHELL: PHOSPHOR BRONZE PLATING: NICKEL OVER COPPER UNDERPLATE.

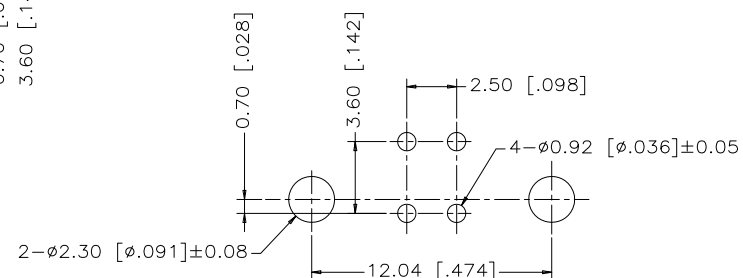

RECOMMENDED PC BOARD LAYOUT
(COMPONENT SIDE OF BOARD)

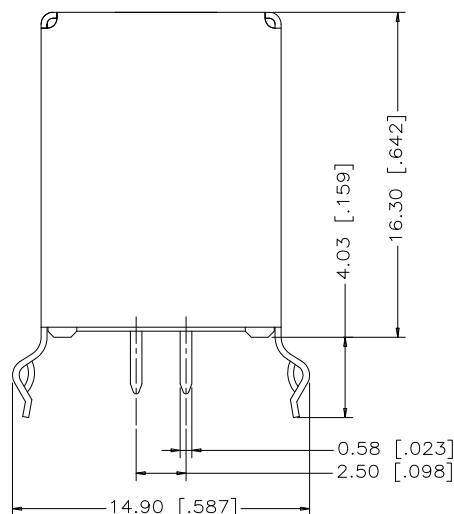

AMPHENOL PART NO.: U E 2 7 - B E X 4 - X 0 X

SERIES _____
UE27=RECEPTACLE

TYPE _____
B=SERIES B

STYLE _____
E=STRAIGHT PCB (TOP ENTRY)

CONTACT PLATING _____

5=30µin[0.76 MICRONS] GOLD OVER NICKEL ON CONTACT MATING AREA.

100µin[2.54 MICRONS] TIN OVER NICKEL ON CONTACT SOLDER AREA.

7=GOLD FLASH OVER NICKEL ON CONTACT MATING AREA.

100µin[2.54 MICRONS] TIN OVER NICKEL ON CONTACT SOLDER AREA.

MODIFIER
0=POLYESTER HOUSING (PBT)
H=HIGH TEMP MATERIAL
(MAX TEMPERATURE RATING 260°C FOR 10s)

SHIELDING
0=NO REAR SHIELD

COLOUR
1=BLACK
2=BEIGE(AVAILABLE IN STANDARD TEMP.ONLY)

NUMBER OF CONTACTS
4=4 CONTACTS



MATERIAL SEE NOTES	DRAWN MTChen	DATE JUL 26.06	Amphenol Canada Corp.	
	DESIGNED MTChen	JUL 26.06		
	CHECKED L.CHAN	JUL 26.06		
	I. E. APPRD.			
FINISH SEE NOTES	Q. A. APPRD.		TITLE UNIVERSAL SERIAL BUS RECEPTACLE, SERIES B, STRAIGHT PCB TAIL, VERTICAL MOUNT-RoHS COMPLIANT	
	DWG. APPRD.			
	ENG. REL. NO.			
	REF. EAR 12968			
	DIMENSIONS ARE IN mm[INCHES]	CODE ID. NO. 03554	DWG C	DRAWING NO. P-UE27-BEX4-X0X
	SCALE 5/1	WT. -----	SURF. -----	REV. E
				SHEET 1 OF 1

THIS DOCUMENT CONTAINS PROPRIETARY INFORMATION AND SUCH INFORMATION MAY NOT BE DISCLOSED TO OTHERS FOR ANY PURPOSE OR USED FOR MANUFACTURING PURPOSES WITHOUT WRITTEN PERMISSION FROM AMPHENOL CANADA CORP.

A

B

C

D

E

F