

# MIL-C-26482 Series 1 Type Connectors with PCB contacts PT02 box mounting receptacle

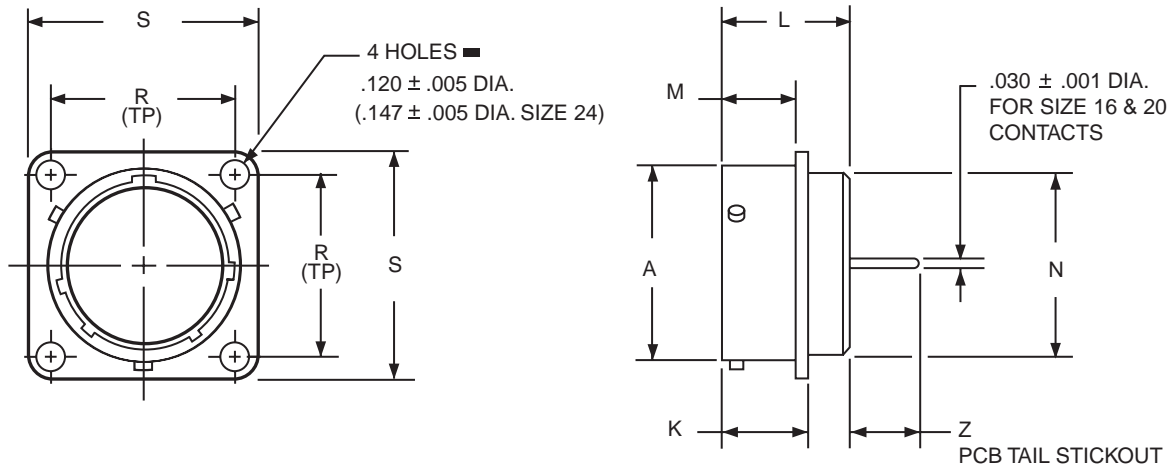

## HOW TO ORDER

- Order by applicable 71 part number in table below.  
71 prefix designates olive drab cadmium plated connector shell.  
(For availability of other finishes consult Amphenol, Sidney, NY)
  - Add insert arrangement to end of number. Refer to insert availability chart on page 4 and pin-out illustrations on pages 5-24. Last letter of part number designates rotation; P for pins in normal position, S for sockets in normal position. See page 26 for alternate rotation letter to use.  
Example part number: 71-570121-98P designates shell size 8 with a 8-98 insert and pin contacts in normal position.
  - Z dimension is determined by contact type in the insert arrangement.
  - Most common options are shown; other options are available.
- (MMC) located within .0025 of (TP)

| Shell Size | Part Number   | A<br>+.001<br>-.005 | K<br>+.021<br>-.010 | L<br>Max. | M<br>+.010<br>-.000 | N<br>Dia.<br>Max. | R<br>(TP) | S<br>+.011<br>-.010 | Z<br>+.040<br>-.050      |
|------------|---------------|---------------------|---------------------|-----------|---------------------|-------------------|-----------|---------------------|--------------------------|
|            |               |                     |                     |           |                     |                   |           |                     | Size 16 & 20<br>Contacts |
| 6          | 71-570120-XXX | .348                | .493                | .825      | .431                | .323              | .469      | .688                | .380                     |
| 8          | 71-570121-XXX | .473                | .493                | .825      | .431                | .449              | .594      | .812                | .380                     |
| 10         | 71-570122-XXX | .590                | .493                | .825      | .431                | .573              | .719      | .938                | .380                     |
| 12         | 71-570123-XXX | .750                | .493                | .825      | .431                | .699              | .812      | 1.031               | .380                     |
| 14         | 71-570124-XXX | .875                | .493                | .825      | .431                | .823              | .906      | 1.125               | .380                     |
| 16         | 71-570125-XXX | 1.000               | .493                | .825      | .431                | .949              | .969      | 1.219               | .380                     |
| 18         | 71-570126-XXX | 1.125               | .493                | .825      | .431                | 1.073             | 1.062     | 1.312               | .380                     |
| 20         | 71-570127-XXX | 1.250               | .650                | 1.076     | .556                | 1.199             | 1.156     | 1.438               | .286                     |
| 22         | 71-570128-XXX | 1.375               | .650                | 1.076     | .556                | 1.323             | 1.250     | 1.562               | .286                     |
| 24         | 71-570129-XXX | 1.500               | .683                | 1.109     | .589                | 1.449             | 1.375     | 1.688               | .253                     |

All dimensions for reference only.