

Square flange straight jack/jack

PART NUMBER	R 143 710 000
Panel drilling	P2 page 18

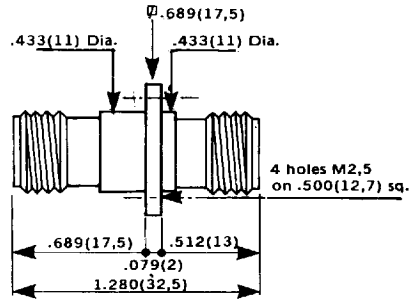

Bulkhead straight jack/jack

PART NUMBER	R 143 720 000●
Panel drilling	P12 page 18

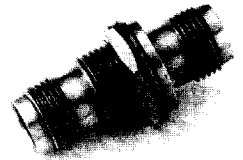
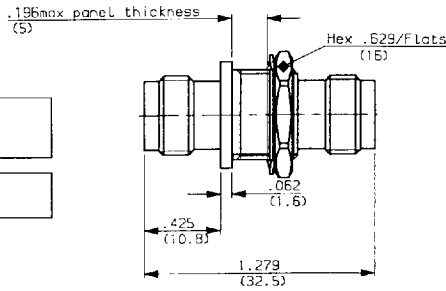

Bulkhead insulated straight jack/jack

PART NUMBER	R 143 723 000●
Panel drilling	P11 + P12 page 18

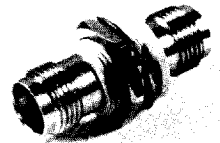
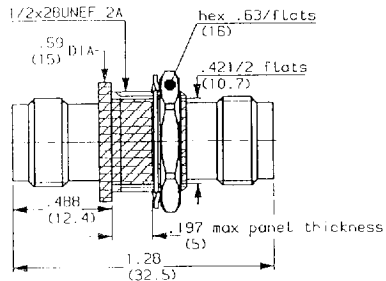

Bulkhead hermetically sealed straight jack/jack

PART NUMBER	R 143 753 000
Panel drilling	P11 page 18

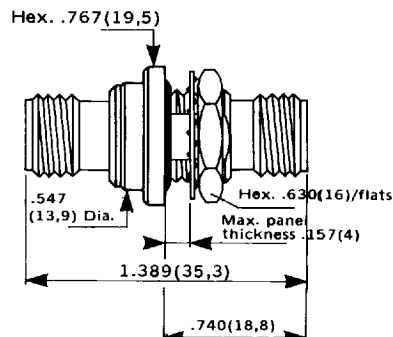

● Manufactured upon request.