

RECOMMENDED P.C. BOARD HOLE-LAYOUT

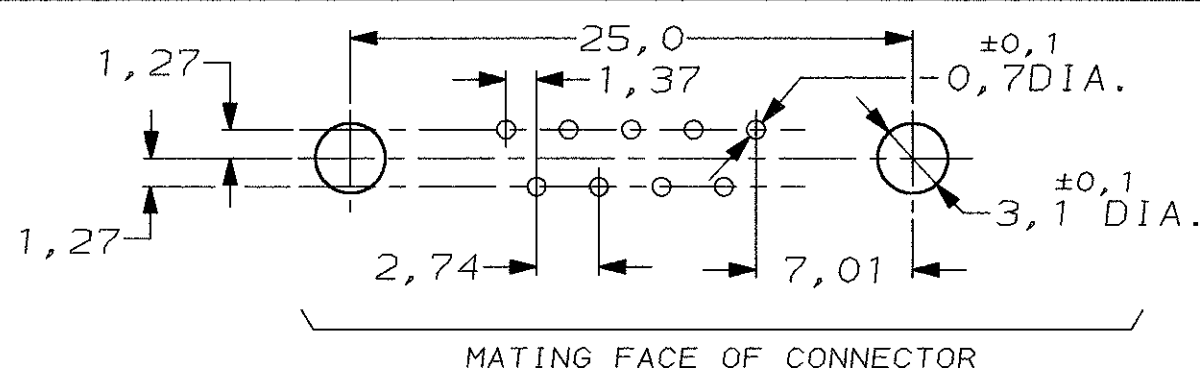

DO NOT SCALE

METRIC

THIRD ANGLE PROJECTION

DIMENSIONS IN mm

ACCESSORIES PREFIX "Z"	ITEM NR.	DESCRIPTION OF ACCESSORY	G								
	5	BUSHING WITH THROUGH HOLE 3,1 DIA.	2	2	2	2	2	2	2	2	2
5	BUSHING WITH INNER THREAD 4-40 UNC	2	2	2	2	2	2	2	2	2	
5	BUSHING WITH INNER THREAD M3	2	2	2	2	2	2	2	2	2	
4	FEMALE SCREWLOCK WITH 4-40 UNC	2	2	2	2	2	2	2	2	2	
4	FEMALE SCREWLOCK WITH M3	2	2	2	2	2	2	2	2	2	
7	BOARDLOCK	2	2	2	2	2	2	2	2	2	

HOW TO ORDER:	ITEM NR.	DESCRIPTION OF ACCESSORY	F									
	9 POS. ----->	Z-106505-Y		0-XXXXXX-Y	1-XXXXXX-Y	2-XXXXXX-Y	3-XXXXXX-Y	4-XXXXXX-Y	5-XXXXXX-Y	6-XXXXXX-Y	7-XXXXXX-Y	8-XXXXXX-Y

PREFIX FOR ACCESSORIES
BASIC PARTNR.
SUFFIX FOR PLATING

PLATING SUFFIX "Y"	DESCRIPTION	-Y =	E
	GOLD OVER NICKEL AS PER PERFORMANCE LEVEL 1 (DIN 41652) SOLDERPART : 2,5µm BRIGHT SnPb.		-1
GOLD OVER NICKEL AS PER PERFORMANCE LEVEL 2 (DIN 41652) SOLDERPART : 2,5µm BRIGHT SnPb.		-2	
-		-	

NOTES :

① GROOVE INDICATES VERSION WITH 4-40 UNC INNER THREAD; WITHOUT GROOVE INDICATES VERSION WITH M3 INNER THREAD.

② CAVITY IDENTIFICATION AT FRONT SIDE ONLY.

③ PARTNUMBER AND DATE CODE.

ITEM NRS./MATERIAL :

① SHELL	: BRIGHT TINPLATED STEEL	C
② HOUSING	: GLASSFILLED POLYESTER, COLOR : BLACK	C
③ CONTACTS	: PHOSPHORBRONZE (PLATING : SEE TABLE ABOVE)	C
④ FEMALE SCREWLOCK	: TINPLATED STEEL (INNER THREAD 4-40 UNC OR M3)	C
⑤ BUSHING	: TINPLATED STEEL (INNER THREAD 4-40 UNC OR M3 OR 3,1 DIA THRU-HOLE)	C
⑥ BRACKET	: TINPLATED STEEL	C
⑦ BOARDLOCK	: TINPLATED PHOSPHORBRONZE	B
⑧ POST ALIGNMENT PLATE	: GLASSFILLED POLYESTER, COLOR : BLACK	B

CUSTOMER DRAWING					FOR REFERENCE ONLY WILL NOT BE UPDATED	
© COPYRIGHT 19- BY AMP-HOLLAND B.V. ALL INTERNATIONAL RIGHTS RESERVED. AMP PRODUCTS MAY BE COVERED BY U.S. AND FOREIGN AND/OR PATENTS PENDING. THIS DRAWING IS UNPUBLISHED RELEASED FOR PUBLICATION, 19-						
AMP					AMP-HOLLAND B.V. 's-Hertogenbosch, The Netherlands.	
NAME					HD-20 SIZE 1	
G EH-0033-99					RIGHT ANGLE RECEPTACLE HEADER; MARK II+	
LTR.	REVISION RECORD	DR.	CHK.	DATE		
DR. : D. KESSLER	CHK. : W. SOOMERS	APP. :			DWG. No. C-106505	
DATE: 14 JAN 99	DATE:	DATE:			REV. LTR. G	SHEET 1 of 1 A2