

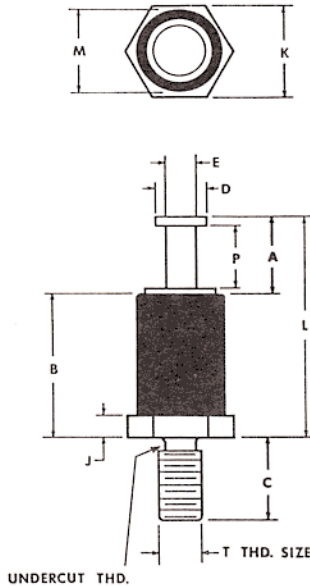

**EMC® Product "STS" Series**



**Plating:**

- 14: 400µ" Tin terminal,  
200µ" Cadmium Chromate base/eyelet
- 4: 30µ" Gold terminal,  
200µ" Cadmium Chromate base/eyelet
- 17: 400µ" Tin terminal,  
200µ" Nickel base/eyelet
- 52: 400µ" Tin terminal,  
200µ" Cadmium Chromate base/eyelet

**Material:**

Terminal: Brass, 1/2-hard, QQ-B-626  
 Base/Eyelet: Brass, 1/2-hard, QQ-B-626  
 Insulator: Diallyl Phthalate, MIL-M-14F Type SDG

**Type 95**

**Type 95 Continued On Next Page →**

Type	EMC Part #	Flash-over Volt.	A	B	C	D	E	J	K	L	M	P	T
95	2610-14-1	12000	.219 (5.56)	.594 (15.09)	.219 (5.56)	.140 (3.56)	.078 (1.98)	.062 (1.57)	.250 (6.35)	.813 (20.65)	.232 (5.89)	.168 (4.27)	4-40
95	2611-14-1	12000	.219 (5.56)	.594 (15.09)	.219 (5.56)	.140 (3.56)	.078 (1.98)	.062 (1.57)	.250 (6.35)	.813 (20.65)	.232 (5.89)	.168 (4.27)	6-32
95	5698-52-6	12000	.219 (5.56)	.594 (15.09)	.219 (5.56)	.140 (3.56)	.078 (1.98)	.062 (1.57)	.250 (6.35)	.813 (20.65)	.232 (5.89)	.147 (3.73)	4-40
95	5699-52-6	12000	.219 (5.56)	.594 (15.09)	.219 (5.56)	.140 (3.56)	.078 (1.98)	.062 (1.57)	.250 (6.35)	.813 (20.65)	.232 (5.89)	.147 (3.73)	6-32
95	2612-14-1	12000	.219 (5.56)	.594 (15.09)	.250 (6.35)	.140 (3.56)	.078 (1.98)	.062 (1.57)	.250 (6.35)	.813 (20.65)	.232 (5.89)	.168 (4.27)	6-32
95	5700-52-6	12000	.219 (5.56)	.594 (15.09)	.250 (6.35)	.140 (3.56)	.078 (1.98)	.062 (1.57)	.250 (6.35)	.813 (20.65)	.232 (5.89)	.147 (3.73)	6-32
95	2613-14-1	12000	.219 (5.56)	.594 (15.09)	.375 (9.53)	.140 (3.56)	.078 (1.98)	.062 (1.57)	.250 (6.35)	.813 (20.65)	.232 (5.89)	.168 (4.27)	6-32
95	5701-52-6	12000	.219 (5.56)	.594 (15.09)	.375 (9.53)	.140 (3.56)	.078 (1.98)	.062 (1.57)	.250 (6.35)	.813 (20.65)	.232 (5.89)	.147 (3.73)	6-32
95	2699-14-1	8200	.156 (3.96)	.390 (9.91)	.125 (3.18)	.072 (1.83)	.050 (1.27)	.046 (1.17)	.156 (3.96)	.547 (13.89)	.146 (3.71)	.121 (3.07)	2-56
95	2700-14-1	8200	.156 (3.96)	.390 (9.91)	.188 (4.78)	.072 (1.83)	.050 (1.27)	.046 (1.17)	.156 (3.96)	.547 (13.89)	.146 (3.71)	.121 (3.07)	2-56
95	2701-14-1	8200	.156 (3.96)	.390 (9.91)	.250 (6.35)	.072 (1.83)	.050 (1.27)	.046 (1.17)	.156 (3.96)	.547 (13.89)	.146 (3.71)	.121 (3.07)	2-56
95	2705-14-1	8200	.219 (5.56)	.390 (9.91)	.125 (3.18)	.072 (1.83)	.050 (1.27)	.046 (1.17)	.156 (3.96)	.609 (15.47)	.146 (3.71)	.185 (4.70)	2-56
95	2706-14-1	8200	.219 (5.56)	.390 (9.91)	.188 (4.78)	.072 (1.83)	.050 (1.27)	.046 (1.17)	.156 (3.96)	.609 (15.47)	.146 (3.71)	.185 (4.70)	2-56
95	2707-14-1	8200	.219 (5.56)	.390 (9.91)	.250 (6.35)	.072 (1.83)	.050 (1.27)	.046 (1.17)	.156 (3.96)	.609 (15.47)	.146 (3.71)	.185 (4.70)	2-56
95	2606-14-1	8000	.219 (5.56)	.375 (9.53)	.219 (5.56)	.140 (3.56)	.078 (1.98)	.062 (1.57)	.250 (6.35)	.594 (15.09)	.232 (5.89)	.168 (4.17)	4-40

inch  
(mm)



**EMC® Product "STS" Series**

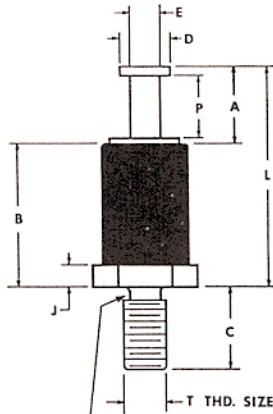
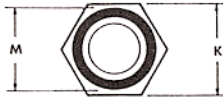

UNDERCUT THD.

**Type 95**

**Plating:**

- 14: 400µ" Tin terminal, 200µ" Cadmium Chromate base/eyelet
- 4: 30µ" Gold terminal, 200µ" Cadmium Chromate base/eyelet
- 17: 400µ" Tin terminal, 200µ" Nickel base/eyelet
- 52: 400µ" Tin terminal, 200µ" Cadmium Chromate base/eyelet

**Material:**

Terminal: Brass, 1/2-hard, QQ-B-626  
 Base/Eyelet: Brass, 1/2-hard, QQ-B-626  
 Insulator: Diallyl Phthalate, MIL-M-14F Type SDG

Type	EMC Part #	Flash-over Volt.	A	B	C	D	E	J	K	L	M	P	T
95	2607-14-1	8000	.219 (5.56)	.375 (9.53)	.219 (5.56)	.140 (3.56)	.078 (1.98)	.062 (1.57)	.250 (6.35)	.594 (15.09)	.232 (5.89)	.168 (4.27)	6-32
95	5694-14-1	8000	.219 (5.56)	.375 (9.53)	.219 (5.56)	.140 (3.56)	.078 (1.98)	.062 (1.57)	.250 (6.35)	.594 (15.09)	.232 (5.89)	.147 (3.73)	4-40
95	2698-14-1	6000	.156 (3.96)	.234 (5.94)	.250 (6.35)	.072 (1.83)	.050 (1.27)	.046 (1.17)	.156 (3.96)	.390 (9.91)	.146 (3.71)	.121 (3.07)	2-56
95	2703-14-1	6000	.219 (5.56)	.234 (5.94)	.188 (4.78)	.072 (1.83)	.050 (1.27)	.046 (1.17)	.156 (3.96)	.453 (11.51)	.146 (3.71)	.185 (4.70)	2-56
95	2704-14-1	6000	.219 (5.56)	.234 (5.94)	.250 (6.35)	.072 (1.83)	.050 (1.27)	.046 (1.17)	.156 (3.96)	.453 (11.51)	.146 (3.71)	.185 (4.70)	2-56
95	2702-14-1	6000	.219 (5.56)	.234 (5.94)	.125 (3.18)	.072 (1.83)	.050 (1.27)	.046 (1.17)	.156 (3.96)	.453 (11.51)	.146 (3.71)	.185 (4.70)	2-56
95	5704-14-1	6000	.156 (3.96)	.234 (5.94)	.250 (6.35)	.072 (1.83)	.048 (1.22)	.046 (1.17)	.156 (3.96)	.391 (9.93)	.146 (3.71)	.116 (2.95)	2-56
95	2697-14-1	6000	.156 (3.96)	.234 (5.94)	.188 (4.78)	.072 (1.83)	.050 (1.27)	.046 (1.17)	.156 (3.96)	.391 (9.93)	.146 (3.71)	.121 (3.07)	2-56
95	5702-14-1	6000	.156 (3.96)	.234 (5.94)	.125 (3.18)	.072 (1.83)	.047 (1.19)	.046 (1.17)	.156 (3.96)	.391 (9.93)	.146 (3.71)	.116 (2.95)	2-56
95	2696-14-1	6000	.156 (3.96)	.234 (5.94)	.125 (3.18)	.072 (1.83)	.050 (1.27)	.046 (1.17)	.156 (3.96)	.391 (9.93)	.146 (3.71)	.121 (3.07)	2-56
95	4187-14-1	5000	.156 (3.96)	.219 (5.56)	.250 (6.35)	.091 (2.31)	.050 (1.27)	.046 (1.17)	.188 (4.78)	.375 (9.53)	.146 (3.71)	.121 (3.07)	3-48
95	4302-14-1	5000	.219 (5.56)	.219 (5.56)	.156 (3.96)	.091 (2.31)	.062 (1.57)	.047 (1.19)	.186 (4.72)	.438 (11.13)	.146 (3.71)	.173 (4.39)	3-48
95	7813-14-1	5000	.219 (5.56)	.219 (5.56)	.093 (2.36)	.091 (2.31)	.062 (1.57)	.047 (1.19)	.186 (4.72)	.438 (11.13)	.146 (3.71)	.173 (4.39)	3-48
95	3371-14-1	4000	.156 (3.96)	.203 (5.16)	.094 (2.39)	.091 (2.31)	.050 (1.27)	.046 (1.17)	.186 (4.72)	.359 (9.12)	.168 (4.27)	.121 (3.07)	3-48 inch (mm)