

Micro Battery

MS Lithium Rechargeable Battery

- ▶ MS421R (Reflowable)
- ▶ MS621R (Reflowable)
- ▶ MS414GE
- ▶ MS412FE
- ▶ MS518SE
- ▶ MS614SE
- ▶ MS621FE
- ▶ MS920SE
- ▶ MS621T (Wide temperature range)
- ▶ MS920T (Wide temperature range)
- ▶ TS Lithium Rechargeable Battery
- ▶ TS621E
- ▶ TS920E
- ▶ ML Lithium Rechargeable Battery
- ▶ ML414H

Chip type Electric Double Layer Capacitor

- ▶ CPH3225A
- ▶ CPX3225A752D
- ▶ CPM3225A

Silver Oxide Battery

- ▶ SEIZAIKEN
- ▶ Cross reference chart
- ▶ SEIZAIKEN's new usage except watches
- ▶ Silver Oxide Battery Expiration Guide
- ▶ For Your Safety

Micro battery's new challenge for medical devices

- ▶ Support
- ▶ Global Network

Contact Us

Sitemap

Micro Battery Products Catalog PDF DOWNLOAD

MS Lithium Rechargeable Battery MS920SE

SPECIFICATIONS

Type	MS920SE
Nominal Voltage(V)	3
Charge Voltage (Standard Charge Voltage)(V)	2.8 to 3.3(3.1)
Nominal Capacity(mAh)	11.0
Internal Impedance(Ω)	35
Standard Discharge Current(mA)	0.050
Maximum Discharge Current (Continuous)(mA)	0.80
Cycle Life (Time)100% D.O.D(Depth of Discharge)	100
Cycle Life (Time)20% D.O.D(Depth of Discharge)	1000
Size Diameter(mm)	9.5
Size Height(mm)	2.1
Weight(g)	0.47

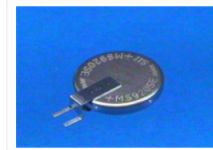

MS920SE FL27E

Terminals

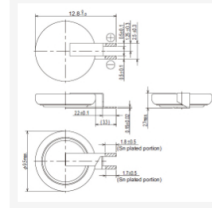

Click to enlarge

MS920SE is not reflowable. Please mount them on PCB by hand soldering.

CHARACTERISTICS

Click to enlarge.

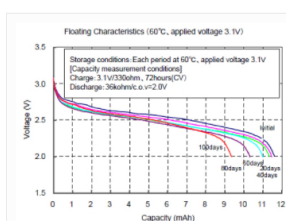
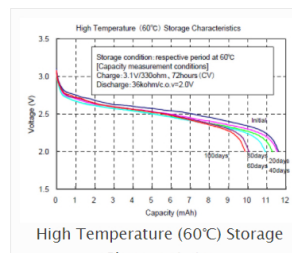
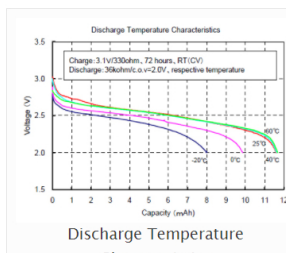
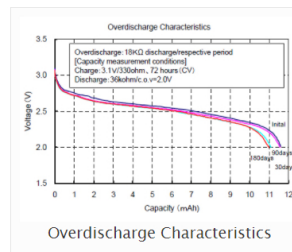
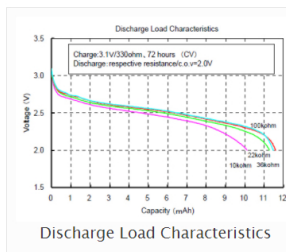
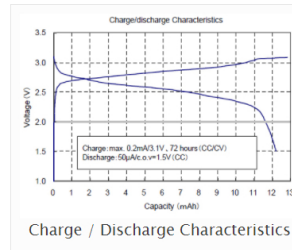
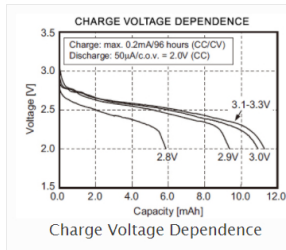

Floating Characteristics (60°C,
applied voltage 3.1V)

Please contact us for more details.

[Inquiry Form](#)

[Micro_Energy_Division](#) | [History](#) | [Factory](#) | [Environmental Activities](#) | [Contact Us](#) | [Sitemap](#) |

[SII HOME](#)

[Terms of Use](#) | [Sitemap](#) | [Privacy Policy](#)

Copyright © Seiko Instruments Inc. 2021, All Rights Reserved.